



Commercial

First Floor Suite
G2, 4 Harris Close
Frome
Somerset
BA11 5JY

Rent £8,000 per annum Plus VAT

A purpose-built first floor office suite, located on the southern fringe of Frome and within a short walk of the town's train station.

Electric Heating
Kitchenette
Disabled WC
1 Allocated Parking Bay
Double Glazing

There is an additional service charge for development maintenance and repairs.

First Floor
Approx. 57.4 sq. metres (618.0 sq. feet)
(excluding Hall)

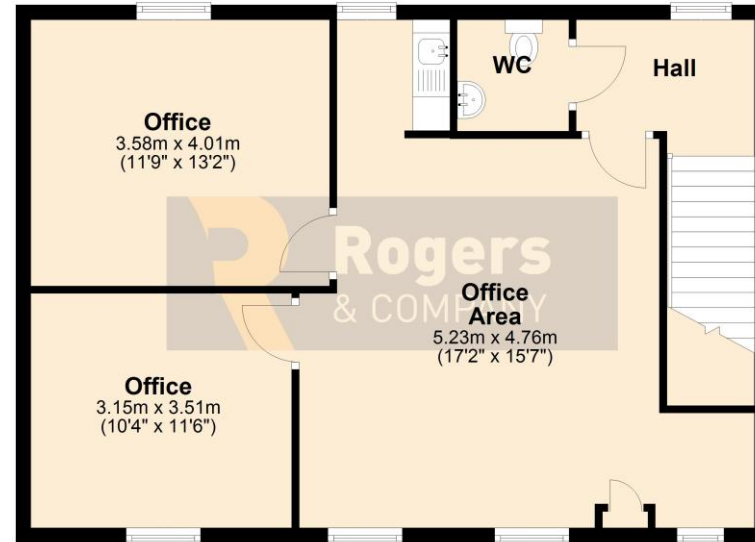

Total area: approx. 57.4 sq. metres (618.0 sq. feet)

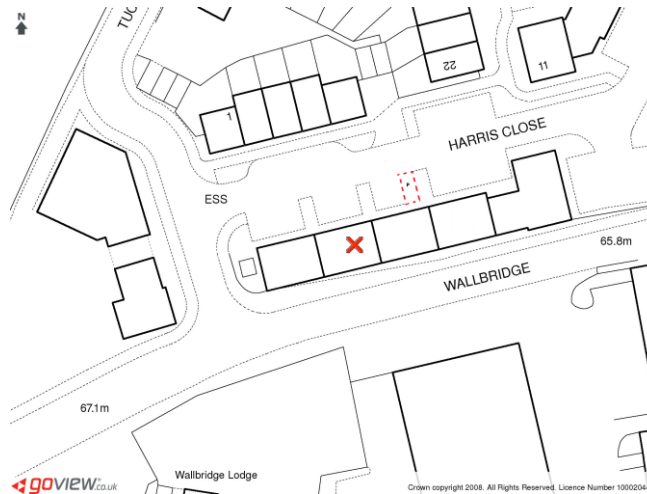

IMPORTANT: we would like to inform prospective purchasers that these sales particulars have been prepared as a general guide only. A detailed survey has not been carried out, nor the services, appliances and fittings tested. Room sizes should not be relied upon for furnishing purposes and are approximate. If floor plans are included, they are for guidance only and illustration purposes only and may not be to scale. If there are any important matters likely to affect your decision to buy, please contact us before viewing the property.

24 Bath Street, Frome, Somerset, BA11 1DJ

T 01373 454 335

E info@rogersandcompany.co.uk
rogersandcompany.co.uk

