



**43 Denmark Street**

, Bedford, MK40 3TG

**£375,000**



## Floor Plan

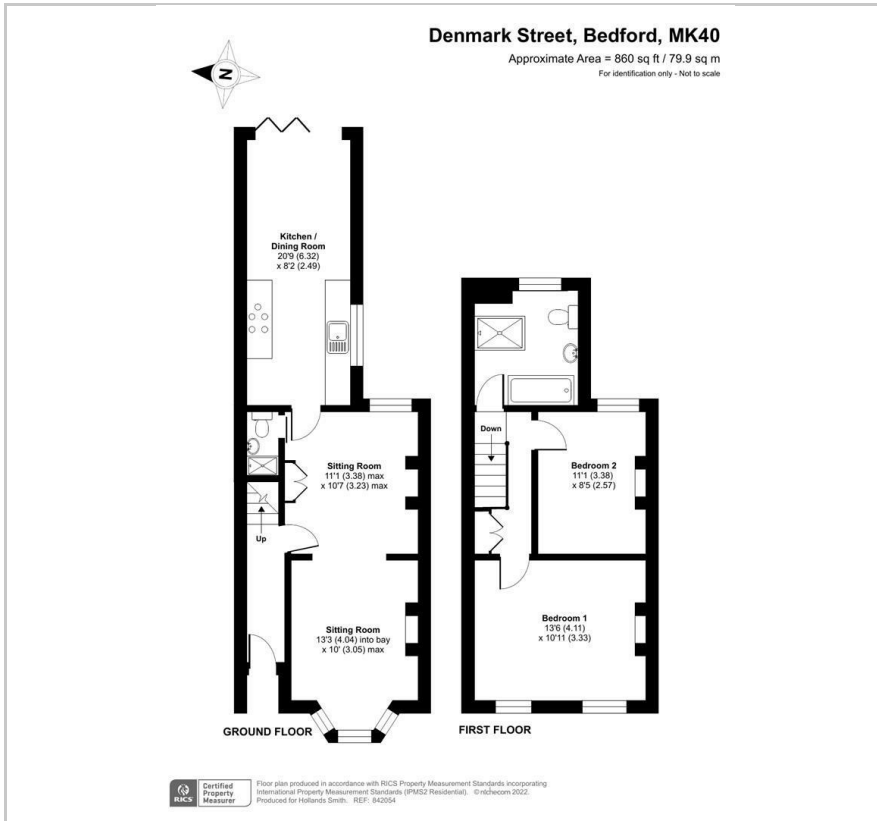

## Area Map



## Energy Efficiency Graph

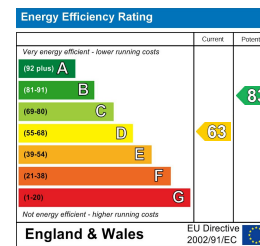

## Viewing

Please contact our Bedford Office on 01234 216612 if you wish to arrange a viewing appointment for this property or require further information.

- Very Well-Presented Terraced ■ Two Double Bedrooms Home
- Spacious First Floor Bathroom ■ Sitting and Dining Rooms
- Kitchen/Breakfast Room with Bi-Fold Doors ■ Ground Floor WC
- No Upward Chain

Offered for sale in very good condition throughout and with the added benefit of having no upward chain, this period terraced home occupies a central position with the 'Castle Quarter' of the town, with a choice of amenities on the doorstep. The accommodation provides both sitting and dining room as well as a spacious kitchen/breakfast rooms with bi-fold doors and some appliances included. There are two double bedrooms and a modern first floor bathroom with free standing bath and separate shower cubicle. There is also a useful ground floor WC, cleverly added underneath the stairs. Features include replacement sash windows (all except one), column radiators from a combination boiler, Oak flooring to most of the ground floor and there is an open fireplace in the front sitting room. Outside, there is a part walled courtyard style garden.

The immediate Castle Road area provides a wide choice of eateries including coffees shops, cafes and pub/restaurants. There is also a range of shops including a butchers, bakery and home-improvement stores. Russell Park is at the end of the road with The Embankment beyond and Bedford town centre is a short walk away and has a wider choice of shops and restaurants as well as fast links into London by rail. EER: D



**163 Castle Road, MK40 3RT**

**Tel: 01234 216612**

**www.hollandsmith.co.uk**