

Apartment 26, Ellerslie Court Upper Park Road, Victoria Park, Manchester, M14 5RH



JP&Brimelow
ESTATE AGENTS

Offers In The Region Of £150,000



VIDEO TOUR AVAILABLE A spacious TWO DOUBLE BEDROOM ground-floor apartment located in the highly sought-after Victoria Park area, just off Denison Road and within easy reach of Wilmslow Road's excellent range of amenities, including shops, restaurants, cafés, and supermarkets. The well-designed accommodation comprises an entrance hallway with ample storage, a generous lounge/dining room, a fitted kitchen, two double bedrooms, with the principal bedroom benefiting from a three-piece en-suite shower room, and a separate three-piece family bathroom. Additional features include electric heating, beautifully maintained communal gardens, an allocated parking space, and a Juliette balcony accessed from the lounge. Ideally positioned close to major hospitals and universities, the property also enjoys excellent transport connections, providing convenient access to Manchester city center and the surrounding South Manchester suburbs. Early internal inspection recommended.





EPC Chart

Energy Efficiency Rating		Current	Potential
Very energy efficient - lower running costs			
(92 plus) A			
(81-91) B			
(69-80) C		75	79
(55-68) D			
(39-54) E			
(21-38) F			
(1-20) G			
Not energy efficient - higher running costs			
England & Wales		EU Directive 2002/91/EC 	



Tenure: **Leasehold** Council Tax Band: **C**

Ground Floor

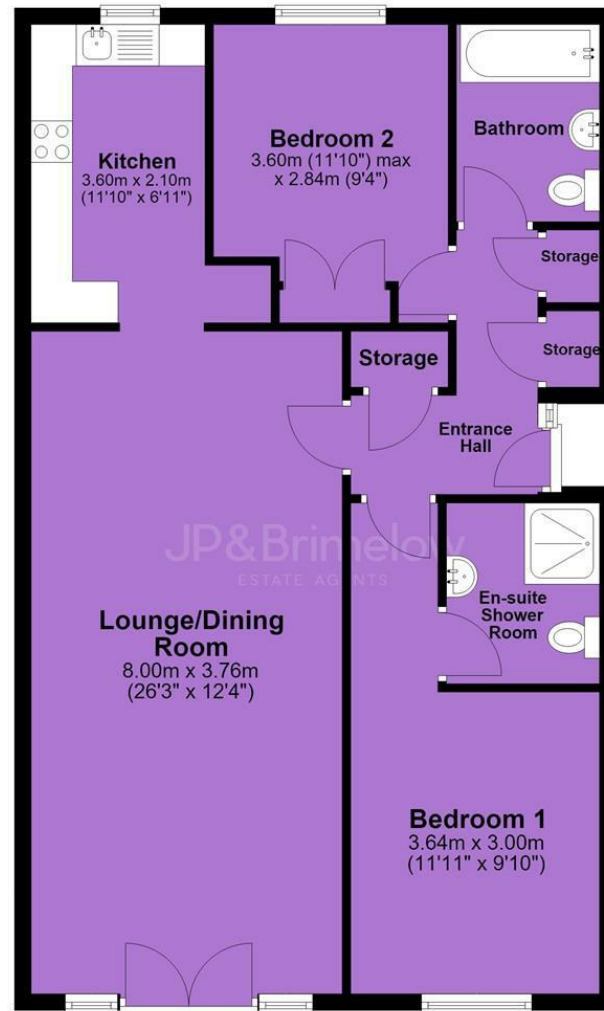

JP & Brimelow Estate Agents Ltd
430 Barlow Moor Road, Manchester, M21 8AD
Tel: 0161 8822233
E: sales@jpbrimelow.co.uk www.jpandbrimelow.co.uk



JP & Brimelow
ESTATE AGENTS

NOTICE: JP & Brimelow Estate Agents Ltd for themselves and for the vendors or lessors of this property whose agents they are give notice that:

- the particulars are set out as a general outline only for the guidance of intending purchasers or lessees, and do not constitute, nor constitute part of, an offer or contract;
- all descriptions, dimensions, references to the condition and necessary permissions for use and occupation, and other details are given in good faith and are believed to be correct but any intending purchasers or tenants should not rely on them as statements or representations of fact but must satisfy themselves by inspection or otherwise as to the correctness of each of them;
- no person in the employment of JP & Brimelow Estate Agents Ltd has any authority to make or give any representation or warranty whatever in relation to this property.

jpanbrimelowstateagents

@jpandbrimelow