

Straightsmouth, SE10

£807 Per week

Perfect for a family, this modern four bedroom house is arranged over three levels. This house has a well proportioned reception room and eat in kitchen, wooden flooring, ample storage, a private garden and underground parking.

A fantastic opportunity to live in the centre of Greenwich, a short walk from the River Thames, The Cutty Sark and Greenwich Market.

Features

- Four Bedrooms
- Two Bathrooms
- Three Storey House
- Private Garden
- First Floor Terrace
- Underground Parking

Straightsmouth, London, SE10

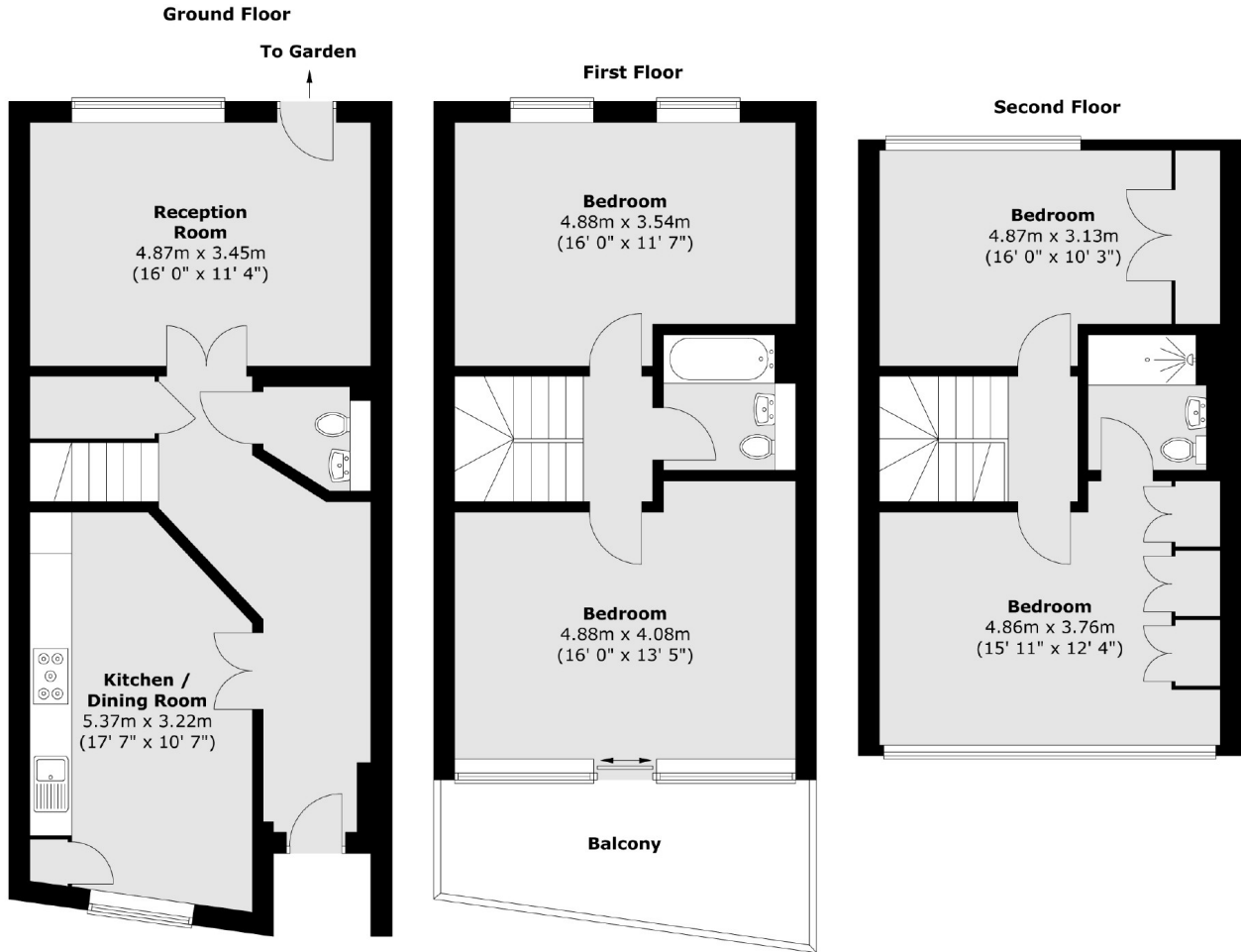

Total area (approx.) : 140.2 sq. m (1509 sq. ft)
Total balcony area (approx.) : 9.6 sq. m (103 sq. ft)