

HENDERSON CONNELLAN

ESTATE AGENTS



Stratfield Way, Kettering, NN15

"It's got to be perfect"

"It's got to be perfect"

And it is, this lovely, detached home occupies a fabulous position, situated on this very sought after development to the South side of town. Offering ultra convenient access to the A14, a wealth of local amenities and Wicksteed Park for lovely walks. Offered to the market with no chain, the exceptionally well presented interior includes an entrance hall, guest cloakroom, bright and airy living room, free Kitchen/dining room and a lovely conservatory overlooking the garden. Upstairs is a principal bathroom and three well-proportioned bedroom, the main bedroom benefiting from an adjoining en suite shower room. The general plot has a private driveway, single garage, lawned fore garden and a lovely, enclosed rear garden. Simply, perfect.

Living Room - 4.17m x 3.61m (13'8" x 11'10")

Dining Room - 2.97m x 2.13m (9'9" x 7'0")

Kitchen - 2.97m x 2.44m (9'9" x 8'0")

Conservatory - 2.79m x 1.96m (9'2" x 6'5")

Bedroom 1 - 4.09m x 3.78m (13'5" x 12'5")

Shower Room - 2.13m x 0.81m (7'0" x 2'8")

Bedroom 2 - 2.64m x 2.21m (8'8" x 7'3")

Bedroom 3 - 2.21m x 1.98m (7'3" x 6'6")

Bathroom - 2.01m x 1.68m (6'7" x 5'6")

- No Onward Chain
- Quiet Cul-de-Sac Location
- Detached Family Home
- Conservatory
- Three Bedrooms
- Offroad Parking for Two Cars
- Gas Central Heating
- UPVC Double Glazing
- COUNCIL TAX: C
- EPC RATING: D

Tenure: Freehold





Ground Floor

Approx. 41.7 sq. metres (449.1 sq. feet)

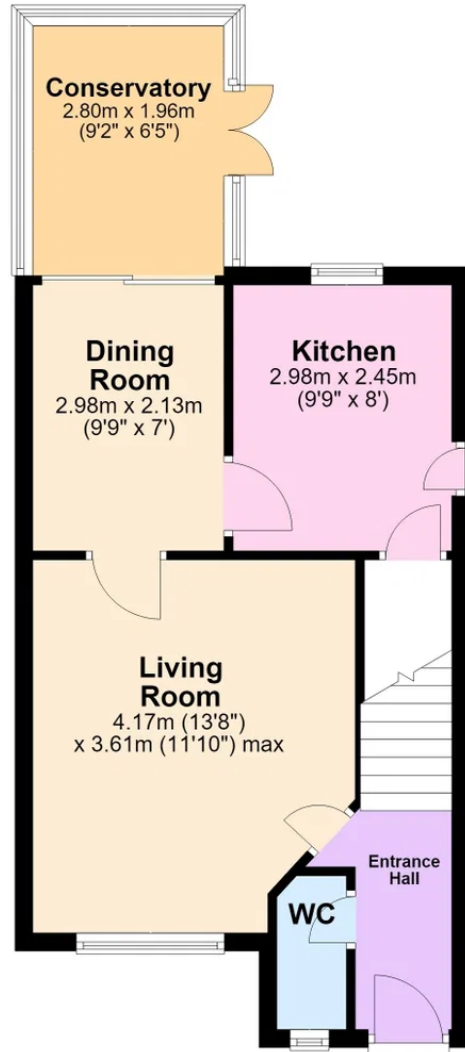

First Floor

Approx. 34.2 sq. metres (368.0 sq. feet)

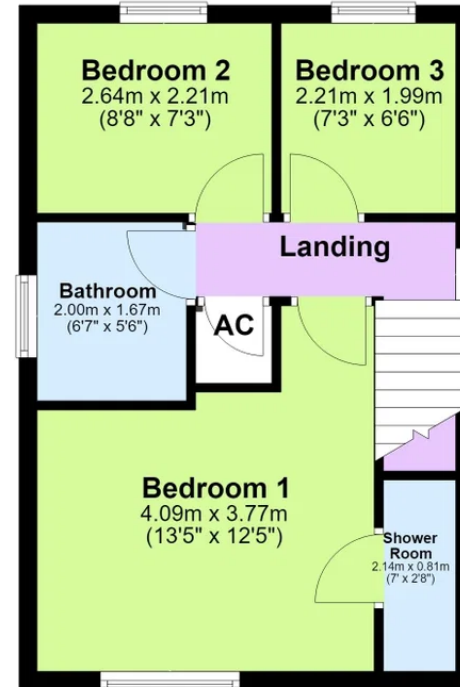

Total area: approx. 75.9 sq. metres (817.1 sq. feet)



Henderson Connellan Kettering office 01536 417888 ketteringsales@hendersonconnellan.co.uk

Disclaimer: These particulars do not form part of any offer or contract and should not be relied upon as statements or representations of fact. Any areas, measurements of distances are approximate. The text, photographs and plans are for guidance only and are not necessarily comprehensive.

