



Grove End Road, NW8

£2,350 Per calendar month

A well-maintained first-floor apartment situated in a popular red-brick block. The property offers ample living space, including a large double bedroom, a good-sized reception area, and a separate fitted kitchen.

Melina Court is located just off of Grove End Road and within walking distance to Lords Cricket Ground and St Johns Wood underground station.

Features

- One Bedroom
- One Bathroom
- Separate Kitchen
- Excellent Location
- First Floor
- Lift Access

Grove End Road, London, NW8

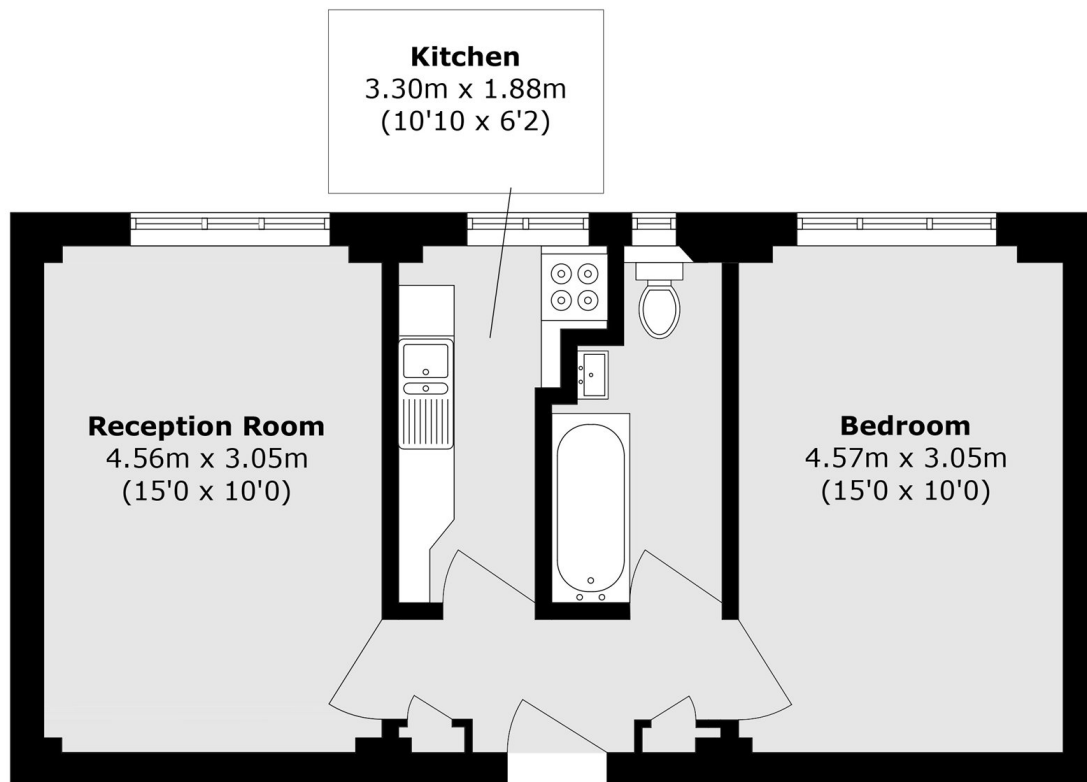

Total area (approx.): 41.9 sq. m (451.0 sq. ft)