



10 Newham Way, Radbrook, Shrewsbury, Shropshire, SY3 6BQ

£70,000

INVESTMENT PROPERTY - Tenant in situ - current rental income £475 pcm. 1 bedroom 1st floor apartment - Situated in a popular residential location with good local amenities and within easy access of the town centre and link roads Accommodation includes Living Room, Kitchen, Bedroom, Shower Room, Allocated Parking.
Great position with open views. Cash Offers Only.



10 Newham Way, Radbrook, Shrewsbury, Shropshire, SY3 6BQ

The mention of any appliances and/or services within these sales particulars does not imply that they are in full and efficient working order.

Accommodation comprises

Entrance door.

Living Room

Double-glazed window with open aspect across to school fields, electric night storage heater, display shelving.

Kitchen

Glazed door, wood-effect laminate flooring. A good range of units with laminated worktops, inset sink unit, integrated electric oven and hob with filter hood above, recessed shelving and cupboard.

Bedroom

Built-in double wardrobe with mirror-fronted sliding doors, built-in airing cupboard, double glazed window, wall wall-mounted electric heater.

Shower Room

Fitted with white 3-piece suite providing tiled shower cubicle, wash basin with cupboard beneath, WC, double-glazed window to the rear, access to roof space.

Lease Details

Lease length: 99 years : 57 years (56 on 1st January) years remaining. Ground Rent: £150 per year Service Charge: None. Maintenance: No regular charge - leaseholder responsibility as per lease terms. Insurance: £323 per year

Council Tax Band A

Tenure: Our client advises us that the property is Leasehold. Should you proceed with the purchase of the property, these details must be verified by your solicitor.

Viewing: To arrange a viewing call in at our office or telephone **01743 248351**

Approx Gross Internal Area
30 sq m / 321 sq ft

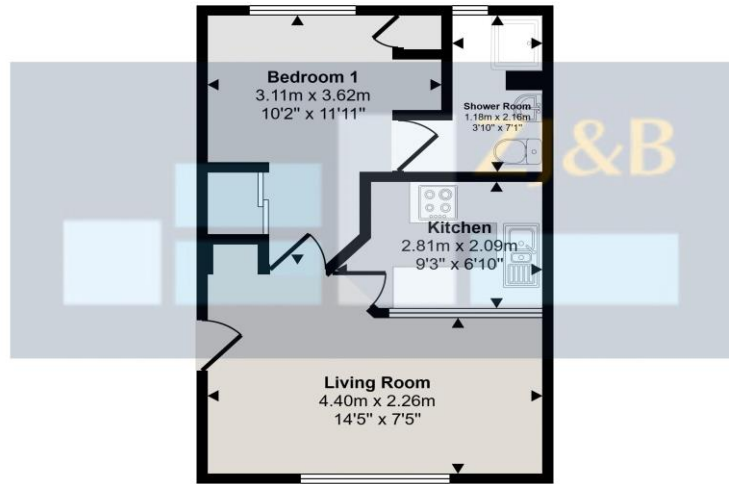

Floorplan

This floorplan is only for illustrative purposes and is not to scale. Measurements of rooms, doors, windows, and any items are approximate and no responsibility is taken for any error, omission or mis-statement. Icons of items such as bathroom suites are representations only and may not look like the real items. Made with Made Snappy 360.

FLOOR PLANS FOR GUIDANCE ONLY

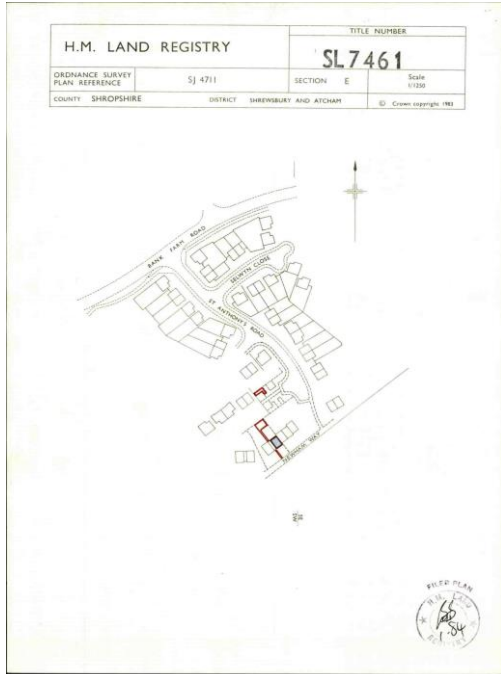

This is a copy of the title plan on 1 SEP 2023 at 16:27:12. This copy does not take account of any application made after that time even if still pending in HM Land Registry when this copy was issued.

This copy is not an 'Official Copy' of the title plan. An official copy of the title plan is admissible in evidence in a court to the same extent as the original. A person is entitled to be indemnified by the registrar if he or she suffers loss by reason of a mistake in an official copy, if you want to obtain an official copy, the HM Land Registry web site explains how to do this.

HM Land Registry endeavours to maintain high quality and scale accuracy of title plan images. The quality and accuracy of any print will depend on your printer, your computer and its print settings. This title plan shows the general position, not the exact line, of the boundaries. It may be subject to distortions in scale. Measurements scaled from this plan may not match measurements between the same points on the ground.

This title is dealt with by HM Land Registry, Telford Office.

© Crown Copyright. Produced by HM Land Registry. Further reproduction in whole or in part is prohibited without the prior written permission of Ordnance Survey. Licence Number: AC09881662.

Find an energy certificate (/)

English | Cymraeg

Energy performance certificate (EPC)

10 Newham Way SHREWSBURY SY3 6BQ	Energy rating D	Valid until: 14 October 2035
		Certificate number: 9380-2445-7500-2695-8531

Property type: Top-floor flat

Total floor area: 29 square metres

Rules on letting this property

Properties can be let if they have an energy rating from A to E.

You can read [guidance for landlords on the regulations and exemptions](https://www.gov.uk/guidance/domestic-private-rented-property-minimum-energy-efficiency-standard-landlord-guidance) (<https://www.gov.uk/guidance/domestic-private-rented-property-minimum-energy-efficiency-standard-landlord-guidance>).

Energy rating and score

This property's energy rating is D. It has the potential to be C.

[See how to improve this property's energy efficiency.](#)



FREE MORTGAGE ADVICE

Whether you are a first time buyer, moving home, buying as an investor or looking to save on your mortgage payments, you will benefit from some **free** no obligation mortgage advice. To arrange an appointment with Stephen Bath of Bee Mortgages, who is based at our office, call us on **01743 248351**

Whole of Market, clear and relevant tailored to your individual needs and circumstances.

Your home may be repossessed if you do not keep up repayments on your mortgage