



Janeston Court Wilbury Crescent, Hove BN3 6FT

welcome to

Janeston Court Wilbury Crescent, Hove

Well-presented two-bedroom flat in the heart of Hove, arranged around a central hallway. Bright front-facing living/dining room, fitted kitchen, two rear double bedrooms and bathroom. Ideally located near Hove town centre, transport links, amenities and seafront.



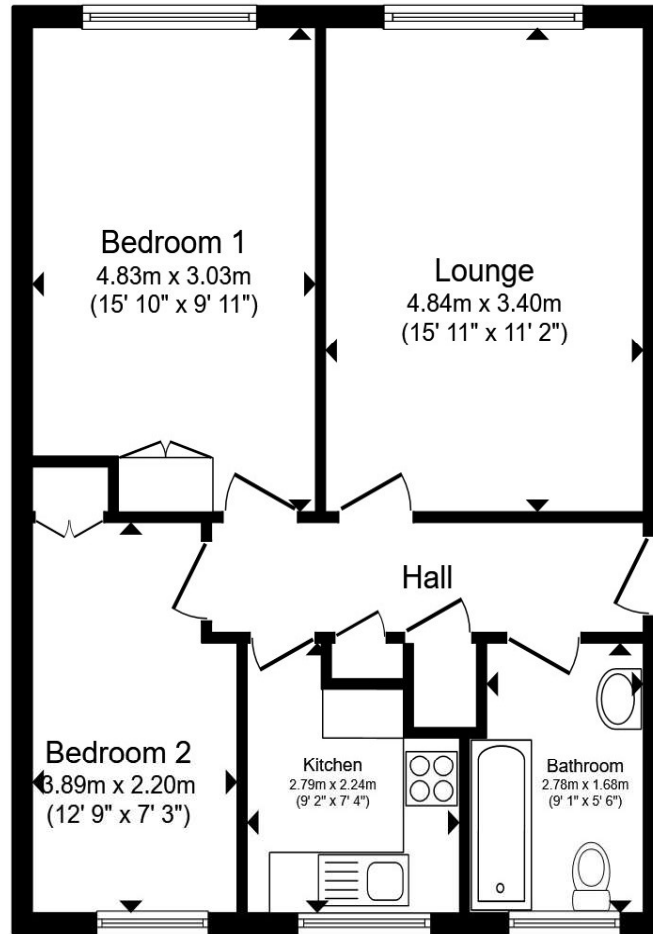

Total floor area 57.6 m² (620 sq.ft.) approx

This floor plan is for illustrative purposes only. It is not drawn to scale. Any measurements, floor areas (including any total floor area), openings and orientation are approximate. No details are guaranteed, they cannot be relied upon for any purpose and they do not form part of any agreement. No liability is taken for any error, omission or misstatement. A party must rely upon its own inspection(s). Powered by www.propertybox.io



welcome to

Janeston Court Wilbury Crescent, Hove

- TOP FLOOR WITH VIEW
- TWO DOUBLE BEDROOMS
- CLOSE TO HOVE SEAFRONT
- BRIGHT LIVING / DINING AREA
- EASY ACCESS TO A27 AND A23

Tenure: Leasehold EPC Rating: D

Council Tax Band: B Service Charge: 1563.00

Ground Rent: 150.00

This is a Leasehold property with details as follows; Term of Lease 102 years from 20 Apr 2017. Should you require further information please contact the branch. Please Note additional fees could be incurred for items such as Leasehold packs.

offers in excess of

£325,000



Please note the marker reflects the postcode not the actual property

view this property online fox-and-sons.co.uk/Property/CRH110156



Property Ref:
CRH110156 - 0011

1. MONEY LAUNDERING REGULATIONS Intending purchasers will be asked to produce identification documentation at a later stage and we would ask for your co-operation in order that there is no delay in agreeing the sale. 2. These particulars do not constitute part or all of an offer or contract. 3. The measurements indicated are supplied for guidance only and as such must be considered incorrect. Potential buyers are advised to recheck measurements before committing to any expense. 4. We have not tested any apparatus, equipment, fixtures or services and it is in the buyers interest to check the working condition of any appliances. 5. Where an EPC, or a Home Report (Scotland only) is held for this property, it is available for inspection at the branch by appointment. If you require a printed version of a Home Report, you will need to pay a reasonable production charge reflecting printing and other costs. 6. We are not able to offer an opinion either written or verbal on the content of these reports and this must be obtained from your legal representative. 7. Whilst we take care in preparing these reports, a buyer should ensure that his/her legal representative confirms as soon as possible all matters relating to title including the extent and boundaries of the property and other important matters before exchange of contracts.

fox & sons



01273 820280



Hove@fox-and-sons.co.uk



161 Church Road, HOVE, East Sussex, BN3 2AD



fox-and-sons.co.uk