



CUTTER LANE, SE10

£550,000

Modern apartment
One double bedroom
East facing balcony
Cable car and river views
On-site pool, gym and cinema
Energy rating: b

@marshandparsons
marshandparsons.co.uk

MARSH &
PARSONS



ABOUT THE PROPERTY

Stunning 18th floor apartment, situated moments away from the O2 centre and North Greenwich tube station. Inside the apartment, you will find a double bedroom, bathroom suite and fitted cabinet. Kitchen breakfast room, and a spacious living room with dining space and direct access to an east facing balcony, overlooking the river Thames. Residents have exclusive access to on-site swimming pool, gym, cinema room, work from home stations, roof terraces and concierge.

Close by are a choice of shopping parks, Westcombe Park mainline station and Greenwich town centre can be accessed via a simple bus route. The apartment is located directly on the river and next to the world famous O2.



STEP INSIDE CUTTER LANE

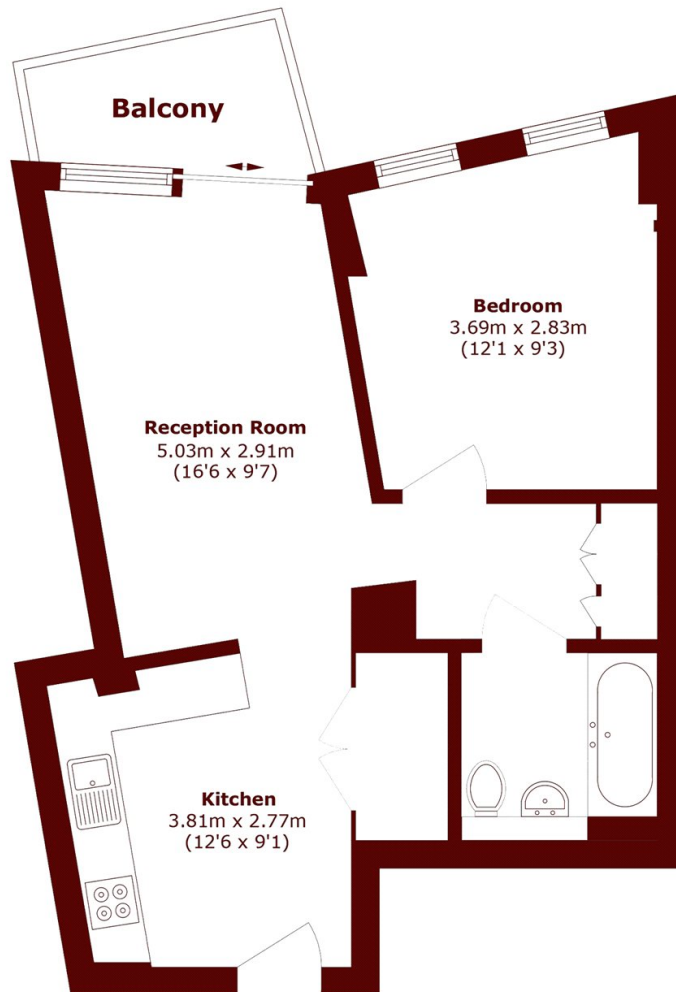

Total area (approx.): 47.4 sq. m (510.2 sq. ft)
Balcony: 4.0 sq. m (43.0 sq. ft)

Greenwich
020 8312 8312

Energy Rating: B We aim to make our particulars both accurate and reliable. However, they are not guaranteed; nor do they form part of an offer or contract. If you require clarification on any points then please contact us, especially if you're traveling some distance to view. Please note that appliances and heating systems have not been tested and therefore no warranties can be given as to their good working order

**MARSH &
PARSONS**