

abbotFox



Sentinel House, Norwich, NR1
£950 PCM

“

We are a team of genuine individuals who hold a deep passion for both property and marketing. Collectively, we bring over 70 years of experience in the property market of Norfolk and Suffolk. Our affection for both counties runs deep, and we are enthusiastic about sharing our passion with you.

Colin McKenzie | **Branch Partner**







THE DETAIL _____

*** Student Rooms/Professional Available ***

AbbotFox presents a rare opportunity to secure a room within this stunning top-floor PENTHOUSE apartment, part of an exclusive collection of just four penthouses in Sentinel House.

This apartment offers FOUR DOUBLE EN-SUITE BEDROOMS, available to let individually, making it the perfect student home. Shared spaces include a spacious sitting room and a modern kitchen/dining area, ideal for social living.

Sentinel House is Norwich's most exciting new residential development, providing outstanding modern living with premium amenities including a concierge service, residents' gym, and a stylish residents' lounge — all in the heart of the city.

Perfectly located within easy walking distance of Norwich's award-winning shopping scene, independent cafes and restaurants, vibrant nightlife, and rich culture. The property also offers excellent transport links, with both the bus and train stations nearby and regular services to the University of East Anglia.







THE HIGHLIGHTS _____

- Top floor penthouse
- Lift access
- Residents' gym
- Available August 2026
- Room to Let
- Residents' lounge
- Concierge service

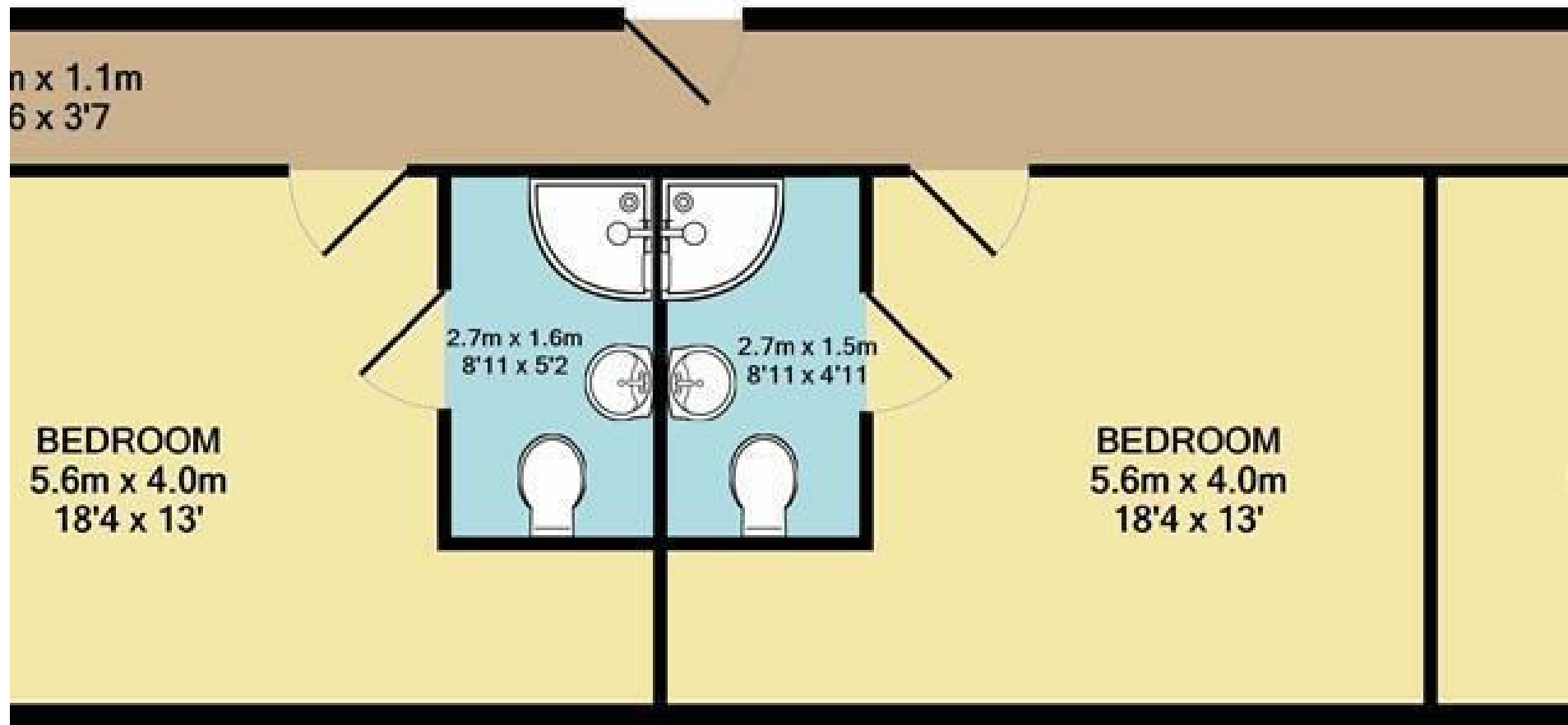

Whilst every attempt has been made to ensure of doors, windows, rooms and any other items omission, or mis-statement. This plan is for ill prospective purchaser. The services, systems a as to their operat Made!

Let's talk

01603 660000

sales@abbotfox.co.uk

@abbotfox

EPC RATING -

Disclaimer – In accordance with the Property Misdescriptions Act, the company abbotFox gives notice that all descriptions, references to condition, necessary permissions for use and other details are given in good faith and believed to be correct, but any purchaser should not rely on them as statements of fact, and must satisfy themselves by inspection or other means, as to their accuracy.