

Gadwall Place, Ivybridge

Guide Price £360,000

3 2 1



- Semi detached house
- Driveway parking for 2 cars
- South facing garden
- High quality flooring throughout
- Highly sought after location
- Master bedroom with stunning elevated views
- Professionally re-landscaped garden
- Kitchen with premium finishes
- Family friendly location
- Nearby local amenities

Approx Gross Internal Area
83 sq m / 898 sq ft

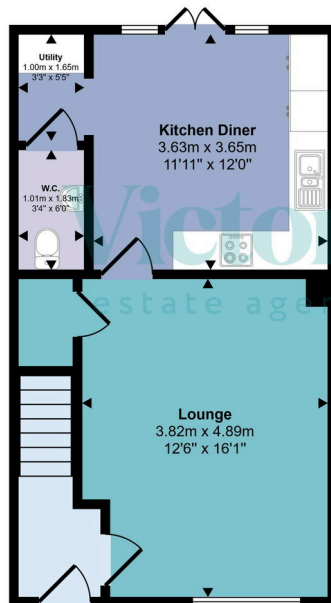

Ground Floor
Approx 42 sq m / 449 sq ft

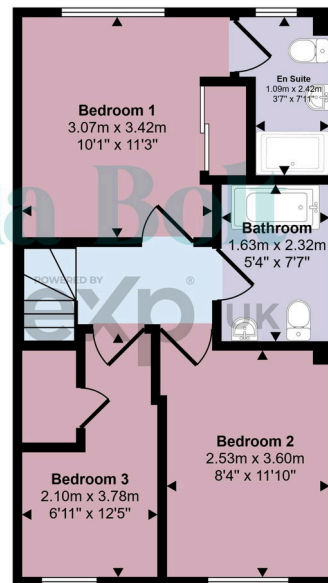

First Floor
Approx 42 sq m / 449 sq ft

This floorplan is only for illustrative purposes and is not to scale. Measurements of rooms, doors, windows, and any items are approximate and no responsibility is taken for any error, omission or mis-statement. Icons of items such as bathroom suites are representations only and may not look like the real items. Made with Made Snappy 360.

A beautifully upgraded 3-bed home in a highly sought after area in Ivybridge. Featuring a premium kitchen, solar panels, and upgraded flooring. Boasting AMAZING VIEWS, a custom built cabin in a beautifully landscaped garden. Ideally located for the railway station, A38, and local parks. MUST BE VIEWED.