



32 Westfield Place

Yeovil, BA21 3DQ

£1,100 PCM

MAYFAIR
TOWN & COUNTRY

PROPERTY DESCRIPTION

Fully refurbished two bedroom terraced property situated in a convenient location. Accommodation comprises: Entrance hallway, living room, kitchen/diner, two double bedrooms, bathroom, large rear garden, off road parking. Please check with Ofcom for mobile/broadband speeds as will depend on provider and package.

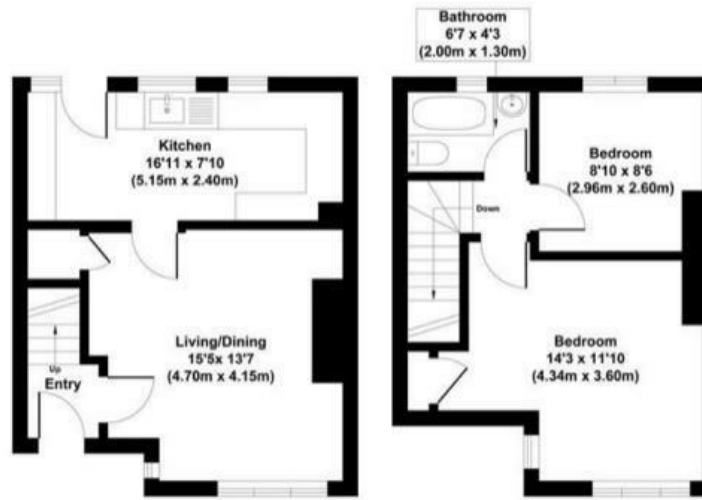

- Fully refurbished
- Two bedrooms
- Large rear garden
- Parking
- Kitchen/diner
- Convenient location

Deposit: £1,269

Furnishing: Unfurnished

Local Authority

South Somerset Council Tax Band: B

Tenure:

EPC Rating: C

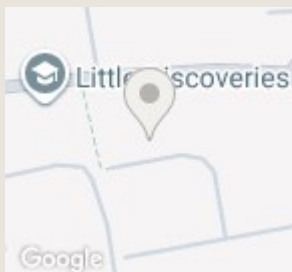
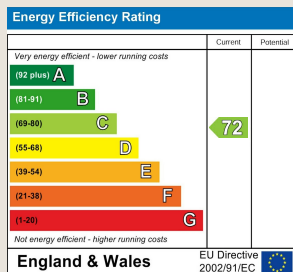

TO ARRANGE A VIEWING OR FOR FURTHER INFORMATION ON THIS PROPERTY PLEASE CONTACT OUR SALES TEAM

01460 74200

crewkerne@mayfairproperties.net



We would like to inform prospective purchasers that these sales particulars have been prepared as a general guide only. If there are any important matters likely to affect your decision to buy, please contact us before viewing the property.

1. Survey - A detailed survey has not been carried out, nor the services, appliances and fittings tested.
2. Floorplans All measurements walls, doors, windows, fittings and appliances, their sizes and locations are shown conventionally and are approximate and cannot be regarded as being representative either by the seller or his agent. Room sizes should not be relied upon for furnishing purposes and are approximate.
3. Mayfair Town & Country may make the following referrals and in exchange receive an introduction fee:
 Star Legal up to £120 inc VAT, Simply Conveyancing up to £240 inc VAT, HD Financial Ltd - introduction fee of up to £240 inc VAT

