



Langland Crescent Stanmore Offers over £600,000

A four bedroom, semi detached house available with Davidson Frost-Wellings.

On the ground floor the house has a double reception room, a separate eat-in kitchen plus an entrance porch and downstairs guest WC. On the first floor there are two double bedrooms each with built-in storage, an additional third bedroom plus a family bathroom. In the loft conversion is a large master suite with storage and an ensuite shower room.

The rear garden is West facing, mostly laid to lawn with a detached single garage.

Langland Crescent is a quiet residential road conveniently located for the shops, restaurants, transport links and amenities at Queensbury Circle.

Harrow Council Tax Band E.

- Four Bedrooms
- Two Bathrooms
- Off Street Parking
- Semi Detached
- West Facing Garden
- Freehold

Viewing

Please contact our Davidson Frost-Wellings Office on 020 8954 8806 if you wish to arrange a viewing appointment for this property or require further information.



Floor Plan

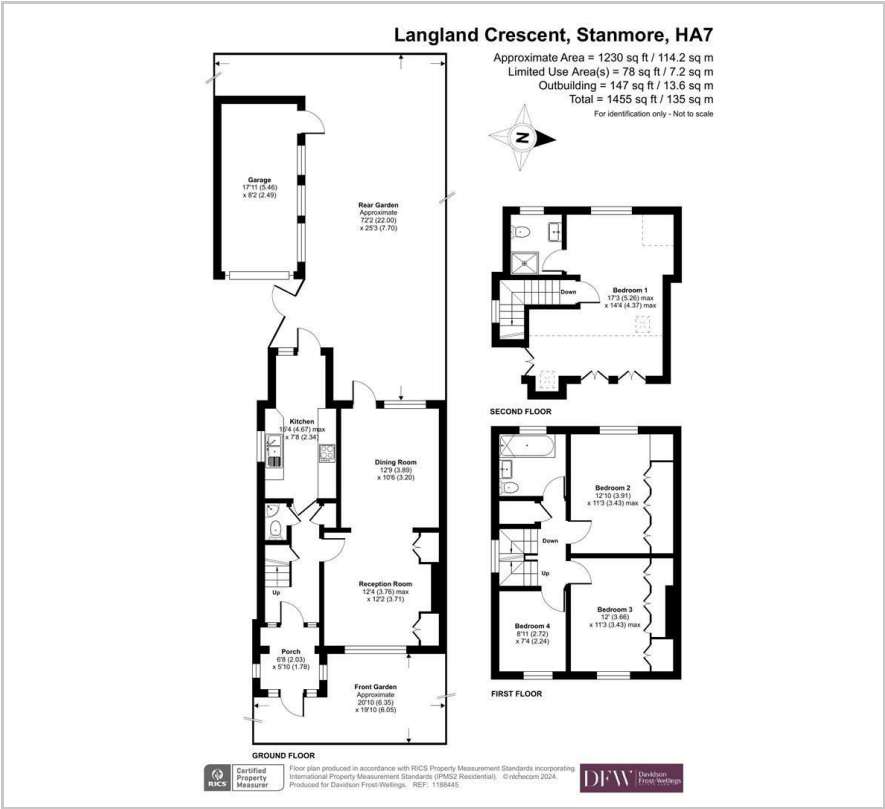

Area Map

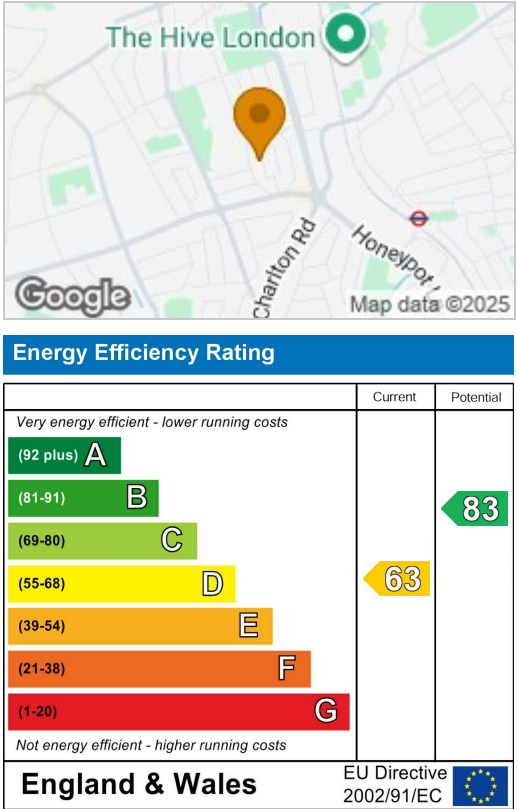

These particulars, whilst believed to be accurate are set out as a general outline only for guidance and do not constitute any part of an offer or contract. Intending purchasers should not rely on them as statements of representation of fact, but must satisfy themselves by inspection or otherwise as to their accuracy. No person in this firms employment has the authority to make or give any representation or warranty in respect of the property.