



## Newington Green Road, N1

### £650,000

A one bedroom flat within a Victorian conversion in the heart of Newington Green. Offering approximately 500sqft of living space, this home has an open-plan kitchen/living room as well as a large private garden.

Enviably located just moments from popular Newington Green with all of its cafés and eateries. For transport, Canonbury overground is under half a mile away and there are numerous bus routes to The City and The West End from Newington Green.

### Features

- Share of Freehold
- One Bedroom
- Large Private Garden
- Chain Free
- Open Plan
- Victorian Conversion

# Newington Green Road, London, N1

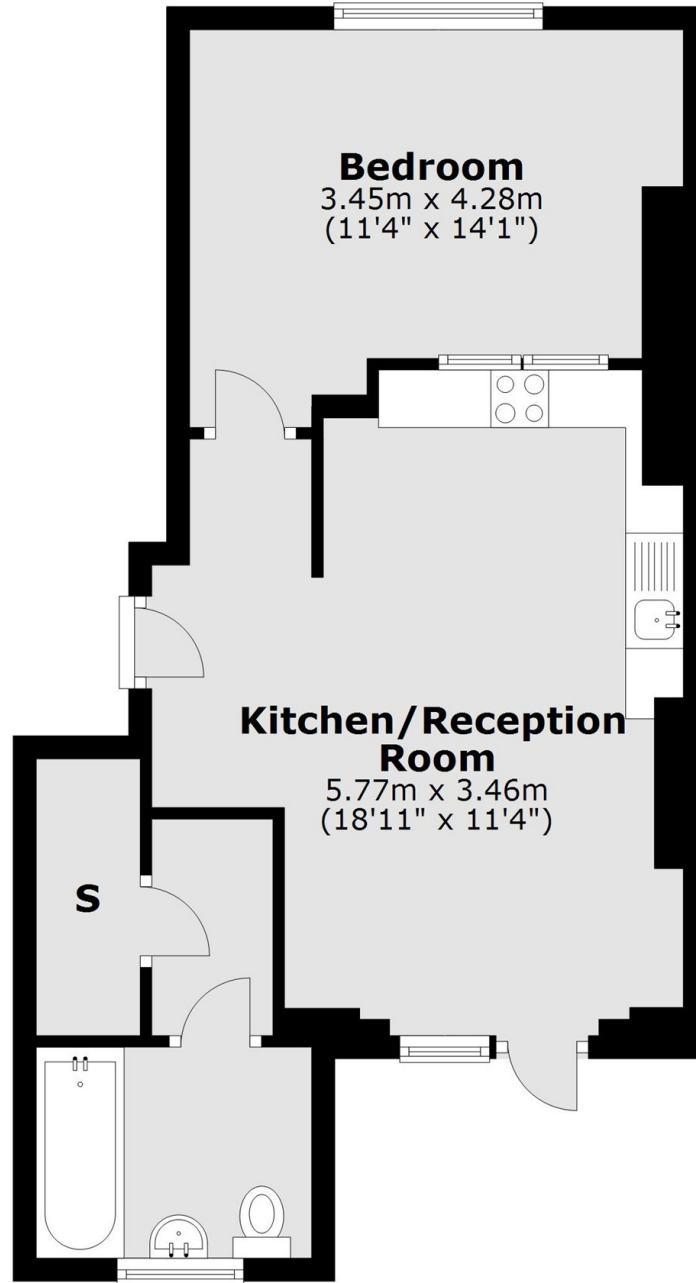

Total area: approx. 45.7 sq. metres (491.8 sq. feet)