



Normandy Crescent
Oxford



Property Description

Upon entering the property, a spacious hallway provides access to the kitchen and the lounge. The lounge benefits from dual-aspect windows to the front and rear, allowing for a bright and well-lit living space. The kitchen offers direct access to the rear garden.

Stairs from the hallway lead to the first floor, which comprises three bedrooms, two of which have built-in cupboards, along with a bathroom and a separate WC.

Externally, there is parking available and a south-west facing rear garden featuring a patio, lawn and an outbuilding.

Normandy Crescent is situated on the borders of Cowley and Headington, offering convenient access Headington's hospitals and Universities. The area is well-connected to local amenities, with supermarkets, shops and other essential services available in nearby Cowley Centre.

Transport links from Hollow Way and Horspath Road provide regular bus services into Oxford city centre via Cowley Centre, as well as routes towards Headington and the John Radcliffe Hospital.

Upon entering the property, a spacious hallway provides access to the kitchen and the lounge. The lounge benefits from dual-aspect windows to the front and rear, allowing for a bright and well-lit living space. The kitchen offers direct access to the rear garden.

Stairs from the hallway lead to the first floor, which comprises three bedrooms, two of which have built-in cupboards, along with a bathroom and a separate WC.

Externally, there is parking available and a south-west facing rear garden featuring a patio, lawn and an outbuilding.

Normandy Crescent is situated on the borders of Cowley and Headington, offering convenient access Headington's hospitals and Universities. The area is well-connected to local amenities, with supermarkets, shops and other essential services available in nearby Cowley Centre.

Transport links from Hollow Way and Horspath Road provide regular bus services into Oxford city centre via Cowley Centre, as well as routes towards Headington and the John Radcliffe Hospital.

Upon entering the property, a spacious hallway provides access to the kitchen and the lounge. The lounge benefits from dual-aspect windows to the front and rear, allowing for a bright and well-lit living space. The kitchen offers direct access to the rear garden.

Stairs from the hallway lead to the first floor, which comprises three bedrooms, two of which have built-in cupboards, along with a bathroom and a separate WC.

Externally, there is parking available and a south-west facing rear garden featuring a patio, lawn and an outbuilding.

Normandy Crescent is situated on the borders of Cowley and Headington,

offering convenient access Headington's hospitals and Universities. The area is well-connected to local amenities, with supermarkets, shops and other essential services available in nearby Cowley Centre.

Transport links from Hollow Way and Horspath Road provide regular bus services into Oxford city centre via Cowley Centre, as well as routes towards Headington and the John Radcliffe Hospital.

Upon entering the property, a spacious hallway provides access to the kitchen and the lounge. The lounge benefits from dual-aspect windows to the front and rear, allowing for a bright and well-lit living space. The kitchen offers direct access to the rear garden.

Stairs from the hallway lead to the first floor, which comprises three bedrooms, two of which have built-in cupboards, along with a bathroom and a separate WC.

Externally, there is parking available and a south-west facing rear garden featuring a patio, lawn and an outbuilding.

Normandy Crescent is situated on the borders of Cowley and Headington, offering convenient access Headington's hospitals and Universities. The area is well-connected to local amenities, with supermarkets, shops and other essential services available in nearby Cowley Centre.

Transport links from Hollow Way and Horspath Road provide regular bus services into Oxford city centre via Cowley Centre, as well as routes towards Headington and the John Radcliffe Hospital.



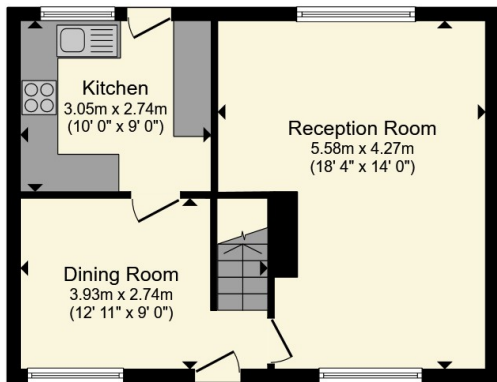

Ground Floor

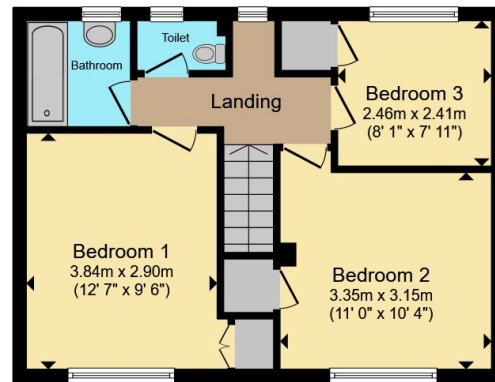

First Floor

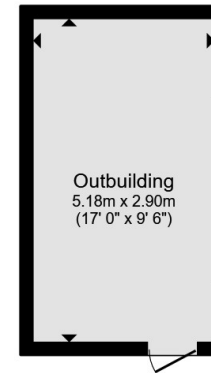

Outbuilding



Total floor area 98.0 m² (1,054 sq.ft.) approx

This floor plan is for illustrative purposes only. It is not drawn to scale. Any measurements, floor areas (including any total floor area), openings and orientation are approximate. No details are guaranteed, they cannot be relied upon for any purpose and they do not form part of any agreement. No liability is taken for any error, omission or misstatement. A party must rely upon its own inspection(s). Powered by www.propertybox.io



To view this property please contact Connells on

T 01865 748 448
E cowley@connells.co.uk

60 Between Towns Road
OXFORD OX4 3LR

EPC Rating: C Council Tax
Band: C

Tenure: Freehold

check out more properties at connells.co.uk



1. MONEY LAUNDERING REGULATIONS Intending purchasers will be asked to produce identification documentation at a later stage and we would ask for your co-operation in order that there will be no delay in agreeing the sale. 2. These particulars do not constitute part or all of an offer or contract. 3. The measurements indicated are supplied for guidance only and as such must be considered incorrect. Potential buyers are advised to recheck measurements before committing to any expense. 4. We have not tested any apparatus, equipment, fixtures, fittings or services and it is in the buyers interest to check the working condition of any appliances.

Connells Residential is registered in England and Wales under company number 1489613, Registered Office is Cumbria House, 16-20 Hockliffe Street, Leighton Buzzard, Bedfordshire, LU7 1GN. VAT Registration Number is 500 2481 05.

See all our properties at www.connells.co.uk | www.rightmove.co.uk | www.zoopla.co.uk

Property Ref: COW310825 - 0002