



## Endsleigh Gardens

Surbiton, KT6 5JL

Guide Price £359,950

A beautifully presented one bedroom first floor period conversion flat, located in a lovely tree lined street moments from the centre of Surbiton. Featuring a very spacious living / dining area with feature fireplace and sash windows. There is a separate kitchen and bathroom. The double bedroom also incorporates fitted wardrobes. Further benefits include off-street parking which is also boasts an EV Charger. The flat comes with a Share of Freehold and is very conveniently located within close walking distance to all local amenities, Surbiton Station, the River Thames and Victoria Park Offered to market chain free.

Material Info: Water / Electricity / Sewerage: Mains. Heating: Gas Mains. Broadband: Fibre (FTTC). Mobile Coverage: Indoor: Good Outdoor: Good

- Beautiful Period First Floor Conversion Flat
- Feature Fireplace
- Bathroom
- Off Street Parking
- Chain Free
- Large Reception
- Separate Kitchen
- Share of Freehold
- EV Charger
- Walking Distance to Town Centre, Mainline Station and Local Parks

# Floor Plan

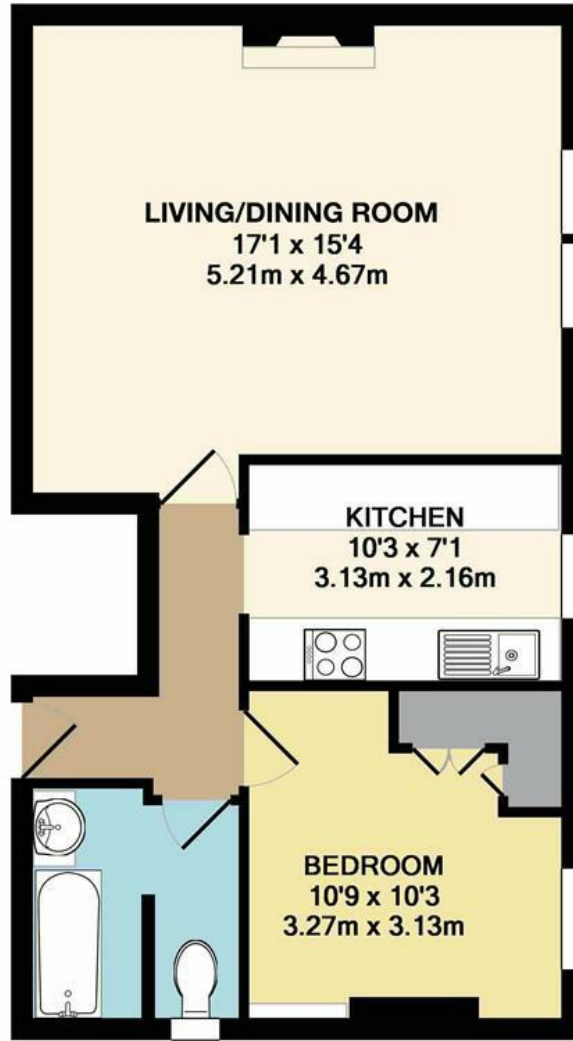

FIRST FLOOR FLAT

ENDSLEIGH GARDENS, SURBITON  
INTERNAL FLOOR AREA (APPROX.) 525 sq ft/ 48.8 sq m

Whilst every attempt has been made to ensure the accuracy of this floor plan, measurement of doors, windows, rooms and any other items are approximate and no responsibility is taken for any error, omission or mis-statement. Made with Metropix © 2018.

## Energy Efficiency Graph

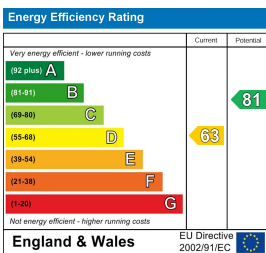

These particulars, whilst believed to be accurate are set out as a general outline only for guidance and do not constitute any part of an offer or contract. Intending purchasers should not rely on them as statements of representation of fact, but must satisfy themselves by inspection or otherwise as to their accuracy. No person in this firm's employment has the authority to make or give any representation or warranty in respect of the property.