



3 Kelvin Close, Hythe, SO45 5LW
£399,950



ANTHONY JAMES
PROPERTIES



3 Kelvin Close

Hythe, Southampton

This three bedroom detached bungalow is offered to the market with no onward chain, providing an ideal opportunity for buyers seeking a straightforward move. The property features an inviting open plan lounge and dining room, perfect for both relaxation and entertaining guests. The side aspect kitchen offers ample storage and workspace. There are three generously sized bedrooms, along with a family bathroom. The bungalow benefits from a sunny rear garden, creating a bright and welcoming atmosphere throughout the home.

Outside, the driveway to the side of the property extends to a single garage, providing ample off road parking as well as additional storage options if desired. The front garden is mainly laid to lawn, complemented by a secure gate that leads to the rear garden. At the back, a patio area extends from the property while the rest of the garden is laid to lawn, offering space for children to play or for gardening enthusiasts. There is access to the front of the property via both sides, enhancing convenience and practicality for every-day living.

Council Tax band: D

Tenure: Freehold



1 Southward House
Dibden Purlieu SO45 4PT



T: 02380 844405

info@anthonyjamesproperties.co.uk



GROUND FLOOR

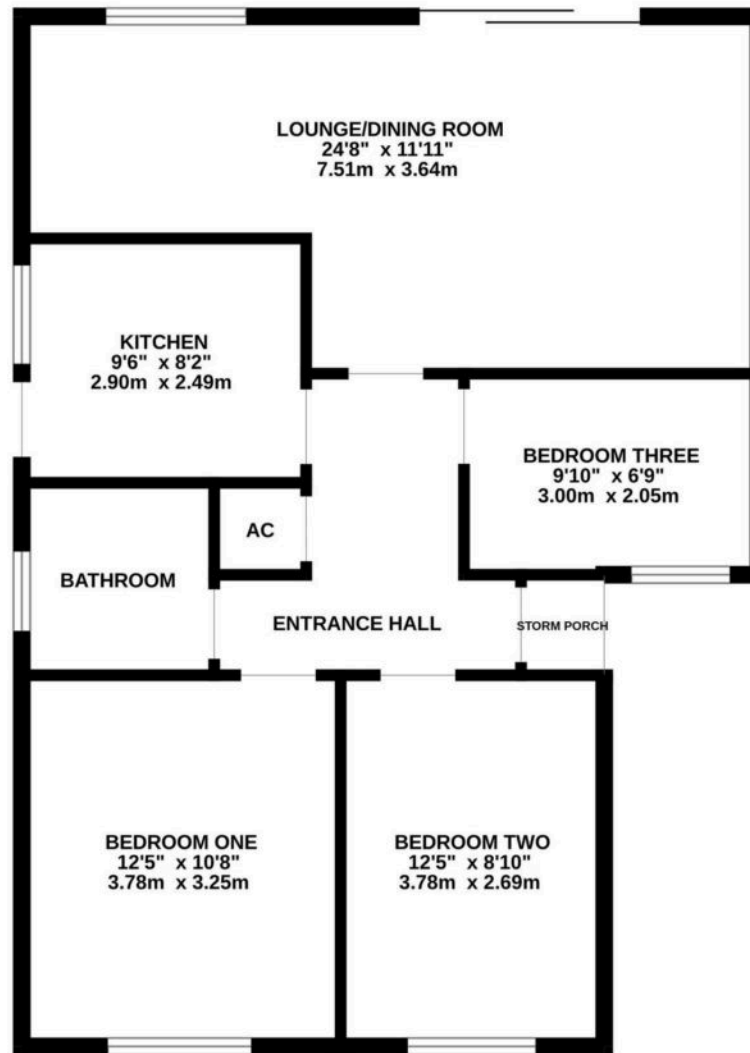

Whilst every attempt has been made to ensure the accuracy of the floorplan contained here, measurements of doors, windows, rooms and any other items are approximate and no responsibility is taken for any error, omission or mis-statement. This plan is for illustrative purposes only and should be used as such by any prospective purchaser. The services, systems and appliances shown have not been tested and no guarantee as to their operability or efficiency can be given.
Made with Metropix ©2026