



99 Elmbridge Road, Gloucester, GL2 0PG

Asking Price £170,000

A two-bedroom ground floor maisonette offering comfortable and convenient living, complete with its own private garden, garage, and off-street parking. The property benefits from gas central heating and is offered chain free, making it an ideal choice for first-time buyers, downsizers, or investors alike.

Situated in a popular and well-connected area, the maisonette is conveniently located on a regular bus route, providing easy access to local amenities and transport links. Early viewing is highly recommended to appreciate the space, location, and potential on offer.

- Two Bedroom Maisonette
 - Ground Floor
- Own Private Garden
 - Parking
 - Chain Free
- Gas Central Heating

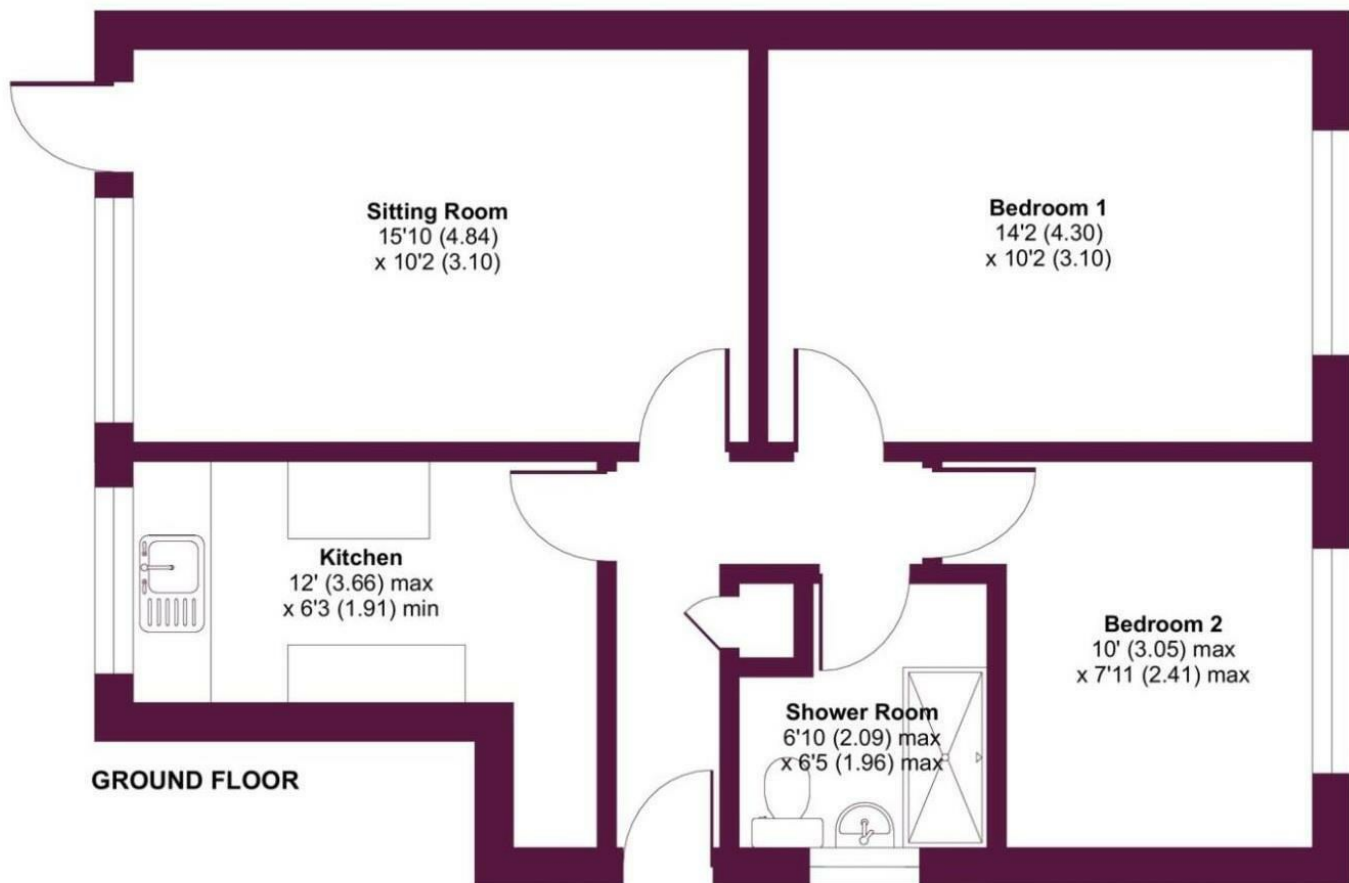

Energy Efficiency Rating	
Current	Potential
Very energy efficient - lower running costs	
(92 plus) A	
(81-91) B	
(69-80) C	
(55-68) D	
(39-54) E	
(21-38) F	
(1-20) G	
Not energy efficient - higher running costs	
75	77
England & Wales	
EU Directive 2002/91/EC	

Environmental Impact (CO ₂) Rating	
Current	Potential
Very environmentally friendly - lower CO ₂ emissions	
(92 plus) A	
(81-91) B	
(69-80) C	
(55-68) D	
(39-54) E	
(21-38) F	
(1-20) G	
Not environmentally friendly - higher CO ₂ emissions	
England & Wales	
EU Directive 2002/91/EC	



These particulars, whilst believed to be accurate are set out as a general outline only for guidance and do not constitute any part of an offer or contract. Intending purchasers should not rely on them as statements of representation of fact, but must satisfy themselves by inspection or otherwise as to their accuracy. No person in this firms employment has the authority to make or give any representation or warranty in respect of the property.