



30 Chestnut House

CW11 1FU

Asking Price £170,000



2



1



1



C



STEPHENSON BROWNE

Welcome to Chestnut House, located at Brook Court in the heart of Sandbach town centre. Presenting a delightful opportunity for those aged 55 and over seeking a comfortable and convenient lifestyle. This spacious ground floor flat is designed with retirement living in mind and is offered for sale with no onward chain, making it an ideal choice for a smooth transition.

The property boasts a large living room, providing ample space for relaxation and entertaining. A multi-purpose storage room or study enhances the functionality of the flat, allowing for personalisation to fit your lifestyle.

The flat features two well-appointed bedrooms and a modern bathroom, ensuring comfort and convenience. Parking is available, adding to the ease of living in this well-maintained development. Residents can also enjoy communal facilities, including a laundry room, visitor parking, and beautifully kept gardens, perfect for leisurely strolls or socialising with neighbours.

Situated within walking distance to local shops, Ashfields Primary Care Centre, and nearby bus routes, this property offers the perfect blend of tranquillity and accessibility. Brook Court is not just a home; it is a community designed for those who wish to enjoy their golden years in a vibrant and supportive environment. Do not miss the chance to make this charming apartment your new residence.



Communal Areas

Security door with intercom. Communal laundry facilities, communal gardens and parking. Visitor parking availability.

Entrance Hall

With airing cupboard.

Living Room

16'9" x 10'0"

Kitchen

9'3" x 8'7"

With whitegoods appliances included.

Store Room / Study

6'7" x 5'3"

Bedroom One

13'5" x 6'7"

Bedroom Two

15'9" x 9'1"

Bathroom

7'6" x 6'7"

General Notes

Any prospective purchaser must be 55 years of age or over. There is a monthly service charge which covers the building's insurance, maintenance of the external building and communal areas, and the Care Line.

AML Disclosure

Agents are required by law to conduct Anti-Money Laundering checks on all those buying a property. Stephenson Browne charge £49.99 plus VAT for an AML check per purchase transaction. This is a non-refundable fee. The charges cover the cost of obtaining relevant data, any manual checks that are required, and ongoing monitoring. This fee is payable in advance prior to the issuing of a memorandum of sale on the property you are seeking to buy.



- No Onward Chain
- Ground Floor
- Two Bedrooms / One Reception Room
- Storage Room / Study
- Town Centre Location
- Spacious Apartment
- Communal Facilities
- Well-Presented & Cared For
- Over 55s Purpose Built Development
- Walking Distance to Shops, Ashfields Primary Care Centre, & Nearby Bus Routes



Floor Plan

GROUND FLOOR

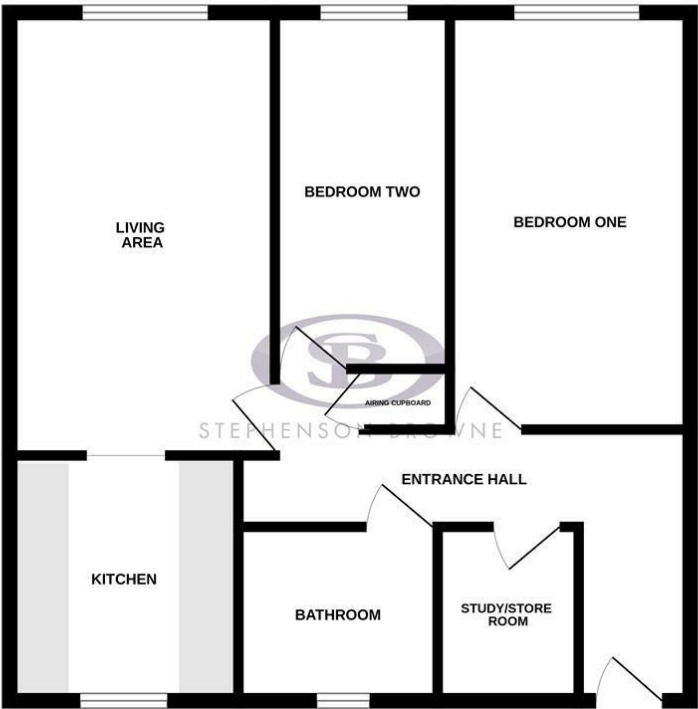

Whilst every attempt has been made to ensure the accuracy of the floorplan contained here, measurements of doors, windows, rooms and any other items are approximate and no responsibility is taken for any error, omission or mis-statement. This plan is for illustrative purposes only and should be used as such by any prospective purchaser. The services, systems and appliances shown have not been tested and no guarantee as to their operability or efficiency can be given.
Made with Metropix ©2025

Viewing

Please contact our Sandbach office if you wish to arrange a viewing appointment or require further information.

NOTICE: Stephenson Browne for themselves and for the vendors or lessors of this property whose agents they are give note that: (1) the particulars are set out as a general guideline only for the guidance of intending purchasers or lessees. and do not constitute, nor constitute part of, an offer or contract; (2) all descriptions, dimensions, references to condition and necessary permissions for use and occupation, and other details are given in good faith and are believed to be correct but any intending purchasers or tenants should not rely on them as statements or representations of fact but must satisfy themselves by inspection or otherwise as to be the correctness of each theme; (3) no person in the employment of Stephenson Browne has any authority to make representation or warranty in relation to this property; (4) fixtures and fittings are subject to a formal list supplied by the vendors solicitor. Referring to: Move with Us Ltd Average fee: £123.64

Area Map

