



Orchard Meadow Walk, Birmingham





### Property Description

Situated on a quiet residential walk within the established Castle Vale area, this three-bedroom mid-terrace property offers well-balanced accommodation arranged over two floors, making it a practical choice for first-time buyers, families, or investors.

The ground floor comprises a front-facing lounge providing a comfortable living space, along with a rear kitchen/breakfast room offering room for dining and everyday use, with access out to the rear garden. The layout is straightforward and functional, suited to modern living.

To the first floor are three bedrooms and a family bathroom, all accessed from the central landing. The accommodation offers flexibility for family occupation, home working, or rental use.

Externally, the property benefits from front and rear gardens, with the rear garden providing an enclosed outdoor space. The location is well placed for local schools, amenities, and transport links, offering convenient access to Birmingham city centre and surrounding areas.

### Lounge

14' 9" x 10' 9" ( 4.50m x 3.28m )  
Front-facing reception room with window to the front elevation, providing space for seating and living furniture.

### Kitchen

16' 9" x 12' 9" ( 5.11m x 3.89m )  
Rear-positioned kitchen/breakfast room fitted with a range of wall and base units, work surfaces, and space for appliances and dining furniture. Door providing access to the rear garden.

### Bedroom One

14' 9" x 9' 8" ( 4.50m x 2.95m )  
Double bedroom positioned to the rear of the property with space for wardrobes and additional bedroom furniture.

### Bedroom Two

10' 11" x 10' 7" ( 3.33m x 3.23m )  
Bedroom positioned to the front of the property, suitable for use as a bedroom or home office.

### Bedroom Three

10' 3" x 6' 11" ( 3.12m x 2.11m )  
Single bedroom positioned to the rear, suitable as a child's room, study, or dressing room.

### Bathroom

Family bathroom fitted with a panelled bath, wash hand basin, and WC.







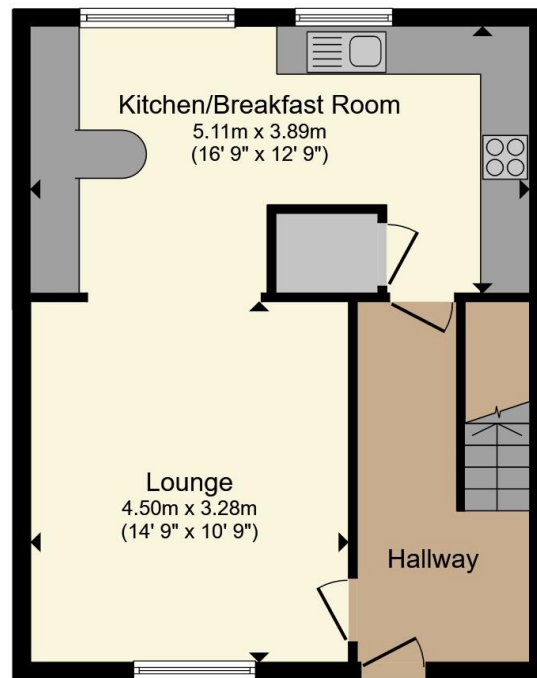

**Ground Floor**

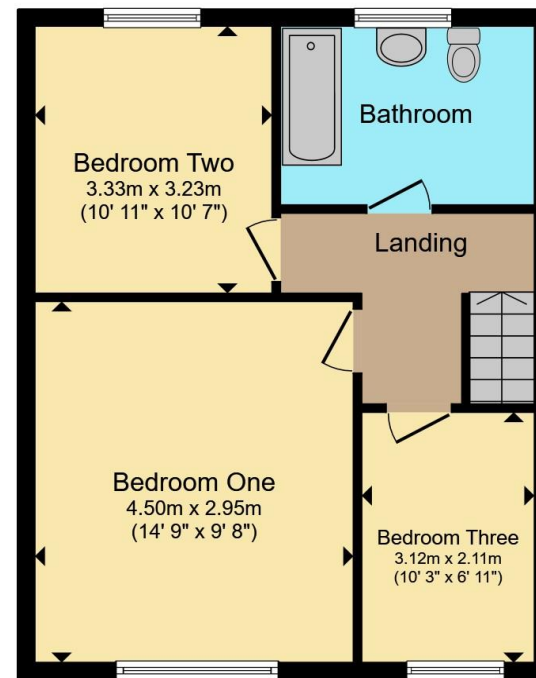

**First Floor**

Total floor area 96.7 m<sup>2</sup> (1,041 sq.ft.) approx

This floor plan is for illustrative purposes only. It is not drawn to scale. Any measurements, floor areas (including any total floor area), openings and orientation are approximate. No details are guaranteed, they cannot be relied upon for any purpose and they do not form part of any agreement. No liability is taken for any error, omission or misstatement. A party must rely upon its own inspection(s). Powered by [www.propertybox.io](http://www.propertybox.io)



To view this property please contact Burchell Edwards on

**T 0121 373 6320**  
**E [erdington@burchelledwards.co.uk](mailto:erdington@burchelledwards.co.uk)**

Unit 3 Queens Court, Gravelly Hill Erdington  
BIRMINGHAM B23 6BJ

EPC Rating: D Council Tax  
Band: A

Tenure: Freehold

**view this property online [burchelledwards.co.uk/Property/ERD207723](http://burchelledwards.co.uk/Property/ERD207723)**



1. MONEY LAUNDERING REGULATIONS Intending purchasers will be asked to produce identification documentation at a later stage and we would ask for your co-operation in order that there will be no delay in agreeing the sale. 2. These particulars do not constitute part or all of an offer or contract. 3. The measurements indicated are supplied for guidance only and as such must be considered incorrect. Potential buyers are advised to recheck measurements before committing to any expense. 4. We have not tested any apparatus, equipment, fixtures, fittings or services and it is in the buyers interest to check the working condition of any appliances.

Burchell Edwards is a trading name of Connells Residential which is registered in England and Wales under company number 1489613, Registered Office is Cumbria House, 16-20 Hockliffe Street, Leighton Buzzard, Bedfordshire, LU7 1GN. VAT Registration Number is 500 2481 05.

**See all our properties at [www.burchelledwards.co.uk](http://www.burchelledwards.co.uk) | [www.rightmove.co.uk](http://www.rightmove.co.uk) | [www.zoopla.co.uk](http://www.zoopla.co.uk)**

Property Ref: ERD207723 - 0002