



Parklands Gardens, Little Sutton Ellesmere Port CH66 3QP

welcome to

Parklands Gardens, Little Sutton Ellesmere Port

Jones & Chapman are excited to welcome to the market this two-bedroom, non-standard construction, semi-detached home, offered to the market with no onward chain, and positioned within a quiet cul-de-sac in a popular residential area of Little Sutton. Call us today to arrange your viewing!



Jones & Chapman are excited to welcome to the market this two-bedroom, non-standard construction, semi-detached home, offered to the market with no onward chain, and positioned within a quiet cul-de-sac in a popular residential area of Little Sutton. Parklands Gardens is conveniently located close to local shops in Little Sutton Village, transport links such as Little Sutton train station offering easy access into Liverpool and Chester, and everyday amenities. The property lies within the catchment area for well-regarded primary and secondary schools making it a great choice for growing families.

The lounge/diner features laminate flooring, a double panel radiator and French doors leading to the rear garden. The kitchen has a range of free-standing appliances, a stainless-steel sink and drainer, wine cooler and a wooden door to the side.

To the first floor, the landing gives access to two bedrooms, the master benefiting from fitted wardrobes and over bed storage, a double panel radiator and fitted carpet. The second bedroom has a single panel radiator and fitted carpet. The family bathroom comprises a panel bath with overhead Triton shower and shower screen, a pedestal wash hand basin and WC.

Externally, the property benefits from a corner plot with a private side and rear garden, while to the front there are two driveways offering off-road parking.

This property would be perfect for first time buyers, and an early viewing is advised.

Furniture negotiable.

Lounge/Diner

19' 11" x 10' 1" (6.07m x 3.07m)

Kitchen

10' 8" x 7' 9" (3.25m x 2.36m)

Landing

Bedroom One

16' 4" x 8' 10" (4.98m x 2.69m)

Bedroom Two

11' 1" x 10' 1" (3.38m x 3.07m)

Bathroom

6' 3" x 6' 2" (1.91m x 1.88m)

Front Garden

Rear Garden



view this property online jonesandchapman.co.uk/Property/LSU108786



welcome to

Parklands Gardens, Little Sutton Ellesmere Port

- Semi-Detached House
- Two Bedrooms & Bathroom
- Lounge & Kitchen
- Off Road Parking & Corner Plot
- Cu-De-Sac Location

Tenure: Freehold EPC Rating: Awaited
Council Tax Band: A

offers in excess of
£150,000

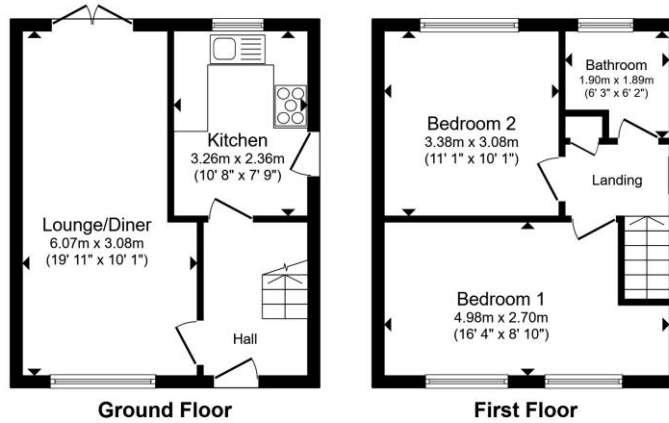

Total floor area 61.0 m² (656 sq.ft.) approx.
This floor plan is for illustrative purposes only. It is not drawn to scale. Any measurements, floor areas (including any total floor area), openings and orientation are approximate. No details are guaranteed, they cannot be relied upon for any purpose and they do not form part of any agreement. No liability is taken for any error, omission or misstatement. A party must rely upon its own inspection(s). Powered by www.propertybox.io

jones & chapman



Please note the marker reflects the postcode not the actual property

view this property online [jonesandchapman.co.uk/Property/LSU108786](https://www.jonesandchapman.co.uk/Property/LSU108786)



Property Ref:
LSU108786 - 0004

1. MONEY LAUNDERING REGULATIONS Intending purchasers will be asked to produce identification documentation at a later stage and we would ask for your co-operation in order that there is no delay in agreeing the sale. 2. These particulars do not constitute part or all of an offer or contract. 3. The measurements indicated are supplied for guidance only and as such must be considered incorrect. Potential buyers are advised to recheck measurements before committing to any expense. 4. We have not tested any apparatus, equipment, fixtures or services and it is in the buyers interest to check the working condition of any appliances. 5. Where an EPC, or a Home Report (Scotland only) is held for this property, it is available for inspection at the branch by appointment. If you require a printed version of a Home Report, you will need to pay a reasonable production charge reflecting printing and other costs. 6. We are not able to offer an opinion either written or verbal on the content of these reports and this must be obtained from your legal representative. 7. Whilst we take care in preparing these reports, a buyer should ensure that his/her legal representative confirms as soon as possible all matters relating to title including the extent and boundaries of the property and other important matters before exchange of contracts.

Jones & Chapman is a trading name of Sequence (UK) Limited which is registered in England and Wales under company number 4268443, Registered Office is Cumbria House, 16-20 Hockliffe Street, Leighton Buzzard, Bedfordshire, LU7 1GN. VAT Registration Number is 500 2481 05.

jones & chapman



0151 339 4878



LittleSutton@jonesandchapman.co.uk



349 Chester Road, Little Sutton, LITTLE SUTTON, Cheshire, CH66 3RG



[jonesandchapman.co.uk](https://www.jonesandchapman.co.uk)