

## Pople Street, Wymondham, NR18 0PS

Offers Over £200,000

 2  1  1



This charming two-bedroom period cottage, nestled in a conservation area, offers an ideal first-time buyer opportunity within walking distance of Wymondham town centre. Step inside to discover a bright lounge, complete with a cosy fireplace, perfect for relaxing evenings. This leads seamlessly into a well-appointed kitchen, providing direct access to a private courtyard garden – your own secluded outdoor space for al fresco dining or quiet contemplation. Upstairs, you'll find two inviting bedrooms, including a generously sized master, offering comfortable retreats. These are thoughtfully served by a modern shower room, ensuring convenience and style.

**Tenure: Freehold   EPC: C   Council Tax: B**

## Key Features

- Charming two-bedroom period cottage
- Two bedrooms, including a generously sized master
- Private 16ft x 9ft courtyard garden
- Close to Wymondham Railway Station and regular local bus routes
- No onward chain
- Within walking distance of Wymondham town centre
- Characterful property
- Nestled in a Conservation area
- Near local amenities and schools
- See our full online listing for further details including flood risk, broadband speed and other material information.

GROUND FLOOR

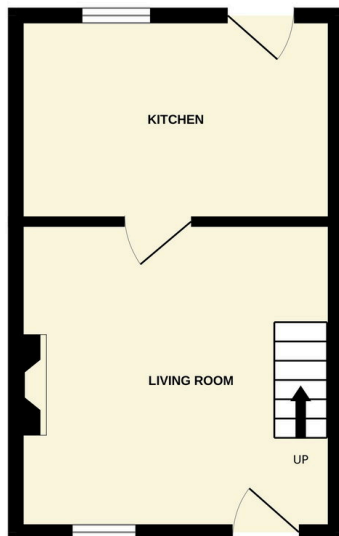

1ST FLOOR

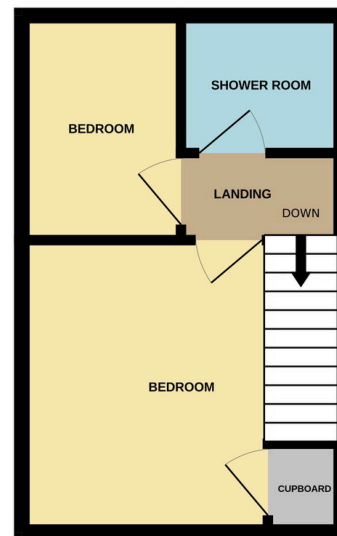

Whilst every attempt has been made to ensure the accuracy of the floorplan contained here, measurements of doors, windows, rooms and any other items are approximate and no responsibility is taken for any error, omission or mis-statement. This plan is for illustrative purposes only and should be used as such by any prospective purchaser. The services, systems and appliances shown have not been tested and no guarantee as to their operability or efficiency can be given.  
Made with Metropix ©2026