



**29 Onslow Road, Newent GL18 1TL**  
**£219,950**



## 29 Onslow Road, Newent GL18 1TL

• Well presented home • ideal first time or investment buy • Two double bedrooms • Pleasant gardens and parking • Close to amenities • EPC (tbc) • Forest of Dean district council tax band B (£1,970.01 (2026/27))

**£219,950**

### Entrance Hall

Accessed via the front door with stairs leading up to first floor and door into living room.

### Living Room

A generous space with window to the front aspect, door to understairs storage cupboard and door into kitchen.

### Kitchen/Diner

Well appointed kitchen with a range of base and wall mounted cupboards with modern work surfaces, stainless steel sink unit, built in electric oven, gas hob with extractor hood over, integrated dishwasher, space for fridge/freezer, window to the rear aspect overlooking the garden and opening to rear lobby.

### Rear Hall

Practical rear access to garden and door into cloakroom.

### WC

Suite comprising WC and wash basin.

### Bedroom One

Good sized double room with three built in storage cupboards and window to the front aspect.

### Bedroom Two

Generous second bedroom with window to the rear aspect.

### Bathroom

Modern white suite comprising bath with direct feed shower over, WC and wash basin. Frosted window to the rear aspect.

### Outside

To the front of the property is a lawn with path leading to the front door. To the side is a block paved parking area with gated access leading to the rear garden which enjoys a covered patio area, further open patio, and an expanse of lawn



1 High Street, Newent, GL18 1AN

**01531 828970**

**newent@naylorpowell.com**

**www.naylorpowell.com**



beyond picket fencing. The garden is fully enclosed by fencing.

### **Location**

Newent originally called Noent is a small market town about 8 miles north west of Gloucester, on the northern edge of the Forest of Dean. The town includes a half-timbered market house, plus other houses of historical nature and Newent Lake a large picturesque lake in the centre of the town, originally part of the Newent Court Estate. Newent is served by three schools, doctors' surgery and dentist, Sports & Leisure Centre. Excellent motorway links to the M50 & M5

### **Material Information**

Tenure: Freehold

Council tax band: B

Local authority and rates: Forest of Dean District Council £1,970.01 (2026/27)

Electricity supply: Mains

Water supply: Mains

Sewerage: Mains

Heating: Gas

Broadband speed: Basic 13 Mbps, Superfast 57 Mbps

Mobile phone coverage: EE, Vodaphone, O2, Three





GROUND FLOOR  
393 sq.ft. (36.5 sq.m.) approx.

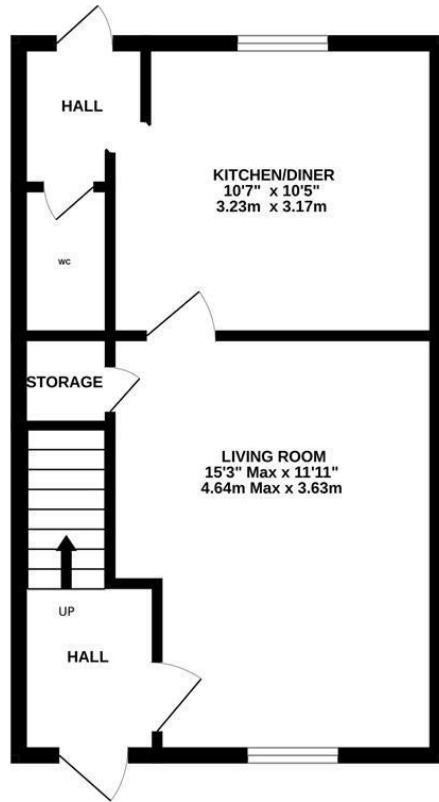

1ST FLOOR  
393 sq.ft. (36.5 sq.m.) approx.

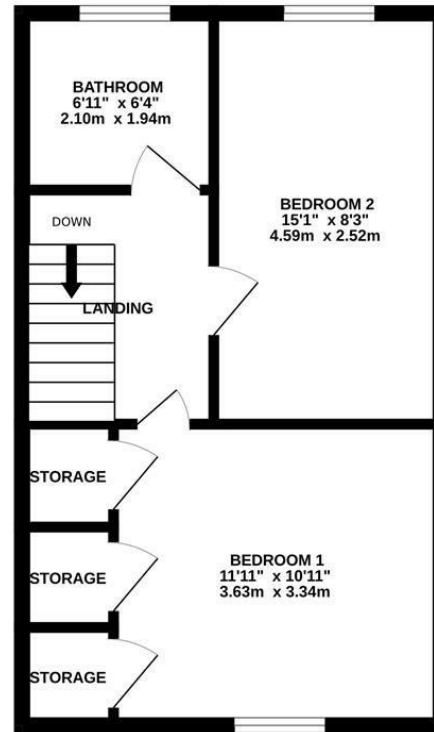

TOTAL FLOOR AREA : 786 sq.ft. (73.1 sq.m.) approx.

Whilst every attempt has been made to ensure the accuracy of the floorplan contained here, measurements of doors, windows, rooms and any other items are approximate and no responsibility is taken for any error, omission or mis-statement. This plan is for illustrative purposes only and should be used as such by any prospective purchaser. The services, systems and appliances shown have not been tested and no guarantee as to their operability or efficiency can be given.  
Made with Metropix ©2025

1 High Street, Newent, GL18 1AN | Tel: 01531 828970 | Email: newent@naylorpowell.com | www.naylorpowell.com

Disclaimer: These particulars do not form part of any contract and no responsibility is accepted for any errors or omissions in any statement made, whether verbally or written for or on behalf of Naylor Powell.

Floorplans have been prepared for identification purposes only, they are not to scale and no guarantee can be given as to their accuracy.

Prospective purchasers please be aware none of the appliances, boiler, heaters etc. which may have been mentioned in these particulars have been tested and no guarantee can be given that they are in working order. Prospective purchasers should arrange for such items to be tested at their own expense.

Energy Efficiency Rating

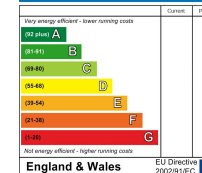

Environmental Impact (CO<sub>2</sub>) Rating

