



# Bluebell Rise

Grange Park, Northampton

oriordanbond  
SALES & LETTINGS



GROUND FLOOR

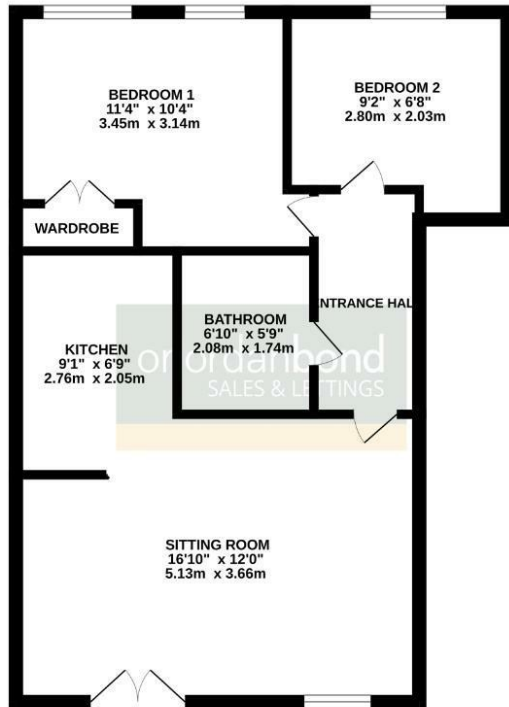

TOTAL FLOOR AREA: 550sq.ft. (51.1 sq.m.) approx.

Whilst every attempt has been made to ensure the accuracy of the floorplan contained herein, measurements of doors, windows, rooms and any other items are approximate and no responsibility is taken for any error, omission or mis-statement. This plan is for illustrative purposes only and should be used as such by any prospective purchaser. The services, systems and appliances shown herein have not been tested and no guarantee as to their operability or efficiency can be given.  
Made with Metropac (2025)

## Bluebell Rise

Grange Park

NN4 5DF

PRICE £155,000

A well presented two bedroom top floor apartment in the popular area of Grange Park. Offered for sale with no onward chain, the apartment is located near to Foxfield Country Park, local amenities and gives good access to Junction 15 for the M1 and the A45.

The accommodation comprises secure communal entry, entrance hall, well decorated sitting/dining room with Juliette balcony, fitted kitchen, two good size bedrooms and a bathroom. The property benefits from uPVC double glazing and gas radiator heating. Outside is allocated parking to the front and guest spaces in the communal parking area. (A/550/-)

Leasehold Information: Lease Remaining - 102 years (as of 2025) / Ground Rent and Service Charge - £1301.62 per annum

### Additional information

- Council Tax Band: B
- Energy Efficiency Rating: C

### Viewing

Viewing strictly by appointment – details below

### Disclaimer

O'Riordan Bond Estate Agents Limited has not tested apparatus, equipment, fittings or services and so cannot verify they are in working order. The buyer is advised to obtain verification from their solicitor or surveyor.

O'Riordan Bond Grange Park Sales

01604 432007

grangepark@oriordanbond.co.uk

