



Falcon

01752 600444

8 Rock Gardens

Plymouth, PL9 7FD

Guide Price £280,000 - £285,000





In Brief

Stylish 3-bed family home with woodland outlook, garage and no onward chain.

Reception Rooms Large sunny living room

Bedrooms 3 bedrooms plus en-suite

Heating Gas central heating

Area 815 sq ft

Tenure Freehold

Parking Garage + parking space

Council Tax D

Description

Situated in a quiet tucked-away cul-de-sac on the fringes of the highly sought-after Saltram Meadows development, this beautifully presented three-bedroom semi-detached home enjoys a lovely private position with no houses opposite, just a small area of woodland to the front. The accommodation comprises an entrance hall with downstairs WC, a spacious front-facing living room, and a well-appointed kitchen/dining room to the rear featuring a great range of fitted units, integrated oven and hob, and double doors opening directly onto the garden. Upstairs are three good-sized bedrooms, including a principal bedroom with en-suite shower room, together with a stylish family bathroom. The property also benefits from gas central heating and uPVC double glazing throughout. Outside, the enclosed rear garden is mainly laid to lawn with a decked seating area, creating an ideal space for relaxing and entertaining. To the rear of the property is a garage with a private parking space in front – a valuable addition to this fantastic family home. Conveniently located close to excellent local schools and within easy reach of Plymstock Broadway's shops and amenities, this superb home is offered to the market with the added advantage of no onward chain.

Need A Mortgage?

**Don't pay more than you need to for your mortgage advice:
ours is only £195 paid when you move!**

Floor Plans

GROUND FLOOR
408 sq.ft. (37.9 sq.m.) approx.

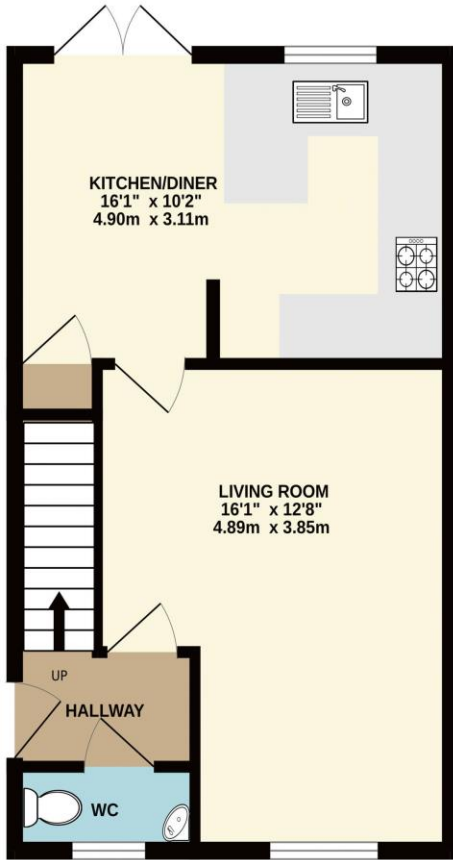

1ST FLOOR
407 sq.ft. (37.8 sq.m.) approx.

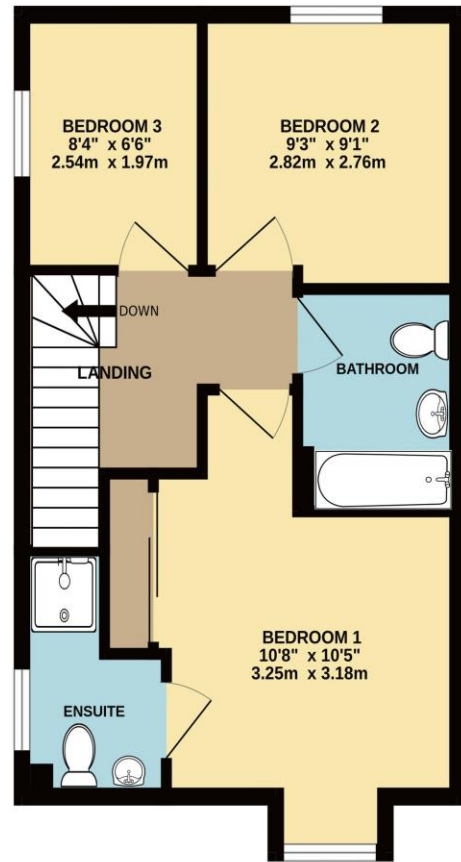

TOTAL FLOOR AREA: 815 sq.ft. (75.7 sq.m.) approx.
Made with Metropix ©2026



Fixed Price Conveyancing

A complete solution from just £600 with No sale – No Fee



We have not tested any apparatus, equipment, fixtures and fittings or services and so cannot verify that they are connected, in working order or fit for the purpose. Neither have we had sight of the legal documents to verify the Freehold or Leasehold status of any property; or sight of any consents, including Planning Permissions, building Regulations and Breaches of Covenants that may be required for alterations to the property. A buyer is advised to obtain verification from their Solicitor and/or Surveyor. Items shown in photographs are NOT included unless specifically mentioned within the Sales Particulars. Any floor plans on these details are not drawn to scale and are intended for guidance only

Falcon Property is an Introducer to Bradleys Financial Management Ltd. They are appointed representatives of Sesame Ltd who are authorised and regulated by the Financial Services Authority. Bradleys do not charge for mortgage advice, however a fee paying option is available. Typical fee is £195. Bradleys Financial Management: 16 Mannamead Road, Mutley, Plymouth, PL4 7AA

Your home may be repossessed if you do not keep up repayments on your mortgage.

