



Long Lane, SE1

£275,000

A smartly presented, south-facing studio apartment set within a sought-after modern development, quietly positioned at the rear of the building. The property features a bright open-plan living space, excellent built-in storage, and a contemporary three-piece bathroom suite. Residents also benefit from 24-hour concierge service and lift access.

Long Lane is enviably located at the foot of Borough Market, with Borough tube station less than 160 metres away. London Bridge, the South Bank, Borough Market, Bermondsey Street and the Shard are all nearby.

Features

- Studio Apartment
- South-Facing Aspect
- 24 Hour Concierge
- Lift Access & Secure Entry
- Water Rates Included

Long Lane, London, SE1

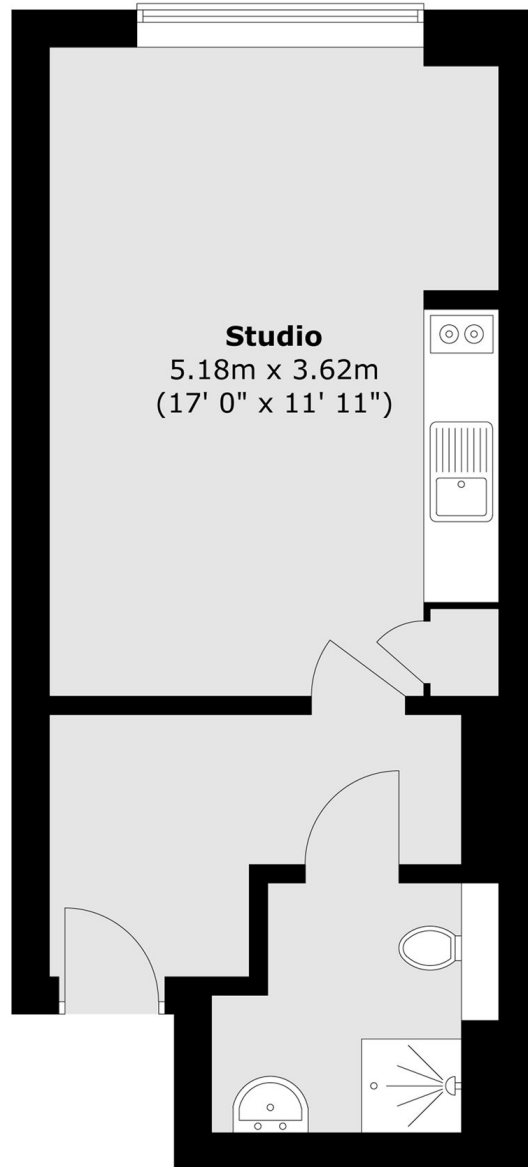

Total area (approx.) : 29.9 sq. m (322 sq. ft)