

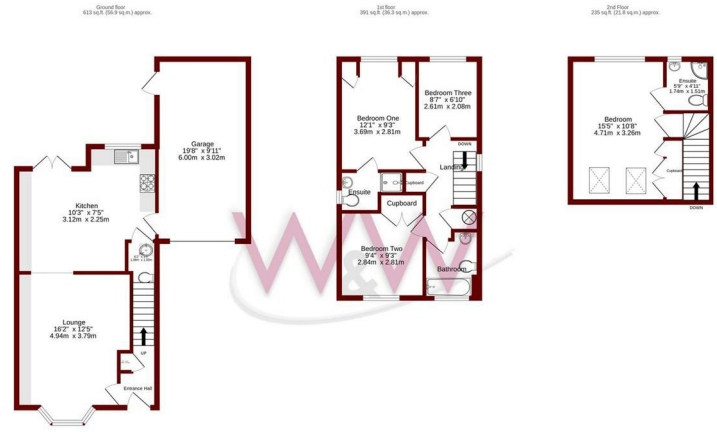

Park Mews | Park Gate | Southampton | SO31 1ED

**£1,800 Per Month**





TOTAL FLOOR AREA: 1238 sq ft (115.0 sq m) approx.  
 Whilst every effort has been made to ensure the accuracy of the figures contained here, measurements of doors, windows, rooms and any other items are approximate and no responsibility is taken for any error, omission or misstatement. This plan is for illustrative purposes only and should be used as such for only prospective purchase. The service, quality and appearance shown here has not been tested and no guarantee as to their operability or efficiency can be given.  
 Made with Metaphor 02034

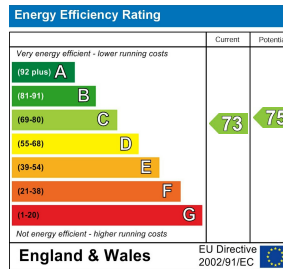

## Description

W&W are delighted to offer for let this spacious 3 floor, four bedroom link-detached family home. The property enjoys four bedrooms, a modern open plan kitchen diner, large lounge & en-suite shower room to the master bedroom and second bedroom. The property also enjoys a rear garden, garage and driveway parking. Please get in contact to secure a viewing.

## Key features



H3 Whiteley Shopping Centre  
 Whiteley Way  
 Whiteley  
 Hants  
 PO15 7PD  
 01489 580800  
 pm@walkerwaterer.co.uk  
 www.walkerwaterer.co.uk