



## 5 Manor House

London Road | Blackwater | Camberley | GU17 0AA

£1,200 PCM

*Waterfords*   
Residential Sales & Lettings



GROUND FLOOR

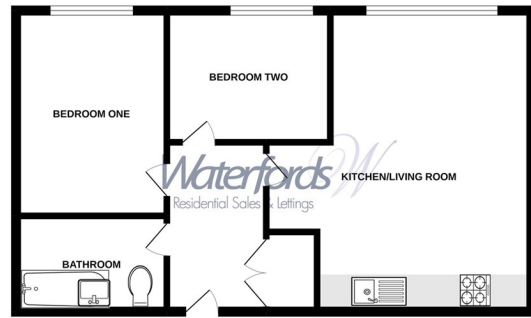

Energy efficiency has been made to ensure the accuracy of the Energy Performance Certificate. Measurements of energy efficiency, when used, are approximate and no responsibility is taken for any errors. Information is provided for general guidance only and should not be used as a basis for any prospective purchase. The current, specific and detailed details have been reviewed and no guarantee is given for their accuracy or efficiency can be given. Waterfords 2022

Energy Efficiency Rating		Current	Potential
Very energy efficient - lower running costs			
(92 plus)	A		
(81-91)	B		
(69-80)	C		
(55-68)	D	63	63
(39-54)	E		
(21-38)	F		
(1-20)	G		
Not energy efficient - higher running costs			
England & Wales		EU Directive 2002/91/EC	

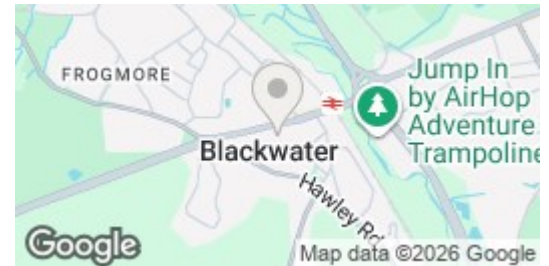

## Description

Waterfords are proud to present this spacious two bedroom apartment located very close to local amenities and just walking distance to Blackwater train station. The property is available June 6th 2026 on a unfurnished basis.

## Key features

- Two Bedroom Apartment
- Allocated Parking
- Well Proportioned Accommodation
- Council Tax Band: B
- Modern Finish Throughout
- Unfurnished
- Available June 6th 2026
- EPC: D



35 Plough Road  
Hampshire  
GU46 7UW  
01276 903006

surreylettings@waterfords.co.uk  
<https://www.waterfords.co.uk/>