



4, RIVERLIGHT QUAY
LONDON, SW11
Asking Price £900,000 Leasehold

Description

A two double bedroom, two bathroom apartment on the 10th floor of this impressive development in the heart of Nine Elms.

The property comprises approx.784sq.ft (72sq.m) of living space, with open plan living to the highest standards. There are full floor to ceiling windows accessing 2 private balconies and offering views of the River Thames and beyond. The apartment also has a smart custom designed fitted kitchen with Siemens appliances; there are 2 luxury bathrooms (1 En-suite) with Villeroy & Boch and Kaldewei sanitary ware, wood flooring and comfort cooling.

Riverlight features an exclusive residents Clubhouse with a sunlit atrium swimming pool and spa, a well-equipped mezzanine "river view" gymnasium, a reception lounge and library, as well as virtual golf, a cinema screening and digital games room, 24 hour concierge and a shuttle bus service to the transport links of Vauxhall, which are close by.

EPC B / Council Tax Wandsworth Band F

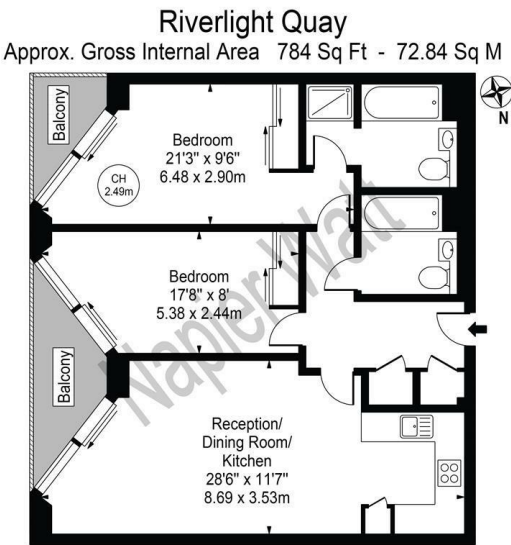

Tenth Floor

For Illustration Purposes Only - Not To Scale

This floor plan should be used as a general outline for guidance only and does not constitute in whole or in part an offer or contract. Any intending purchaser or lessee should satisfy themselves by inspection, searches, enquiries and full survey as to the correctness of each statement. Any areas, measurements or distances quoted are approximate and should not be used to value a property or be the basis of any sale or let.

TERMS

Tenure: 999 years from 1 January 2012 ie 985 years
Ground Rent £700pw
Council Tax Wandsworth Band F
EPC B