



Chiswick High Road, W4

£725,000



- Two Bedrooms
- Open Plan Reception/Kitchen
- Two balconies
- Lift Access
- Great Transport Links
- Allocated Underground Parking

Chiswick High Road, W4

Approx. Gross Internal Area :-
93 sq m / 1001 sq ft

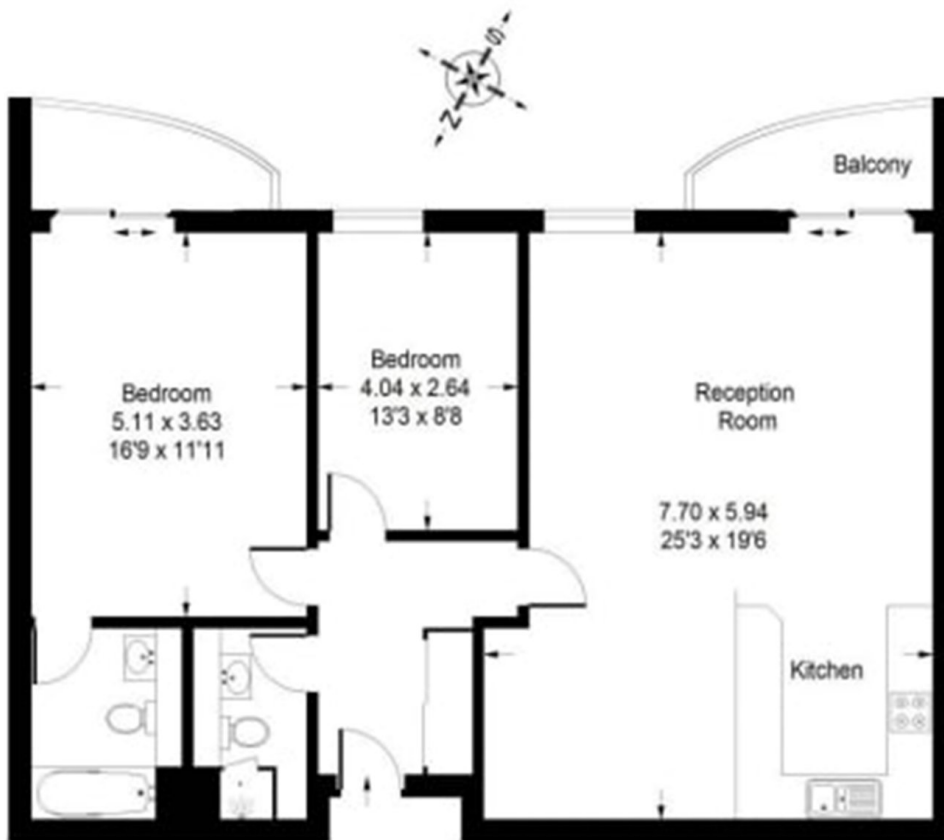

Second Floor

Marsh & Parsons Chiswick

34-38 Turnham Green
Terrace, London, W4 1QP
020 8994 2556

We aim to make our particulars both accurate and reliable. However, they are not guaranteed; nor do they form part of an offer or contract. If you require clarification on any points then please contact us, especially if you're traveling some distance to view. Please note that appliances and heating systems have not been tested and therefore no warranties can be given as to their good working order.