



Connells

Petworth Gardens
Southampton

Petworth Gardens Southampton SO16 8EE

for sale offers in excess of
£300,000



Property Description

Secluded in a peaceful cul-de-sac within the sought after residential area of Lordswood, this lovely three-bedroom end-terraced home offers the perfect blend of space, comfort and convenience.

Set on a generous plot, the property greets you with welcoming front garden. Once your inside and you'll find a light-filled living room with wonderful log burner, leading to a well-equipped kitchen / dining room, with direct access leading to the private enclosed garden - the ideal spot to entertain friends and family.

Upstairs, three good sized bedrooms provide peaceful accommodation for families or those in need of a little extra space. In addition, the property also comprises off road parking space outside of garage.

Lordswood is a well-regarded residential area on the northern side of Southampton, with convenient access to everyday amenities, schools, nurseries and local shops. Southampton Sports Centre is less than a 10 minute drive and provides a fantastic green space, popular with dog walkers and families. Southampton General Hospital, Shirley High Street and retail shops are close by, with strong motorway and public transport links.

Hallway

Living Room

14' 8" x 14' 4" (4.47m x 4.37m)

Kitchen/Dining Room

14' 8" x 9' 6" (4.47m x 2.90m)

Stairs Leading To First Floor

Bedroom One

13' 9" x 8' 6" (4.19m x 2.59m)

Bedroom Two

9' x 8' 6" (2.74m x 2.59m)

Bedroom Three

10' 9" x 6' 7" (3.28m x 2.01m)

Bathroom

6' 8" x 6' 7" (2.03m x 2.01m)







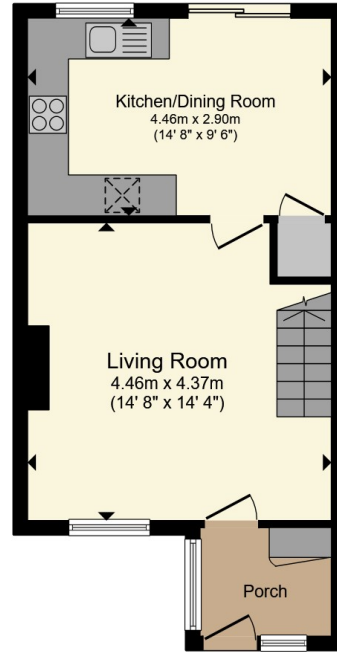

Ground Floor

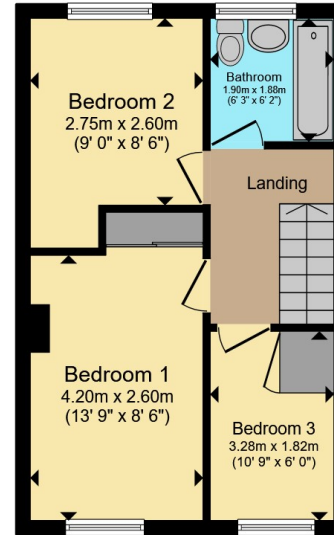

First Floor

Total floor area 69.0 m² (743 sq.ft.) approx

This floor plan is for illustrative purposes only. It is not drawn to scale. Any measurements, floor areas (including any total floor area), openings and orientation are approximate. No details are guaranteed, they cannot be relied upon for any purpose and they do not form part of any agreement. No liability is taken for any error, omission or misstatement. A party must rely upon its own inspection(s). Powered by www.propertybox.io



To view this property please contact Connells on

T 02380 789 351
E shirley@connells.co.uk

409 Shirley Road Shirley
SOUTHAMPTON SO15 3JD

EPC Rating: C Council Tax
Band: C

Tenure: Freehold

view this property online connells.co.uk/Property/SSR312722



1. MONEY LAUNDERING REGULATIONS Intending purchasers will be asked to produce identification documentation at a later stage and we would ask for your co-operation in order that there will be no delay in agreeing the sale. 2. These particulars do not constitute part or all of an offer or contract. 3. The measurements indicated are supplied for guidance only and as such must be considered incorrect. Potential buyers are advised to recheck measurements before committing to any expense. 4. We have not tested any apparatus, equipment, fixtures, fittings or services and it is in the buyers interest to check the working condition of any appliances.

Connells Residential is registered in England and Wales under company number 1489613, Registered Office is Cumbria House, 16-20 Hockliffe Street, Leighton Buzzard, Bedfordshire, LU7 1GN. VAT Registration Number is 500 2481 05.

See all our properties at www.connells.co.uk | www.rightmove.co.uk | www.zoopla.co.uk

Property Ref: SSR312722 - 0004