



# Highslade

Brixworth, Northamptonshire

oriordanbond  
SALES & LETTINGS



## Highslade

Brixworth  
NN6 9UH

Guide Price  
£550,000

- Stunning extended detached family home
- Refurbished and decorated to high standard
- Four double bedrooms and refitted ensuite
- Double garage with electric shutter doors
- Quiet cul-de-sac position
- Landscaped gardens





GROUND FLOOR  
985 sq.ft. (91.5 sq.m.) approx.

1ST FLOOR  
935 sq.ft. (86.9 sq.m.) approx.

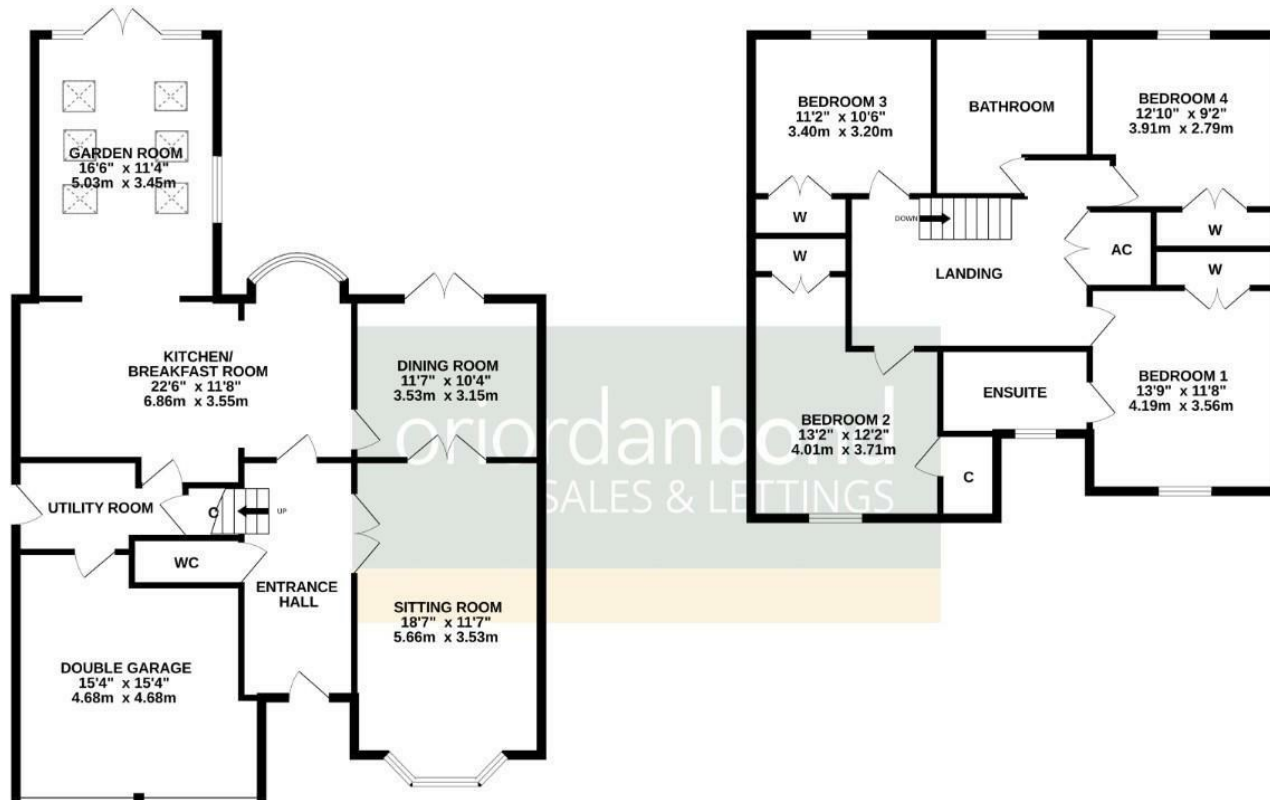

EXCLUDING GARAGE

TOTAL FLOOR AREA: 1920sq.ft. (178.4 sq.m.) approx.

Whilst every attempt has been made to ensure the accuracy of the floorplan contained here, measurements of doors, windows, rooms and any other items are approximate and no responsibility is taken for any error, omission or mis-statement. This plan is for illustrative purposes only and should be used as such by any prospective purchaser. The services, systems and appliances shown have not been tested and no guarantee as to their operability or efficiency can be given.  
Made with Metropix ©2025

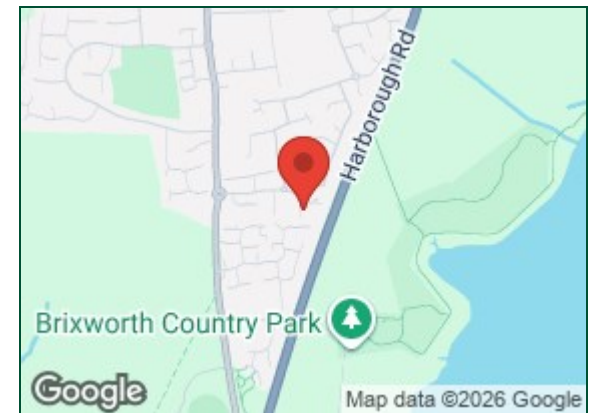
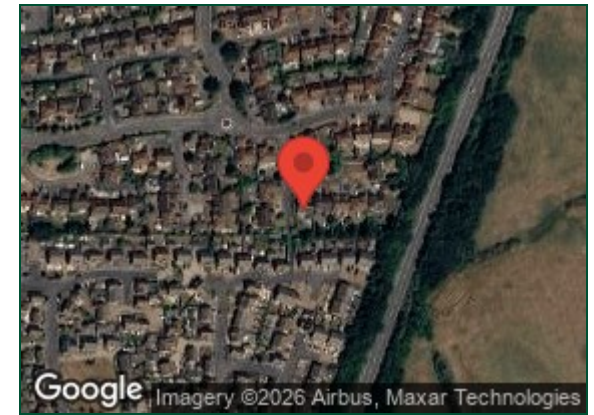

**Additional information**

- Council Tax Band: F
- Energy Efficiency Rating: C

**Viewing**

Viewing strictly by appointment – details below

**Disclaimer**

O’Riordan Bond Estate Agents Limited has not tested apparatus, equipment, fittings or services and so cannot verify they are in working order. The buyer is advised to obtain verification from their solicitor or surveyor.

O’Riordan Bond Brixworth Sales

01604 880077

brixworth@oriordanbond.co.uk

