



105 Foley Road West, Sutton Coldfield - B74 3PA
£195,000





105 Foley Road West

Sutton Coldfield

Upon entering, you are welcomed by an immaculate and spacious hallway that sets the tone for the thoughtfully arranged layout and impressive sense of space found throughout the property.

The expansive living room is a true highlight, with a feature fireplace providing a focal point, and elegant patio doors opening directly onto the private garden, creating a seamless connection between indoor and outdoor living. The well appointed breakfast kitchen is designed for both functionality and style, offering ample space for informal dining and benefitting from a window to the front that allows natural light to flood the room.

The principal bedroom is a peaceful retreat, complete with fitted wardrobes to maximise storage and a modern en-suite shower room for added convenience. A further double bedroom provides flexibility for guests or home working, while the main bathroom is finished to a high standard, catering to both residents and visitors.

The apartment also benefits from residents parking, ensuring ease and comfort for homeowners and guests alike.

The private garden is a rare advantage for apartment living, providing a tranquil oasis for relaxation, entertaining, or al fresco dining.



- Spacious ground floor apartment offering an appealing sense of space

- Thoughtfully arranged layout





FEATURES:

- Spacious ground floor apartment offering an appealing sense of space
- Thoughtfully arranged layout
- Generous living room with patio doors to garden
- Well appointed breakfast kitchen
- Two double bedrooms with the principal bedroom having en-suite
- Private garden
- Residents parking for ease and comfort
- Offered with no upward chain

INTERESTED:

0121 308 3355

fouroaks@moorhouse-property.co.uk



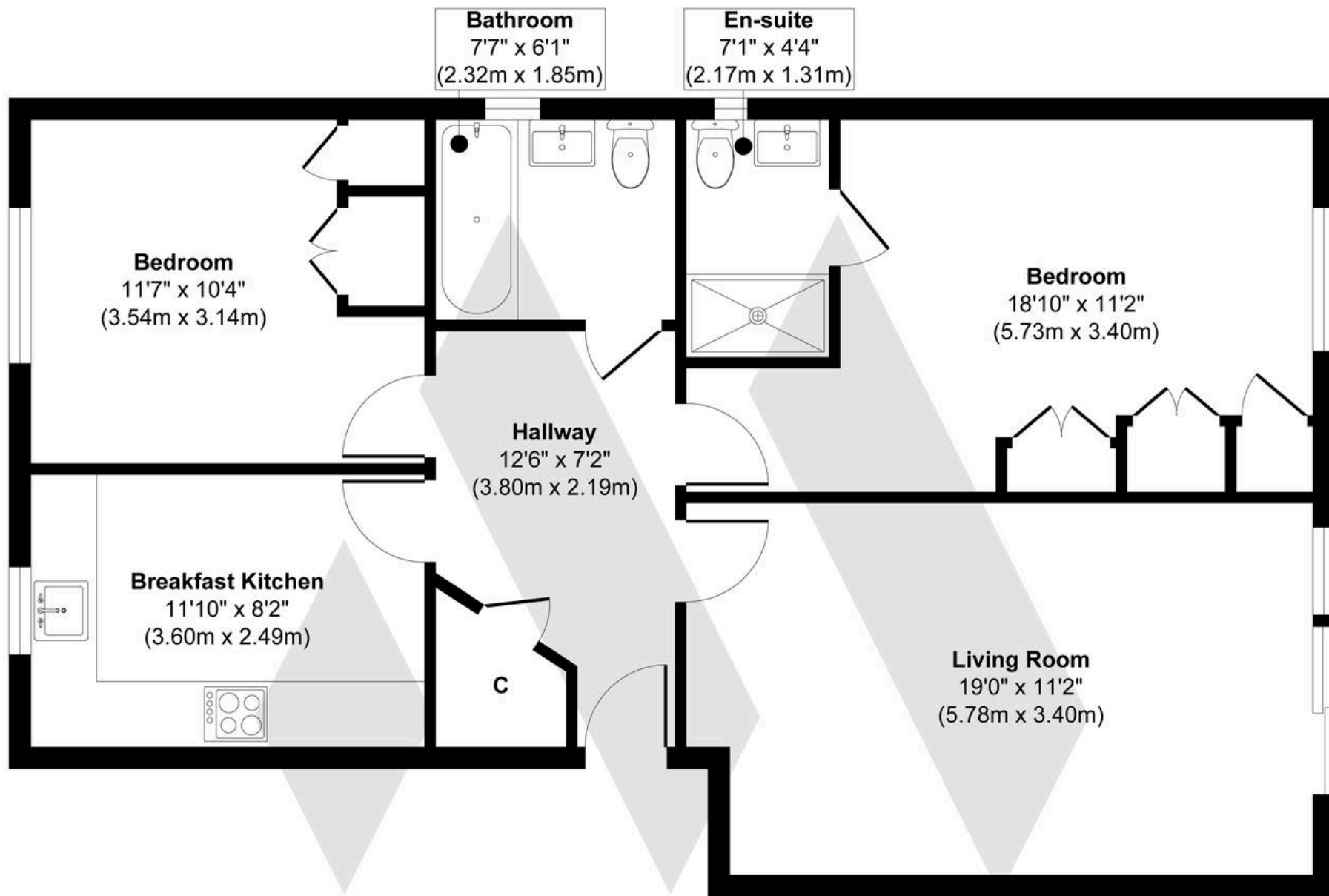

Floor Plan

Approx. Gross Internal Floor Area 790 sq. ft / 73.39 sq. m

Illustration for identification purposes only, measurements are approximate, not to scale.

Produced by Elements Property

MOORHOUSE

