



84 Howard Cornish Road, Marcham OX13 6PU



84 Howard Cornish Road

Located on a corner plot within this extremely sought after Oxfordshire village a generously proportioned three-bedroom semi detached family home having been extended by the existing owners coming to the market with the security of no onward chain.

84 Howard Cornish Road is well-situated within the heart of this very popular village, situated only 3 miles from Abingdon town, and offers easy vehicular access to Oxford city and the M4 motorway. The village offers many amenities including general store with post office, ancient parish church, thriving primary school, public house and excellent sporting facilities, all within a short walk from the property. Useful distances include Abingdon town (circa. 3 miles), Oxford city (circa. 6 miles) and Didcot town with its useful mainline railway station to London Paddington (circa. 10 miles).

Bedrooms: 3

Bathrooms: 1

Reception Rooms: 2

Council Tax Band: D

Tenure: Freehold

EPC: D





Key Features

- Generous entrance hall with doors to all principal rooms and cloakroom off
- Wonderfully light double aspect living room with open fireplace
- Double aspect fitted kitchen with a door leading onto the gardens this is in turn is open plan to a striking extended dining room
- 15' x 13' dining room with French doors out onto the garden, flooded with natural light from the two sets of glazed doors and skylights
- To the first floor, arranged around a spacious landing, are three well proportioned bedrooms all complemented by a family bathroom with white suite
- Ample driveway parking leading to a single garage with light and power
- Additional, versatile brick belt outbuilding currently used as a utility room with water and power connected
- Externally the property benefits from mature rear gardens with gated side access, there is a covered dining area and lawn, all enclosed by fencing, offering good degrees of privacy









BRITISH
PROPERTY
AWARDS
2024

GOLD WINNER

ESTATE AGENT
IN ABINGDON



Introducing the Hodsons team...
...trust in our experience!





Howard Cornish Road, OX13

Approximate Gross Internal Area = 104.70 sq m / 1127 sq ft
Garage = 17.70 sq m / 191 sq ft
Total = 122.40 sq m / 1318 sq ft
For identification only - Not to scale



First Floor

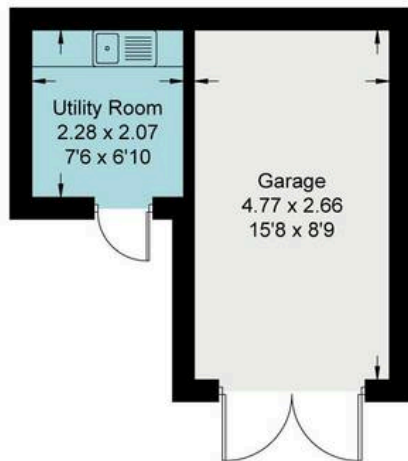

(Not Shown In Actual Location / Orientation)



Ground Floor

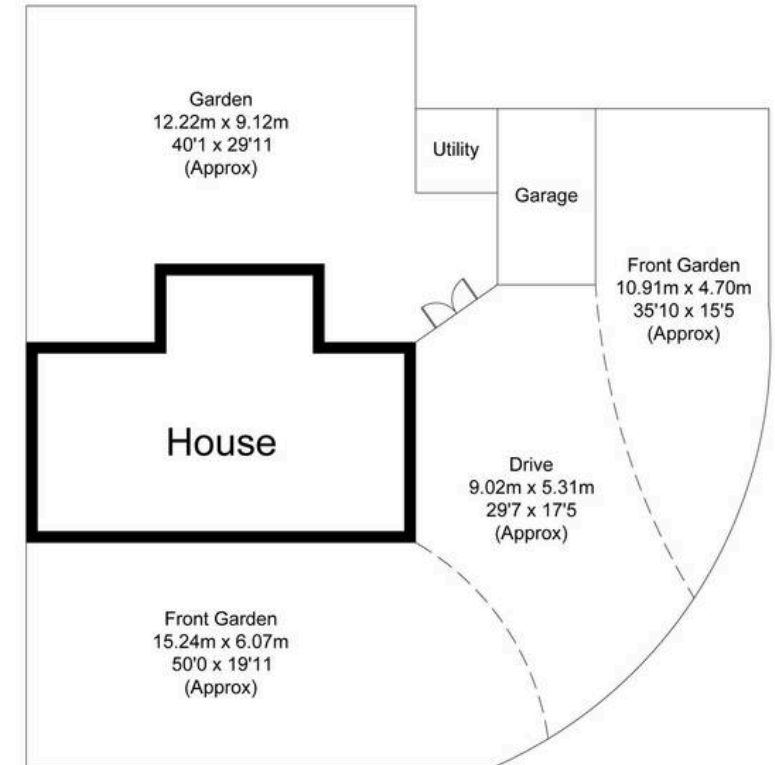

Not to scale, for illustration and layout purposes only.
© Mortimer Photography. Produced for Hodsons.
Unauthorised reproduction prohibited



Hodsons
...your move, our passion
Sales | Lettings

5 Ock Street, Abingdon,
Oxfordshire, OX14 5AL
T: 01235 553686
E: abingdon@hodsons.co.uk
www.hodsons.co.uk