

FREEHOLD



House - Townhouse (EPC Rating: C)

CAMERON CRESCENT, EDGWARE

HA8 0FH

Offers Over

£550,000



4 Bedroom House - Townhouse located in Edgware

Maxwell Estates are delighted to present this four bedroom, end of terrace townhouse. Located in Edgware

The the ground floor benefits from a garage, study bedroom, utility and shower room. The fully fitted kitchen, large reception room and guest WC are all located on the first floor. On the top floor are three bedrooms (one en-suite in the master bedroom).

This property boasts private rear garden as well as paved off-street parking.

Ideally situated within easy reach of Edgware and Burnt Oak Underground stations, local shopping amenities, schools and transport links, this attractive family home combines convenience, space and modern living in a highly sought-after residential location.

Call us now to arrange a viewing!

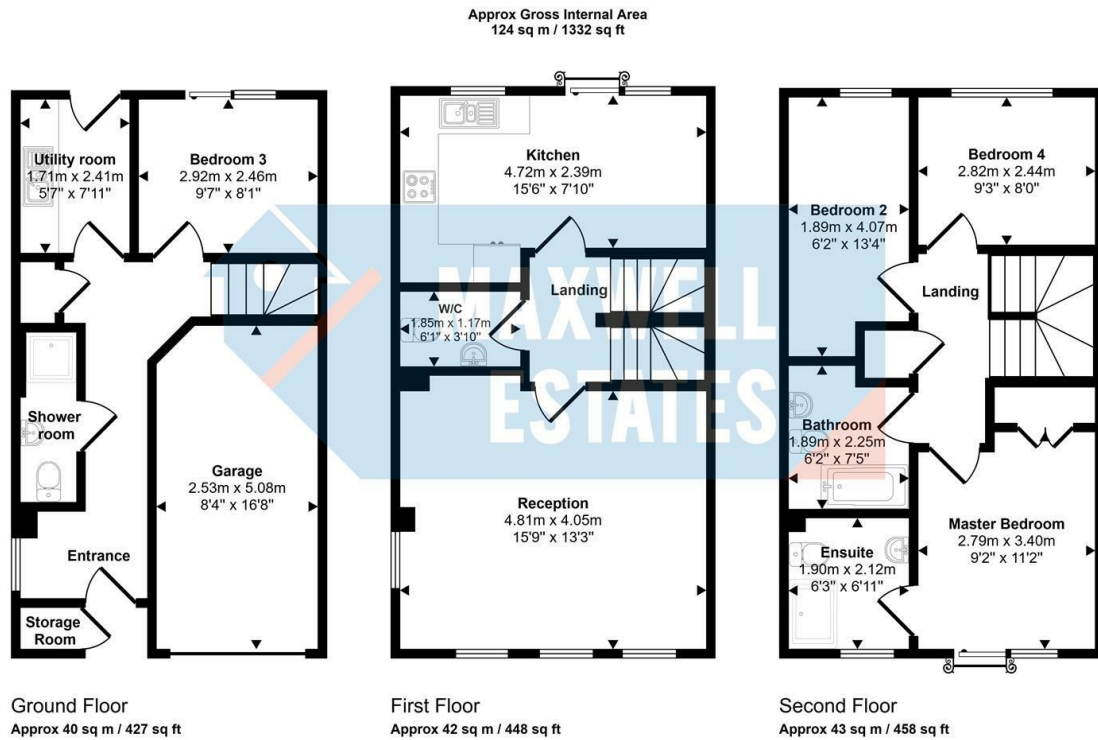

This floorplan is only for illustrative purposes and is not to scale. Measurements of rooms, doors, windows, and any items are approximate and no responsibility is taken for any error, omission or mis-statement. Icons of items such as bathroom suites are representations only and may not look like the real items. Made with Made Snappy 360.

Council Tax Band

F

Energy Performance Graph

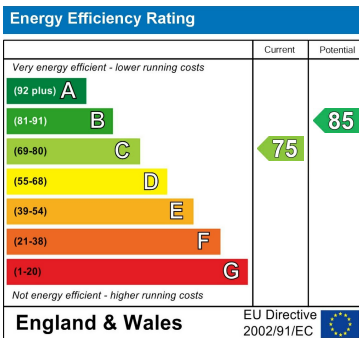

Call us on

0208 959 0000

info@maxwellestates.co.uk

www.maxwellestates.co.uk

Agents Note: Whilst every care has been taken to prepare these particulars, they are for guidance purposes only. All measurements are approximate and are for general guidance purposes only and whilst every care has been taken to ensure their accuracy, they should not be relied upon and potential buyers are advised to recheck the measurements.

