



Rotherhithe New Road, SE16

£375,000

This bright and modern one-bedroom apartment is set within a stylish development that offers the added benefit of an on-site concierge and a residents' gym. The flat features a spacious open-plan living and kitchen area, creating a comfortable space to relax, cook, and entertain. Large doors lead out onto a private balcony, bringing in plenty of natural light.

Well-connected part of London and is within easy reach of both South Bermondsey railway station and Bermondsey Underground Station, making it ideal for commuters. Bermondsey Station (Jubilee line) offers quick access to London Bridge, Canary Wharf and the West End, while South Bermondsey provides regular National Rail services.

Features

- One bedroom
- Private Balcony
- Open Plan Living Room
- Concierge
- Gym In Building
- Close To Transport Links

Rotherhithe New Road, London, SE16

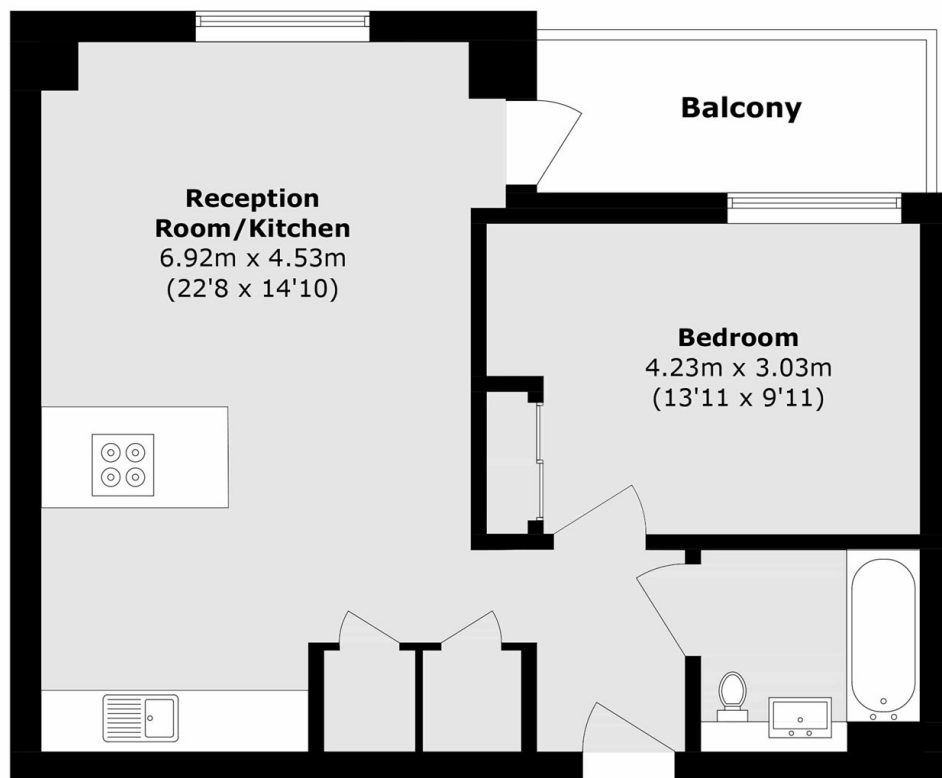

Total area (approx.): 52.1 sq. m (560.8 sq. ft)

Balcony area (approx.): 5.6 sq. m (60.2. sq. ft)