



## Headstone Road, HA1

£300,000

A well-presented two double bedroom ground floor garden flat boasting its own private entrance features a bright reception room with direct garden access, a modern fitted kitchen, and a stylish family bathroom. Both bedrooms are generously sized, with Bedroom 1 benefiting from a bay window and feature fireplace. Externally, the flat offers a private rear garden with patio and lawned area.

Just a short walk from Harrow-on-the-Hill station (0.3 of a mile), the location offers excellent transport links via the Metropolitan and Chiltern Rail lines, making commuting into central London quick and convenient. Just minutes away lies Harrow town center, filled with high street shops, supermarkets, independent cafes, restaurants, and essential services like pharmacies and banks. There are also several local schools within walking distance, including Norbury School and The Jubilee Academy, making the area suitable for families.

- Ground floor garden flat • No Onward Chain • Private Garden •
- Two Double Bedrooms • Private Entrance •

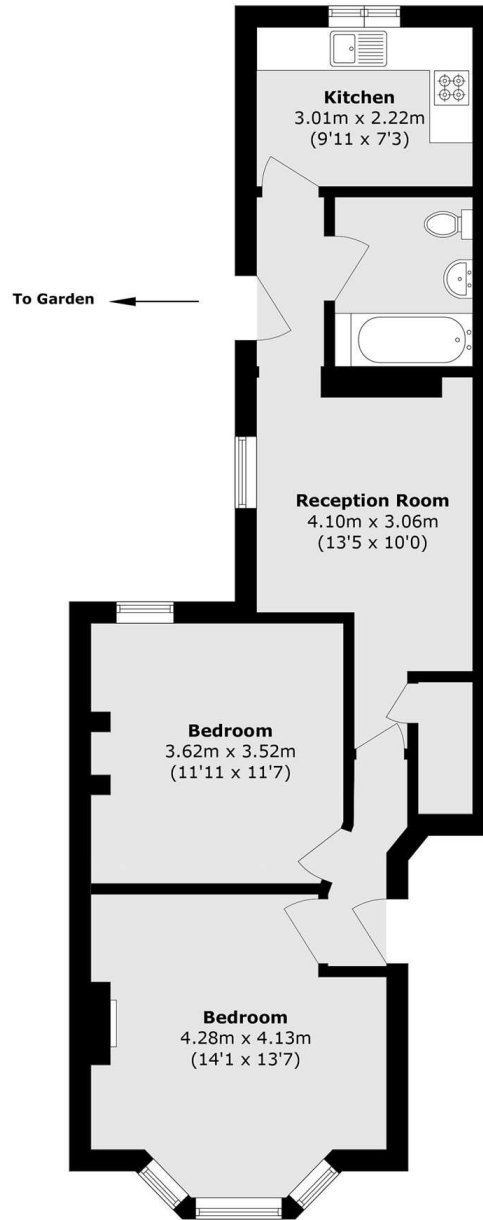

Total area (approx.): 59.9 sq. m (644.8 sq. ft)

David Conway  
020 8422 5222

Energy Rating: C We aim to make our particulars both accurate and reliable. However they are not guaranteed; nor do they form part of an offer or contract. If you require clarification on any points then please contact us, especially if you're travelling some distance to view. Please note that appliances and heating systems have not been tested and therefore no warranties can be given as to their good working order.