

WE VALUE



YOUR HOME



Drayton Road, Dorchester-On-Thames  
£795,000



Set in the sought-after village of Dorchester-on-Thames, this charming three-bedroom detached bungalow enjoys a peaceful position at the end of a low-traffic cul-de-sac, while being just a two-minute walk from the village bus stop with routes to Oxford and Reading. The property offers spacious and versatile living in a highly convenient yet tranquil setting.

The property is approached via a private in-and-out driveway, providing ample off-street parking and a welcoming first impression. Inside, the accommodation is both flexible and well-proportioned, featuring three reception rooms. These include a lounge with an open fireplace, a separate dining room, and a light-filled conservatory overlooking the garden.

Further enhancing the layout is a bright study fitted with desks, making it an ideal home office. The kitchen is complemented by a separate utility room, adding practicality to everyday living.

The bungalow offers three double bedrooms, served by both a family bathroom and an additional shower room, providing convenience for families and guests alike.

Externally, the south-facing rear garden is a true highlight - beautifully maintained and generous in size, perfect for relaxing or outdoor entertaining. To the front, the property enjoys an open and attractive outlook across to a small fishing lake, bordered by a hedgerow and mature trees beyond. A generously sized garage completes this attractive home.





- DETACHED BUNGALOW IN DORCHESTER-ON-THAMES
- BEAUTIFULLY MAINTAINED SOUTH-FACING REAR GARDEN
- LOUNGE, DINING ROOM, STUDY & CONSERVATORY
- KITCHEN & SEPARATE UTILITY ROOM
- THREE WELL-PROPORTIONED DOUBLE BEDROOMS
- IN & OUT DRIVEWAY PROVIDING AMPLE OFF-STREET PARKING & GARAGE
- FAMILY BATHROOM & SHOWER ROOM
- SOLAR PANELS GENERATING AN ESTIMATED ANNUAL RETURN OF APPROX. £1,000 - £1,200

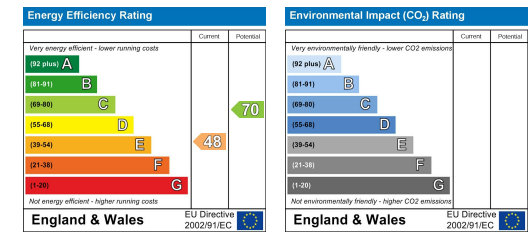

Energy Efficiency Graph

## Floor Plan

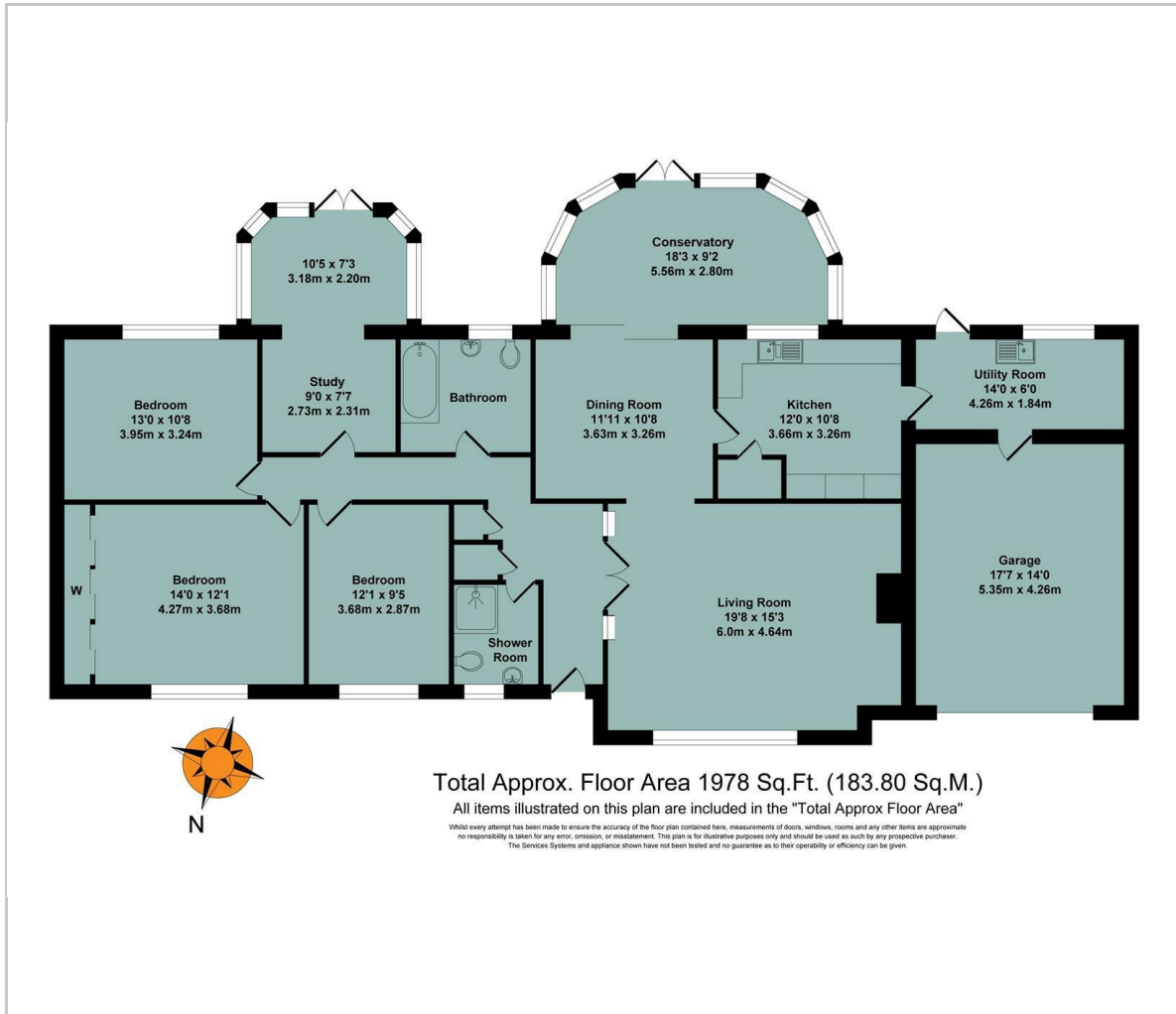

## Area Map



## Viewing

Please contact our In House Sales & Lettings Office on 01491 839999 opt.1 if you wish to arrange a viewing appointment for this property or require further information.

These particulars, whilst believed to be accurate are set out as a general outline only for guidance and do not constitute any part of an offer or contract. Intending purchasers should not rely on them as statements of representation of fact, but must satisfy themselves by inspection or otherwise as to their accuracy. No person in this firms employment has the authority to make or give any representation or warranty in respect of the property.

28 St Martins Street, Wallingford, Oxfordshire, OX10 0AL  
Tel: 01491 839999 opt.1 Email: [sales@inhouseestateagents.co.uk](mailto:sales@inhouseestateagents.co.uk) [www.inhouseestateagents.co.uk](http://www.inhouseestateagents.co.uk)