



**POOLE  
TOWNSEND**

# The Green Lindal, Ulverston

£300,000

3 1 2



- Traditional stone built end terrace home
- 2 reception rooms and ground floor shower room
- Light and bright kitchen
- 3 good sized bedrooms
- Gardens with store
- Attractively presented throughout
- Sought after location with views over the village green
- Driveway parking
- Freehold
- Council tax band B



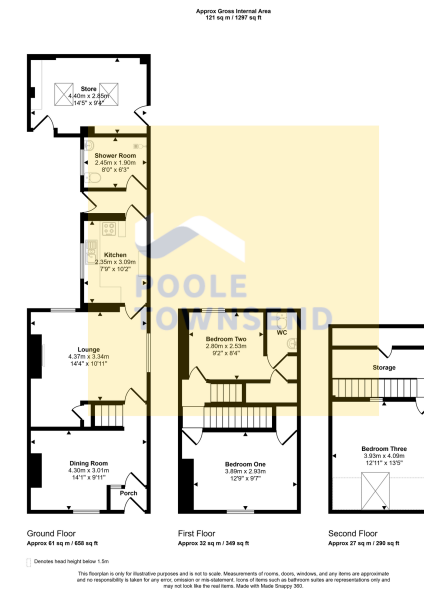

Situated in the picturesque village of Lindal and enjoying attractive views over the village green, this charming three-bedroom home combines a peaceful residential setting with excellent access to local amenities and beautiful surrounding countryside, making it an ideal choice for modern family living. The property offers spacious and versatile accommodation, featuring two generous reception rooms, a contemporary kitchen, and a modern wet room on the ground floor. The three well-proportioned bedrooms are arranged across the first and second floors, with one bedroom benefiting from the added convenience of a private WC en-suite. Externally, the home provides a driveway for off-road parking, a pleasant patio area perfect for outdoor dining and relaxation, a practical drying area, and a substantial garden store offering excellent additional storage.

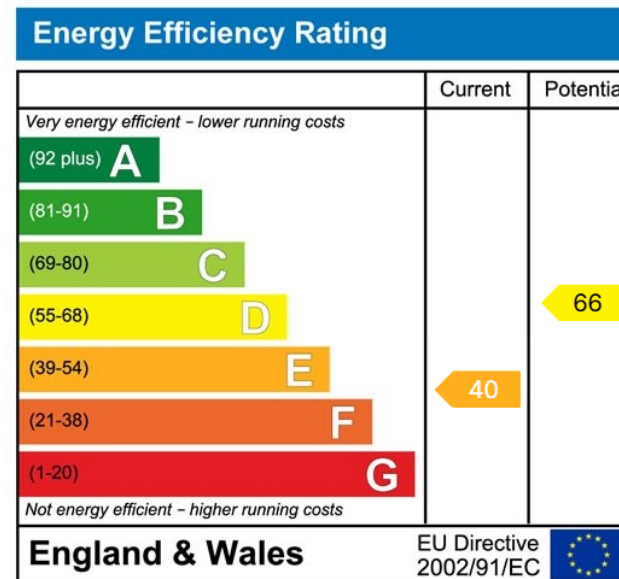

Visit us at  
[www.pooletownsend.co.uk](http://www.pooletownsend.co.uk)  
[enquiries@pooletownsend.co.uk](mailto:enquiries@pooletownsend.co.uk)

We are open  
 Monday – Friday 9.00 – 5.00  
 Saturday 9.00 – 1.00

Barrow 01229 811811  
 Ulverston 01229 588111  
 Grange 015395 33316  
 Kendal 01539 734455  
 Milnthorpe 015395 62044