



TO LET



Flat 2, 4 Queens Road, Farnborough, Hampshire, GU14 6DH
£1,000 PCM

- Available Mid April
- First Floor
- Modern Build And Fittings
- Close to village
- Council Tax Band B
- Double Bedroom
- Fitted Kitchen
- Allocated Parking
- 5 Weeks' Deposit £1153.84
- EPC Energy Rating Band (A) 93

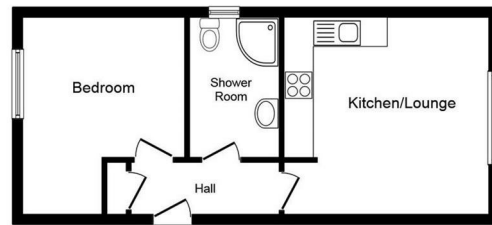

Floor Plan

This plan is for illustration purposes only and may not be representative of the property.
Plan not to scale.



THE PROPERTY

Set in the heart of the ever-popular North Camp Village, this beautifully presented first-floor one-bedroom apartment offers a spacious open-plan living area complemented by a high-specification modern kitchen. Finished to a stylish standard throughout, the property also benefits from the added convenience of off-road parking.

Ideally located in the heart of North Camp, you'll find a vibrant mix of independent shops, cafés and local supermarkets right on your doorstep. North Camp railway station is approximately a 20-minute walk away, with Farnborough Main just a five-minute drive, offering excellent transport links for commuters.

Available Mid April.

SITUATION

Directions