

TO LET



Fulwell Close
£1,600 pcm

MARTIN & CO

Fulwell Close

Date available: 28th of July 2026

Deposit: £1,846.15

Unfurnished

Council Tax band: D

EPC Rating: C

- Modern House
- Close to the train station
- Walking distance to Town Centre
- Off-road Parking
- Unfurnished
- 3 Bedrooms
- Nice Garden

%epcGraph_c_1_322%

Martin and Co are pleased to bring to the market this modern family home close to the town centre and amenities, the house has a nice garden to the rear and gives ample living space in a location close to the train station and other transport links. Early viewings are recommended with this property, contact Martin and Co Banbury as soon as possible

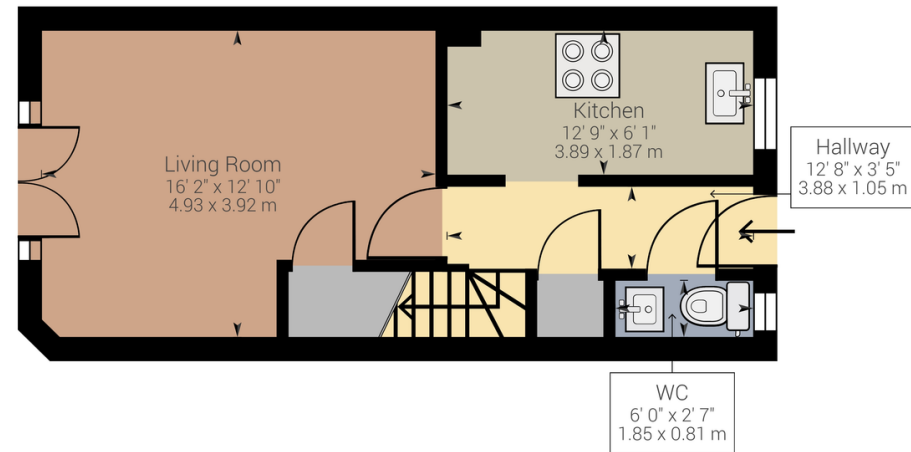

Approximate net internal area: 369.59 ft² / 34.34 m²
While every attempt has been made to ensure accuracy, all measurements are approximate, not to scale. This floor plan is for illustrative purpose only and should be used as such by any prospective tenant or purchaser.

Powered by Giraffe360

Martin & Co Banbury

7 North Bar Street • Banbury • OX16 0TB
T: 01295 701773 • E: banbury@martinco.com

01295 701773
<http://www.martinco.com>

MARTIN&CO

Accuracy: References to the Tenure of a Property are based on information supplied by the Seller. The Agent has not had sight of the title documents. A Buyer is advised to obtain verification from their Solicitor. Items shown in photographs including but not limited to carpets, fixtures and fittings are not included unless specifically mentioned within the sales particulars. They may however be available by separate negotiation. Buyers must check the availability of any property and make an appointment to view before embarking on any journey to see a property. No person in the employment of the agent has any authority to make any representation about the property, and accordingly any information given is entirely without responsibility on the part of the agents, sellers(s) or lessors(s). Any property particulars are not an offer or contract, nor form part of one. **Sonic / laser Tape:** Measurements taken using a sonic / laser tape measure may be subject to a small margin of error. **All Measurements:** All Measurements are Approximate. **Services Not tested:** The Agent has not tested any apparatus, equipment, fixtures and fittings or services and so cannot verify that they are in working order or fit for the purpose. A Buyer is advised to obtain verification from their Solicitor or Surveyor.