

6 Gayton Road, King's Lynn PE30 4DZ

£219,995

 3  1  2



Getting on the property ladder can feel like a big step — but finding the right home makes all the difference. Whether you're looking for your first place to call your own or somewhere to start building your future, this welcoming and well-positioned home offers the perfect balance of space, comfort, and convenience. Lovingly maintained and full of charm, it's ready and waiting for you to make your move.

Key Features

- Semi-Detached House
- Private South Facing Garden
- Superb Location Boasting a Wide Variety of Amenities
- Gas Central Heating
- Council Tax Band - B
- Three Bedrooms
- Generous Accommodation - Two Reception Rooms
- Off-road Parking
- Well Presented
- Double glazed

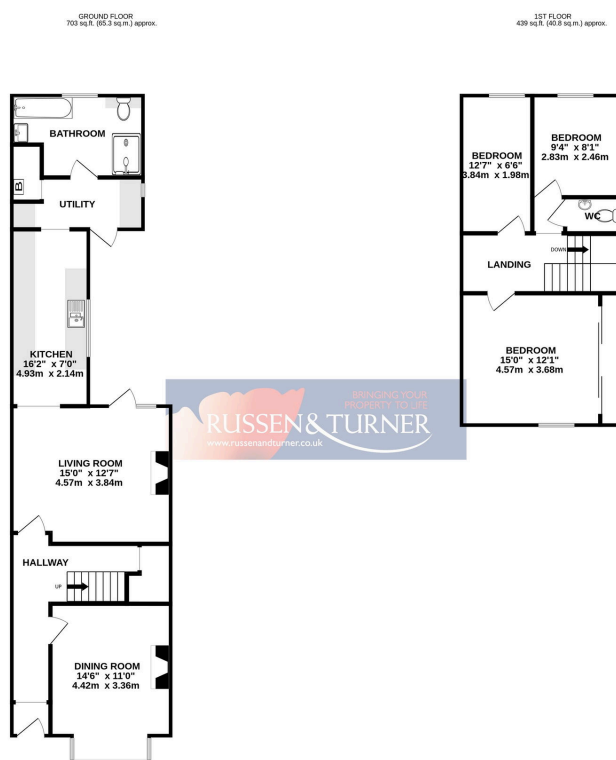

TOTAL FLOOR AREA: 1142 sq.ft. (106.1 sq.m.) approx.
Whilst every attempt has been made to ensure the accuracy of the description contained herein, measurements of doors, windows, rooms and any other items are approximate and no responsibility is taken for any error, omission or mis-statement. This plan is for illustrative purposes only and should be used as such by any prospective purchaser. The services, systems and appliances shown have not been tested and no guarantee as to their operability or efficiency can be given.
Made with Metropix (2023)