



**Connells**

Rainbow View Parkers Way  
Totnes



### Property Description

**\*\*4 REMAINING APARTMENTS AVAILABLE\*\***

**\*\*FINISHED AND READY TO MOVE INTO\*\***

An impressive duplex apartment with incredible views over Totnes town, private balcony, 850 sq.ft. of accommodation, parking and communal gardens..

Rainbow View is an impressive development of duplex apartments that are finished with clean lines and an elevated position, giving expansive views over Totnes, all the homes have terraces or balconies, lower floor W.C., communal garden and residents parking.

This particular apartment comprises to the lower floor - private hallway with cloakroom/W.C., open plan Living Room/Kitchen. To the upper floor are 2 double bedrooms, bathroom and balcony.

### Agents Note

Please note that images used may be computer generated and/or from a show-home by the developer and are meant for guidance only. Images are general of the development and may not relate to your chosen Plot - clarification should be sought from our sales team.







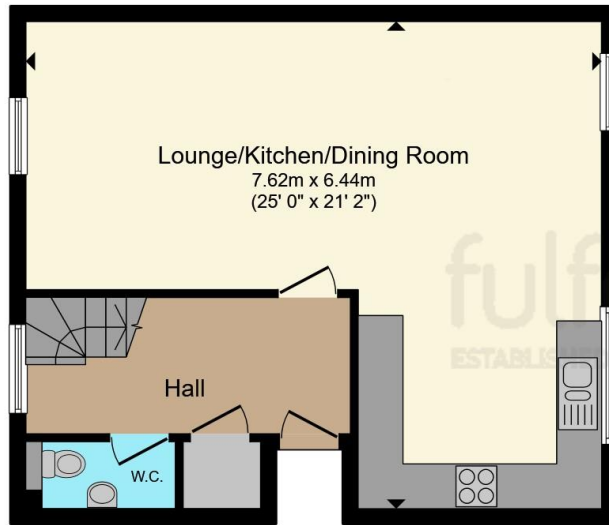

**Lower Floor**

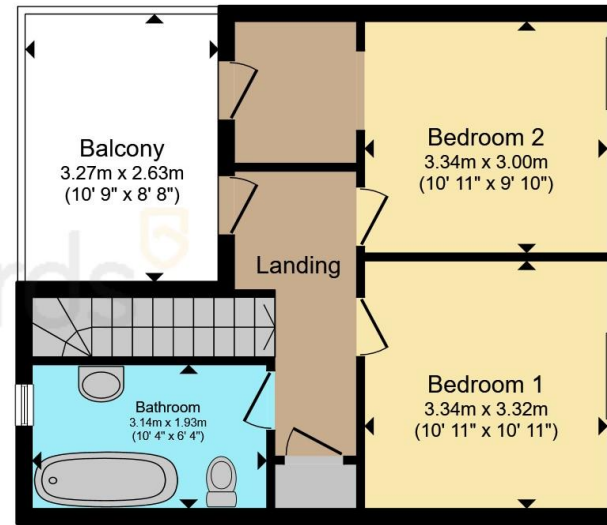

**Upper Floor**

Total floor area 89.1 m<sup>2</sup> (959 sq.ft.) approx

This floor plan is for illustrative purposes only. It is not drawn to scale. Any measurements, floor areas (including any total floor area), openings and orientation are approximate. No details are guaranteed, they cannot be relied upon for any purpose and they do not form part of any agreement. No liability is taken for any error, omission or misstatement. A party must rely upon its own inspection(s). Powered by [www.focalagent.com](http://www.focalagent.com)

To view this property please contact Connells on

**T 01803 400 888**  
**E [paignton@connells.co.uk](mailto:paignton@connells.co.uk)**

51 Hyde Road  
 PAIGNTON TQ4 5BP

EPC Rating:  
 Exempt

Service Charge: Ask  
 Agent

Ground Rent:  
 Ask Agent

Tenure: Leasehold

**view this property online [connells.co.uk/Property/PGN313648](http://connells.co.uk/Property/PGN313648)**

This is a Leasehold property. We are awaiting further details about the Term of the lease. For further information please contact the branch. Please note additional fees could be incurred for items such as Leasehold packs.



1. MONEY LAUNDERING REGULATIONS Intending purchasers will be asked to produce identification documentation at a later stage and we would ask for your co-operation in order that there will be no delay in agreeing the sale. 2. These particulars do not constitute part or all of an offer or contract. 3. The measurements indicated are supplied for guidance only and as such must be considered incorrect. Potential buyers are advised to recheck measurements before committing to any expense. 4. We have not tested any apparatus, equipment, fixtures, fittings or services and it is in the buyers interest to check the working condition of any appliances.

Connells Residential is registered in England and Wales under company number 1489613, Registered Office is Cumbria House, 16-20 Hockliffe Street, Leighton Buzzard, Bedfordshire, LU7 1GN. VAT Registration Number is 500 2481 05.

**See all our properties at [www.connells.co.uk](http://www.connells.co.uk) | [www.rightmove.co.uk](http://www.rightmove.co.uk) | [www.zoopla.co.uk](http://www.zoopla.co.uk)**

Property Ref: PGN313648 - 0002