



Foxglove Drive, Forge Wood, Crawley, RH10 3GW

Welcome to this splendid modern ground floor apartment located on Foxglove Drive in Forge Wood, Crawley. This delightful property boasts two generously sized double bedrooms, making it an ideal choice for first-time buyers or those seeking a comfortable living space. The master bedroom features an en suite shower room, providing added convenience and privacy.

The apartment is designed with practicality in mind, offering ample storage cupboards throughout, ensuring that you have plenty of space to keep your belongings organised. The well-appointed kitchen is open plan to the living room and is perfect for relaxation and entertaining guests, creating a warm and inviting atmosphere.

One of the standout features of this property is the allocated parking space for one vehicle, a valuable asset in today's busy world. Additionally, the absence of an onward chain means that you can move in without delay, making this an even more attractive option.

Situated in a great location, this apartment is close to local amenities and transport links, enhancing your daily living experience. Whether you are looking to invest or make your first home, this property presents an excellent opportunity. Do not miss the chance to view this charming apartment that combines modern living with practicality.

Offers In Excess Of £260,000 Leasehold

Foxglove Drive, Forge Wood, Crawley, RH10 3GW



- No Onward Chain
- 2 Double Bedrooms
- Ground Floor Apartment
- Fitted Kitchen open to Living Room
- Allocated Parking Space
- Great Location

Entrance Hall

Living Room / Kitchen

19'0" x 15'4" (5.81 x 4.68)

Bedroom 1

18'10" x 9'0" (5.75 x 2.76)

En Suite Shower Room

Bedroom 2

10'10" x 9'10" (3.31 x 3.02)

Bathroom

Outside

Allocated Parking Space

Council Tax Band: C

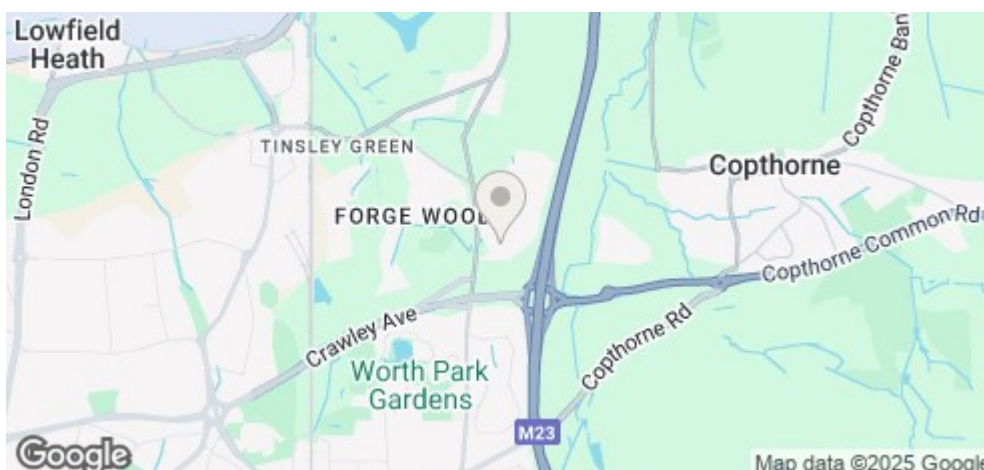



Floor Plan

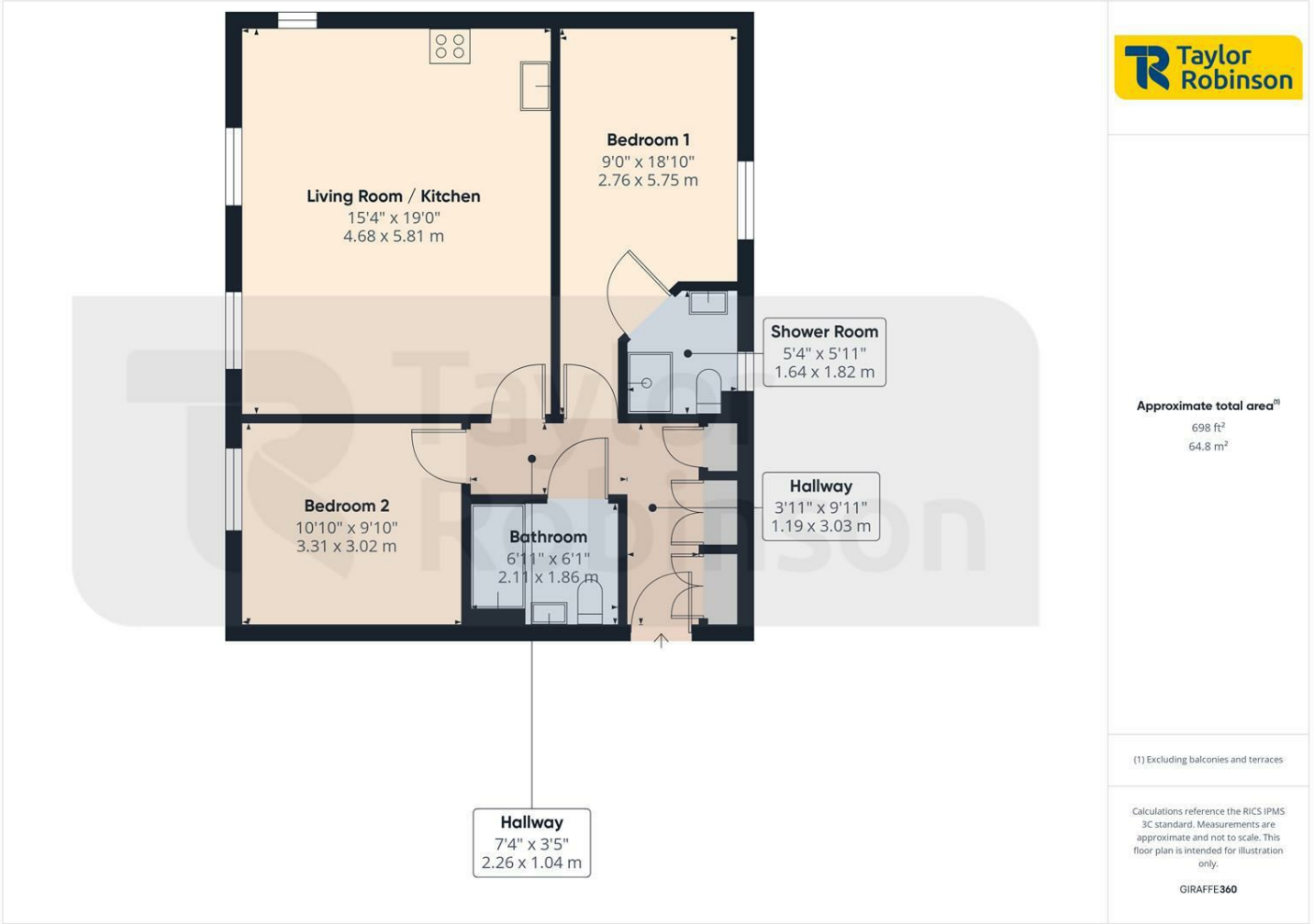

These particulars, whilst believed to be accurate are set out as a general outline only for guidance and do not constitute any part of an offer or contract. Intending purchasers should not rely on them as statements of representation of fact, but must satisfy themselves by inspection or otherwise as to their accuracy. No person in this firms employment has the authority to make or give any representation or warranty in respect of the property.

Branch Address: 2 Brittingham House Orchard Street, Crawley,
West Sussex, RH11 7AE
Tel: 01293 552388
Email: sales@taylor-robinson.co.uk
www.taylor-robinson.co.uk

