

ALLDAY  
& MILLER



Gainsborough Road, Hayes, UB4 8QG  
£200,000

 1  1  1  c



Gainsborough Road, Hayes, UB4 8QG

**£200,000**

- One Bedroom Apartment
- Long Lease
- Good Condition Throughout
- Easily Accessible To A Metropolitan + Piccadilly Line Station
- Ground Floor
- Chain Free Sale
- Allocated Parking
- Nestled Among Picturesque Green Fields

## Description

This attractive ground floor apartment offers comfortable and well-maintained living, ideal for first-time buyers or downsizers.

The property comprises a bright and spacious reception room, a well-appointed kitchen, a generous double bedroom, and a modern bathroom. Presented in good condition throughout.

Externally, the development benefits from access to a communal garden, providing a pleasant outdoor space to relax. The property also includes the added advantage of allocated parking.

## Situation

Gainsborough Road is situated on a peaceful Cul-De-Sac within easy reach to the Uxbridge road with its vast array of local shops, favoured restaurants, takeaways and cafes. Also a short distance to Hayes & Harlington Train Station for the popular Elizabeth Line. Uxbridge Town Centre is a short drive away with its extensive shopping centres, popular restaurants/bars and the Metropolitan/Piccadilly Line Station which provides a swift and regular connection to Central London. The area is served by a number of highly regarded schools including Hayes Park primary school, Grange Park and Barnhill Community high school.



## Floor Plans

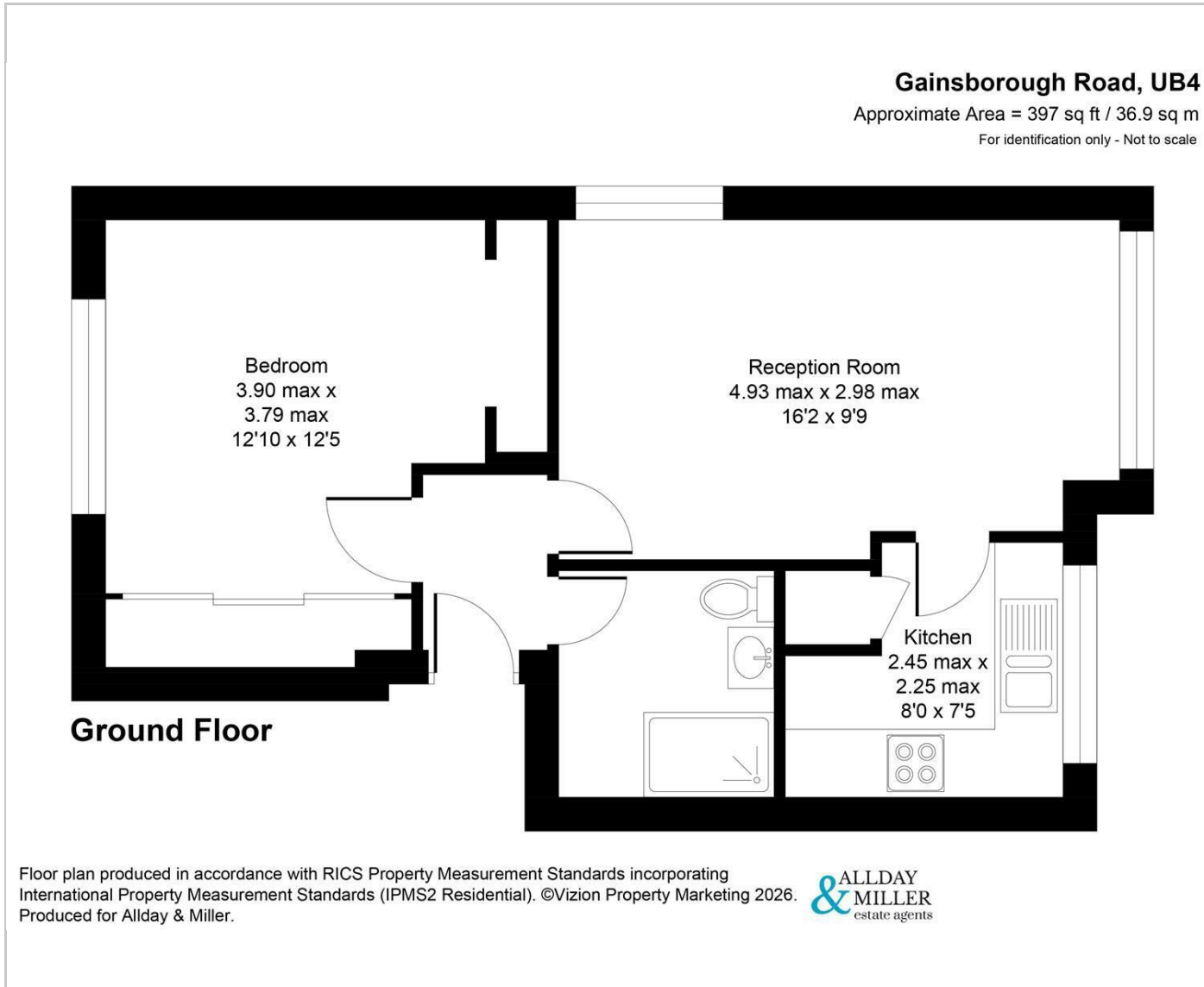

## Area Map

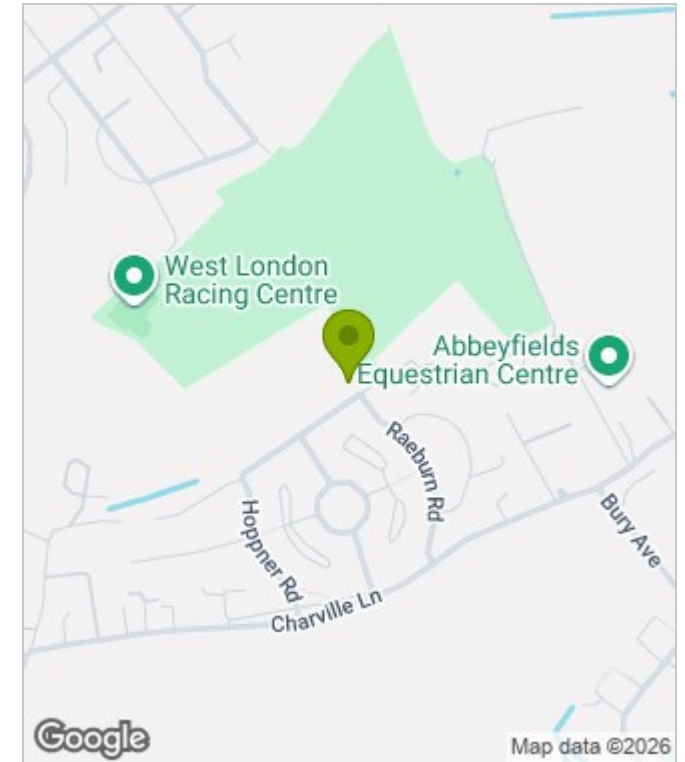

## Energy Performance Graph

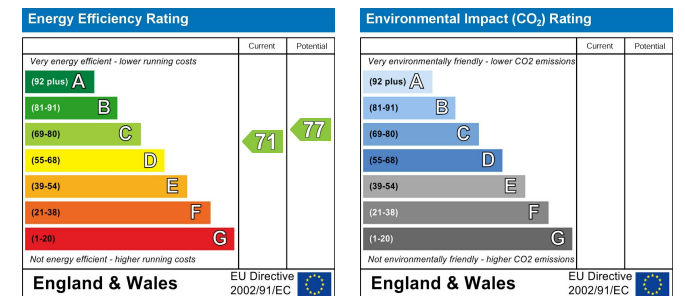

These particulars, whilst believed to be accurate are set out as a general outline only for guidance and do not constitute any part of an offer or contract. Intending purchasers should not rely on them as statements of representation of fact, but must satisfy themselves by inspection or otherwise as to their accuracy. No person in this firm's employment has the authority to make or give any representation or warranty in respect of the property.