



Flat 1, 60, Abbey Foregate, Shrewsbury, Shropshire, SY2 6BQ

Offers in the Region Of £160,000

This impressive 1 bedroom apartment is located on the ground floor of a handsome Grade II listed building which dates back to c1850. Located within a short walk of the town centre and offering the rare feature of parking, the property also offers: Hall, Spacious Living Room with impressive bay window, Breakfast Room, Kitchen, Bedroom, Bathroom. GCH, Communal gardens to rear. No Upward Chain.



Flat 1, 60, Abbey Foregate, Shrewsbury, Shropshire, SY2 6BQ

The mention of any appliances and/or services within these sales particulars does not imply that they are in full and efficient working order.

Accommodation comprises

Period entrance door with glazed half moon fan light above.

Communal Hall

Entrance Hall

Exposed floor boards.

Living Room

A magnificent room with deep walk in bay window and period panelling, exposed floor boards, wooden fire surround with tiled inlay and hearth, book shelving to one alcove, picture rail, cornice, ceiling rose and radiator.

Breakfast Room

Exposed floor boards, radiator, breakfast bar and window to the rear, door to useful understairs storage cupboard.

Kitchen

Archway leads from the Breakfast Room. Fitted with range of units with wood effect laminated work tops, inset sink unit, wall mounted gas central heating boiler, radiator, 3 windows providing excellent natural lighting, stable door to the rear.

Bedroom

Radiator, range of fitted wardrobes, exposed floor boards, picture rail and cornice, wash basin with tiled splash and cupboard beneath.

En-suite Bathroom

Fitted with white 2 piece suite including bath with wall mounted shower unit over, WC, extensive tiling, radiator, double glazed rear window, Expelair extractor.

Outside

The property has the rare benefit of parking, which is accessed over a private driveway. There is a communal garden areas.

Agents' Note

The property is held on a 999-year lease. Along with the other flats, it is part of a limited company which bought the freehold. When the flat sells, the new owner will become a director of the limited company.

Council Tax Band A

Tenure: Our client advises us that the property is Leasehold with a share of the Freehold. Should you proceed with the purchase of the property, these details must be verified by your solicitor.

Viewing: To arrange a viewing call in at our office or telephone **01743 248351**

Approx Gross Internal Area
49 sq m / 527 sq ft

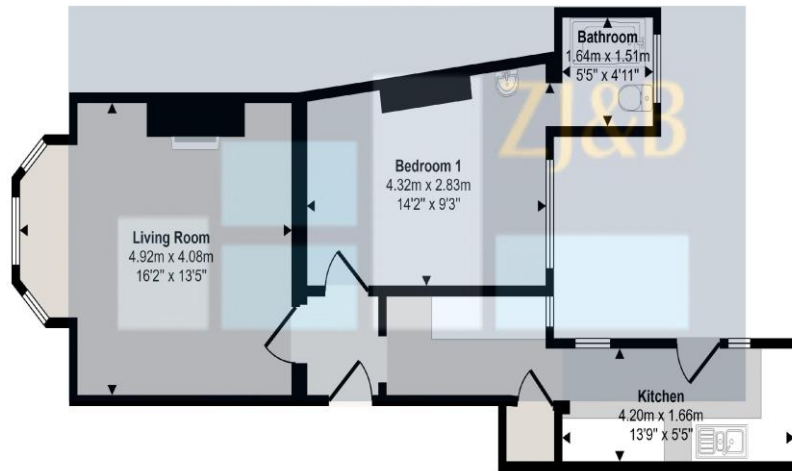

Floorplan

This floorplan is only for illustrative purposes and is not to scale. Measurements of rooms, doors, windows, and any items are approximate and no responsibility is taken for any error, omission or mis-statement. Icons of items such as bathroom suites are representations only and may not look like the real items. Made with Made Snappy 360.

FLOOR PLANS FOR GUIDANCE ONLY

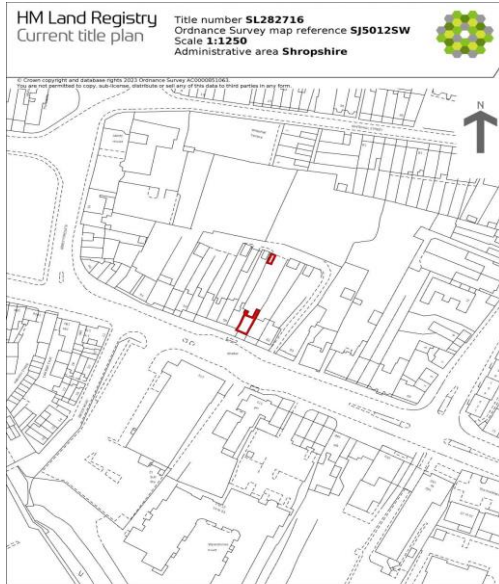

This is a copy of the title plan on 8 APR 2026 at 11:34:45. This copy does not take account of any application made after that time even if still pending in HM Land Registry when this copy was issued.

This copy is not an "Official Copy" of the title plan. An official copy of the title plan is admissible in evidence in a court to the same extent as the original. A person is entitled to be indemnified by the registrar if he or she suffers loss by reason of a mistake in an official copy. If you want to obtain an official copy, the HM Land Registry web site explains how to do this.

HM Land Registry endeavours to maintain high quality and scale accuracy of title plan images. The quality and accuracy of any print will depend on your printer, your computer and its print settings. This title plan shows the general position, not the exact line, of the boundaries. It may be subject to distortions in scale. Measurements scaled from this plan may not match measurements between the same points on the ground.

This title is dealt with by HM Land Registry, Telford Office.



FREE MORTGAGE ADVICE

Whether you are a first time buyer, moving home, buying as an investor or looking to save on your mortgage payments, you will benefit from some **free** no obligation mortgage advice. To arrange an appointment with Stephen Bath of Bee Mortgages, who is based at our office, call us on **01743 248351**

Whole of Market, clear and relevant tailored to your individual needs and circumstances.

Your home may be repossessed if you do not keep up repayments on your mortgage