



****Guide Price - £500,000 - £525,000****

Nestled along the charming Wantz Road, this delightful two-bedroom period terrace cottage at Wantfield Cottages offers a perfect blend of character, comfort, and practicality. Beautifully presented throughout, the property has been thoughtfully maintained to create a warm and inviting home ideal for first-time buyers, downsizers, or those seeking a peaceful village setting within easy reach of amenities.

The ground floor welcomes you with a spacious living room, filled with natural light and offering ample space for both relaxation and entertaining. To the rear, a well-appointed kitchen flows seamlessly into a dedicated dining area, creating a sociable hub for everyday living. The layout is both functional and charming, retaining a sense of the home's period origins while catering to modern lifestyles.

Upstairs, the first floor comprises two well-proportioned bedrooms, each offering comfortable accommodation and versatility for a home office or guest room. A neatly presented bathroom completes the upper level.

Externally, the property continues to impress. The south-west facing rear garden is a standout feature - perfectly positioned to enjoy afternoon and evening sun, making it an ideal space for outdoor dining, gardening, or simply unwinding. To the rear, the added benefit of off-street parking and a private garage provides both convenience and valuable storage - an increasingly sought-after feature in this location.

Situated in the desirable village of Margaretting, the cottage enjoys a semi-rural feel while remaining well connected. Local amenities, countryside walks, and transport links are all within easy reach, offering the best of both worlds.

Combining period charm with modern comfort and practical features, this attractive cottage presents a wonderful opportunity to secure a well-rounded home in a highly regarded setting.





Nestled along the charming Wantz Road, this delightful two-bedroom period terrace cottage offers a perfect blend of character, comfort, and practicality. Beautifully presented throughout ...

Council Tax band: D

Tenure: Freehold

EPC Energy Efficiency Rating: E

EPC Environmental Impact Rating: E

- Lovingly Restored & Improved Throughout
- Two Bedroom Period Cottage
- Garage & Parking to Rear
- Open-Plan Living
- Modern Bathroom
- Spacious Rear Garden







Ground Floor

Approx. 41.9 sq. metres (451.3 sq. feet)

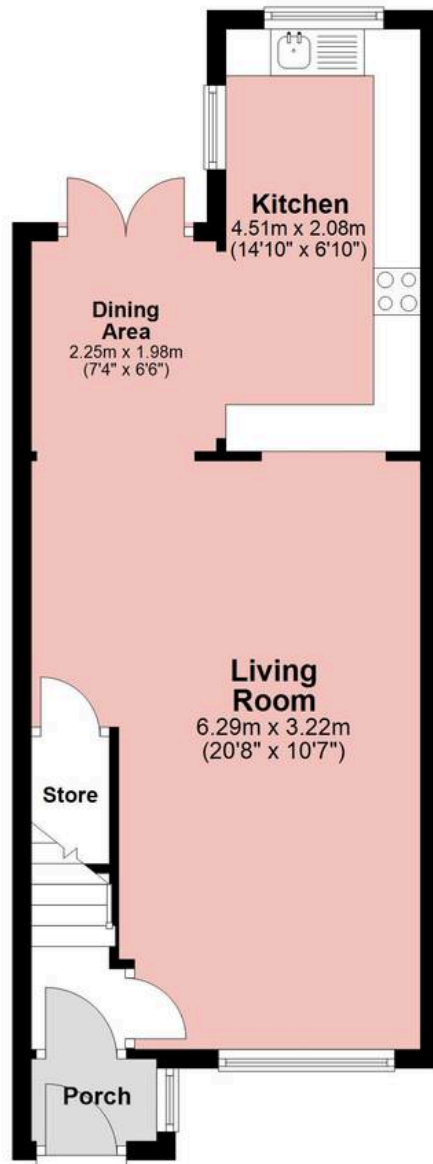

First Floor

Approx. 24.4 sq. metres (263.2 sq. feet)

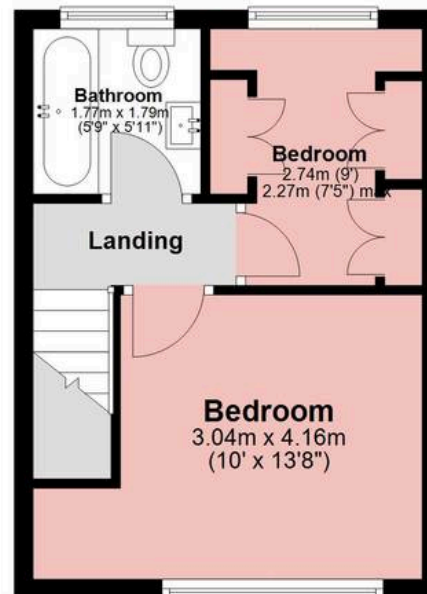

Outbuilding

Approx. 17.0 sq. metres (182.8 sq. feet)

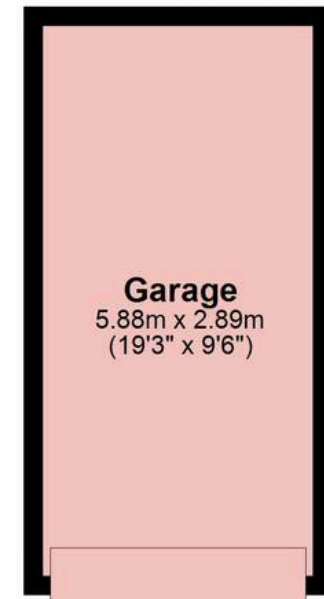

Total area: approx. 83.4 sq. metres (897.3 sq. feet)

All measurements have been taken as a guide to prospective buyers only and are not precise. This plan is for illustrative purposes only and no responsibility for any error, omission or misstatement. The services, systems and appliances shown have not been tested and no guarantee as to their operability or efficiency can be given.

Measurements may have been taken from the widest area and may include wardrobe/cupboard space. No guarantee is given to any measurements including total areas. Buyers are advised to take their own measurements.

Plan produced using PlanUp.

Wantz Road

About Us

From charming cottages to country estates, all our homes have a story to tell... 'Period Homes' is one of a kind, an agency dedicated to the sale of character and period properties across Essex.

If you would like to buy a period home but you have a modern home to sell first, we can assist via our sister company, Walkers, which just so happens to have been voted Britain's Best Estate Agency in the British Property Awards. That way, both elements of your move are in the very best of hands.

Get In Touch



Browse Properties



PERIOD HOMES



Psst... Have you heard of discreet marketing?

Many people lose out on their dream home to someone in a better position.

Often, it is because they have delayed putting their house on the market, preferring to find somewhere first and then sell.

That is why we have innovated a totally unique and highly confidential moving home solution to put you in a competitive position.

Let us find you a buyer without any advertising or pressure and without the neighbours knowing.

Your secret is safe with us...

Get in touch for a complimentary valuation.

Looking To Sell Or Let Your Home?

Book your free valuation to see how much your home is worth.

Contact Us

01277 288000



Our Website

periodhomes.co.uk



Our Address

Eaton House

High Street

Ingestone

CM4 9DW

