

EST  
1900

125

— YEARS OF —

Lambert  
& Foster



Lambert  
& Foster



## 14 BROOKS CLOSE

STAPLEHURST | KENT | TN12 0PP

*A well presented semi-detached house, providing three bedroom accommodation including a sitting room with wood burning stove, a separate playroom/study and conservatory complemented by a front and rear garden, with a block paved driveway, all occupying a central village location, a level walk of the mainline station and high street amenities. Cranbrook School Catchment area.*

Guide Price £365,000

FREEHOLD





## 14 BROOKS CLOSE

STAPLEHURST, KENT, TN12 0PP

14 Brooks Close is linked, semi-detached house, presenting brick elevations set with UPVC double glazed windows, beneath a pitched interlocking tiled roof. The well presented accommodation is arranged over two floors. From the entrance hall, door to the sitting room with feature fireplace housing a wood burning stove on a raised hearth, fitted cupboards and shelving to recesses and an aspect front. The kitchen /dining room is comprehensively fitted with a range of units and island, worksurfaces and inset Belling four burner electric hob, Bosch electric oven with filter hood over, space and plumbing for washing machine and dishwasher, recessed ceiling down lamps and a useful walk in understairs cupboard providing storage, space and electric point for a chest freezer, aspect to rear overlooking the rear garden. Sliding patio doors provide access to the UPVC double glazed conservatory, fitted with lighting, sliding patio door provides access out to the garden. From the conservatory access to the play room/study with heating, power and light.

Arranged over the first floor are three bedrooms, bedroom one with fitted wardrobe and an aspect front. Pull down attic steps to a boarded and carpeted roof space with x 2 Velux roof line windows The bathroom has recently been updated, fitted with a modern white suite including integrated wc, wash hand basin, panelled bath with mixer tap and shower attachment, integrated shower over, part tiled surround.

Outside, a block paved driveway provides parking for approximately three cars. The front garden is laid to lawn. The rear garden complements the accommodation, laid to lawn with paved patio and retaining, dwarf brick wall. A stepping stone pathway leads to a timber garden shed. The whole is enclosed by wooden panel fencing.



- **Linked semi detached family house**
- **Sitting room with wood burning stove**
- **Comprehensively fitted kitchen/dining room with island**
- **Study/playroom**
- **Conservatory**

- **Three bedrooms**
- **Bathroom with newly fitted white suite**
- **Block paved drive, front and rear lawned gardens**
- **Central village location level walk of Staplehurst MLS and amenities**
- **Cranbrook School catchment area.**

**VIEWING:** By appointment only.  
**Cranbrook Office:** 01580 712888.

**WHAT3WORDS:** intend.confident.coffee

**TENURE:** Freehold

**SERVICES & UTILITIES:**

**Electricity supply:** Mains

**Water supply:** Mains

**Sewerage:** Mains

**Heating:** Mains Gas fired central heating

**LOCAL AUTHORITY:** [www.maidstone.gov.uk](http://www.maidstone.gov.uk)

**COUNCIL TAX:** Band D **EPC:** C (69)

**BROADBAND & MOBILE COVERAGE:**

(Visit <https://checker.ofcom.org.uk/en-gb/broadband-coverage> or enquire with the office for more information).

For identification purposes only. The position and size of doors, windows, appliances and other features are approximate only.

## 14 Brooks Close, Staplehurst, Tonbridge, TN12 0PP

Approximate Area = 1186 sq ft / 110.1 sq m

For identification only - Not to scale

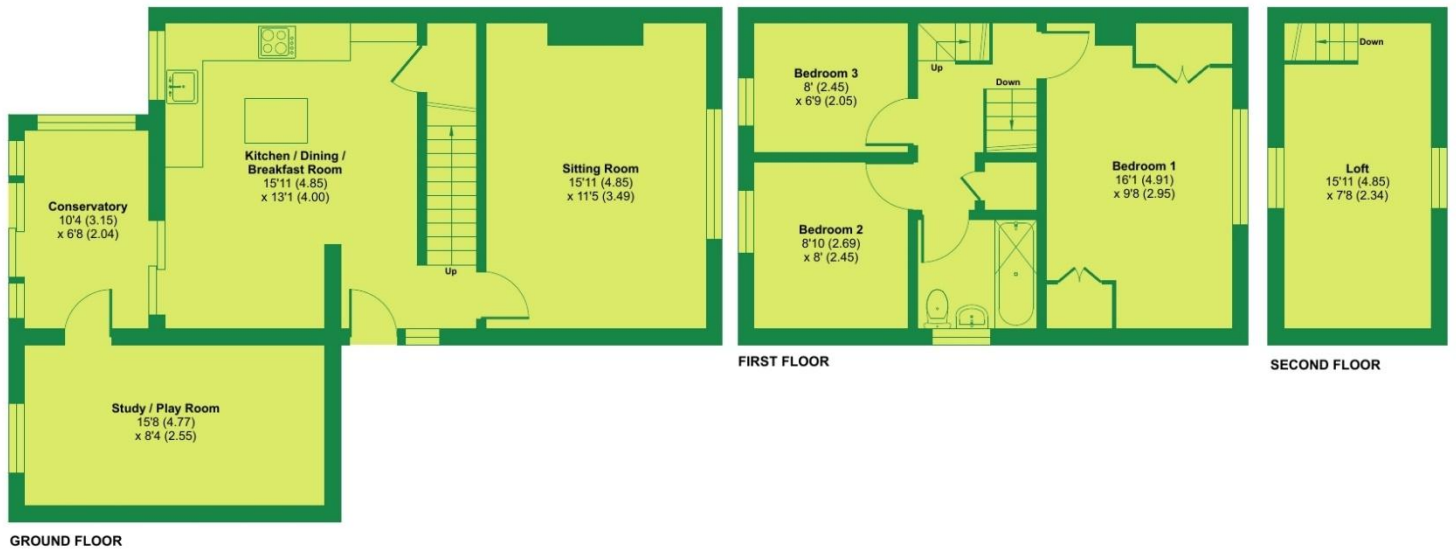

Floor plan produced in accordance with RICS Property Measurement 2nd Edition, Incorporating International Property Measurement Standards (IPMS2 Residential). © ncthemcom 2025. Produced for Lambert and Foster Ltd. REF: 1355347

**PARTICULARS, PLANS AND SCHEDULES:** The particulars and acreages stated, together with the plans are believed but not guaranteed to be correct. They are given by the Agents to assist viewers but are specifically excluded from any contract. Prospective purchasers must satisfy themselves as to the information enclosed.

**IMPORTANT NOTICE:** Lambert & Foster themselves and the vendors and/or lessors of this property whose agents they are, give notice that: The particulars are set out as a general outline only for guidance and do not constitute part of an offer or contract. All descriptions, dimensions, references to condition and necessary permissions for the use and occupation and other details are given in good faith and are believed to be correct. Any intending purchasers/lessees should not rely on them as statements or presentations of fact but satisfy themselves by inspection or otherwise as to the correctness of each of them. If there are any points which are of particular importance to you, please contact the office and we will be pleased to check the information, particularly if you are travelling some distance to view the property.

In accordance with the Digital Market, Competition and Consumers (DMCC) Act 2024, we must advise that we have not tested any of the main services, various electrical or gas appliances and fixtures which may be referred to in these sales particulars. Any prospective purchasers are strongly advised to satisfy themselves that such are in working order. No person in the employment of the Agents has any authority to make or give any representations or warranty whatever in relation to this property.

**MONEY LAUNDERING REGULATION:** In accordance with Money Laundering Regulations, we are now required to obtain proof of identification for all vendors and purchasers. You will need to supply information required for us to complete our identification checks which will include your date of birth, main residential address and a colour copy of your passport or photo driving licence. Lambert & Foster apologise for any inconvenience this may cause, but it is a legal requirement. Lambert & Foster will not be able to conclude a sale on your behalf to any person or people who are unable to provide confirmation of identification. Note: Lambert & Foster currently employs the services of Smartsearch to verify the identity and address of vendors/purchasers.

**OFFICES LOCATED AT:**

**PADDOCK WOOD, KENT**  
 Tel. 01892 832 325  
 77 Commercial Road,  
 Paddock Wood, Kent TN12 6DS

**WADHURST, EAST SUSSEX**  
 Tel. 01435 873 999  
 Helix House, High Street  
 Wadhurst, East Sussex TN5 6AA

**HYTHE, KENT**  
 Tel. 01303 814 444  
 Hillhurst Farm, Stone St,  
 Westenhanger, Hythe CT21 4HU

**CRANBROOK, KENT**  
 Tel. 01580 712 888  
 Weald Office, 39 High Street  
 Cranbrook, Kent TN17 3DN

PROPERTY PROFESSIONALS FOR 125 YEARS

