



25 Chalky Bank Road

Rainham, ME8 7NP

Offers in excess of £425,000



A truly stunning home which has been sympathetically extended, offering deceptively spacious and high specification accommodation. The current vendors have completed a number of improvements including a large, charming and peaceful summer house retreat, a stunning shower room, rendering, a boiler (approx. 3 years old) and landscaped the rear garden, complimented by a beautiful water feature.

The stand out feature of this delightful bungalow is the large and airy fitted kitchen/diner, perfectly finished off with a contemporary island centerpiece, complete with a skylight enhancing natural light, wine chiller and breakfast bar. Additional living space includes a lounge with feature fireplace surround, two double bedrooms (the master benefitting from fitted wardrobes), and a useful and practical sized utility room.

The serene and sizable rear garden is enhanced by its privileged position backing onto a nature reserve, a genuine and rare advantage.

The attractive kerb appeal is harmoniously paired with a bloc paved driveway for parking, leading to an office/storage (formerly the garage).

The location is equally exceptional with Rainham Station and shops only a short walk away. Also very close by are local bus routes and Berengrave Nature Reserve, a perfect escape from the hustle and bustle of life to embrace the wildlife.

A fantastic property which must be viewed!



Entrance Door

Hallway

Shower Room

5'7 x 5'5 (1.70m x 1.65m)

Bedroom One

13'0 into bay x 8'8 (3.96m into bay x 2.64m)

Bedroom Two

12'3 x 7'7 (3.73m x 2.31m)

Lounge

12'5 x 11'6 (3.78m x 3.51m)

Kitchen/Diner

20'3 x 16'1 (6.17m x 4.90m)

Utility Room

8'3 x 7'4 (2.51m x 2.24m)

Landscaped Garden

approx 70' (approx 21.34m)

Summer House

17'5 x 9'9 (5.31m x 2.97m)

Formerly Garage (Office/Storage)

9'8 x 7'5 (2.95m x 2.26m)

Important Notice -

Pollard Estates, their clients and any joint agents state that these particulars are for guidance only and do not form part of any offer or contract.

No representation or warranty is given, and no employee has authority to do so.

Measurements, photographs and plans are approximate and for illustrative purposes only.

It should not be assumed that the property has all necessary planning, building regulation or other consents.

Services, appliances and systems have not been tested. Buyers must satisfy themselves by inspection or other means.

Tenure, ground rent, service charges and other leasehold details are provided by the seller and must be verified by a solicitor.

Any changes to charges or terms should be confirmed independently.

Purchasers will be required to provide identification under current Money Laundering Regulations before an offer can be accepted.

Personal data supplied during the enquiry or offer process will be handled in accordance with our privacy policy.

Disclaimer

In accordance with the Estate Agents Act 1979, we disclose that the seller of this property is associated with, or employed by, Pollard Estates.

Area Map



Floor Plans

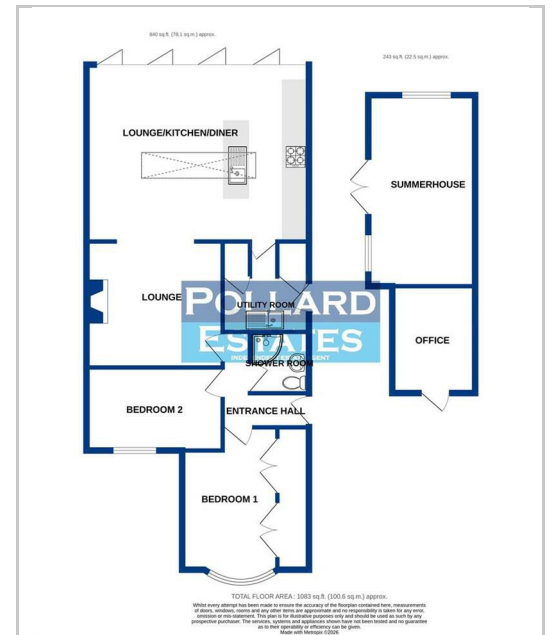

Energy Efficiency Graph

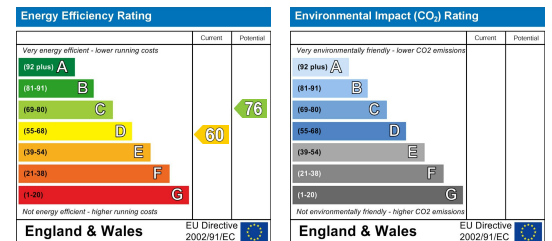

These particulars, whilst believed to be accurate are set out as a general outline only for guidance and do not constitute any part of an offer or contract. Intending purchasers should not rely on them as statements of representation of fact, but must satisfy themselves by inspection or otherwise as to their accuracy. No person in this firm's employment has the authority to make or give any representation or warranty in respect of the property.