



## Sandmere Road, SW4

£3,400 Per week

A spacious, split-level, ground floor and lower ground floor apartment. There are three double bedrooms and two bathrooms. An ideal property for three professional sharers. There is also access to a private but small decked garden.

Sandmere Road is a residential street within a short walk of Clapham High Street and Brixton. The transport links available within walking distance include the Northern and Victoria tube lines along with numerous bus routes.

### Features

- Ground And Basement
- Neutral Throughout
- Spacious
- Wooden Floors
- Large Windows
- Two Bathrooms

# Sandmere Road, London, SW4

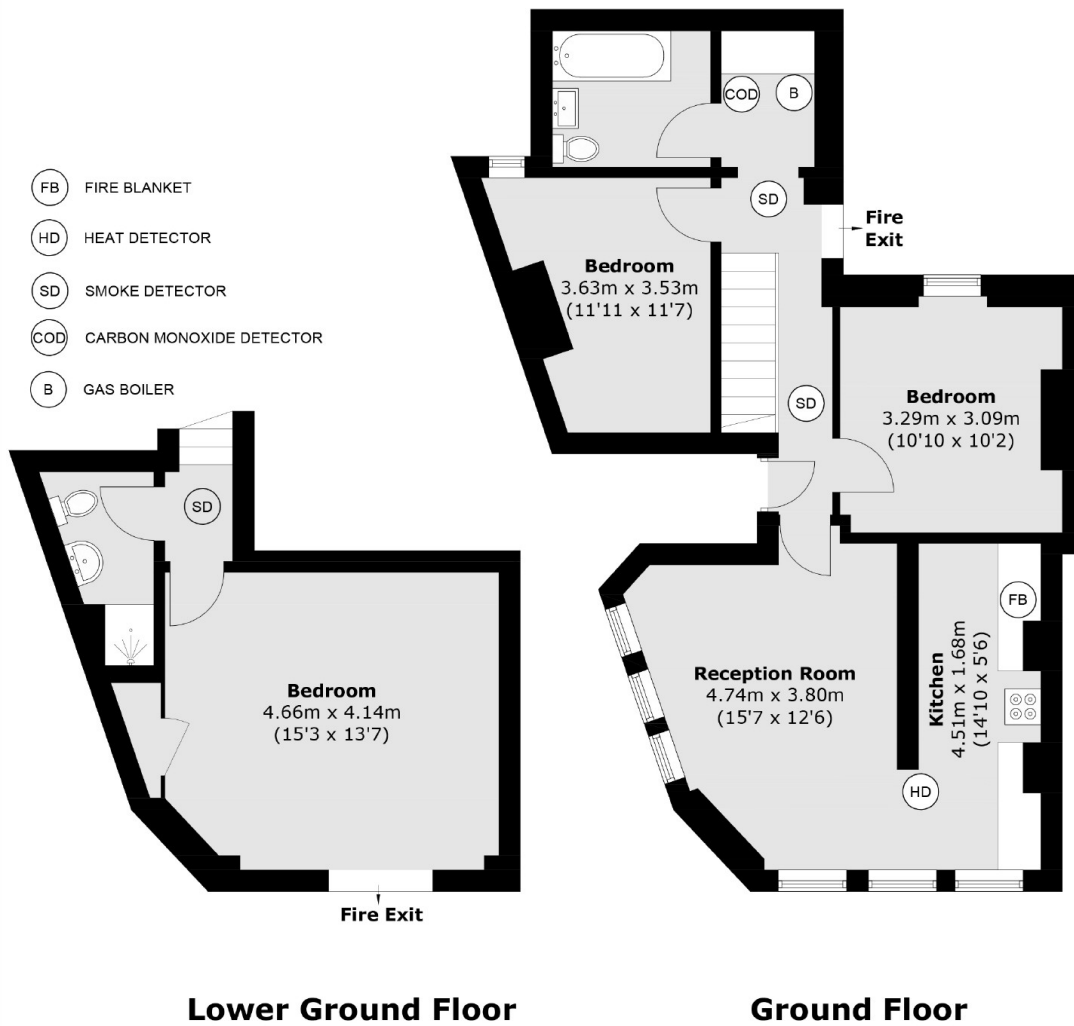

Total area (approx.): 82.2 sq. m (884.8 sq. ft)